

PROJECT REFERENCE NO. W-5313	SHEET NO. 30
RW SHEET NO.	
ROADWAY DESIGN ENGINEER PROFESSIONAL SEAL 024912 Kevin E. Moore 4/5/2017	HYDRAULICS ENGINEER PROFESSIONAL SEAL 033246 Linda M. Johns 4/7/2017
DOCUMENT NOT CONSIDERED FINAL UNLESS ALL SIGNATURES COMPLETED	

TONY D. MISENHEIMER
AND WIFE
PAMELA H. MISENHEIMER
DB 863 PG 222

188

-L-
PI Sta 360+11.80
 $\Delta = 19' 21' 33.3" (LT)$
 $D = 5' 43' 46.5"$
 $L = 337.88'$
 $T = 170.57'$
 $R = 1,000.00'$
 $SE = 06$
 $RO = 144'$

194

BROWNIE FISHER STIREWALT (WIDOW) &
STEVEN L. STIREWALT &
KAREN S. STIREWALT
DB 1212 PG 621

198

DANNY JOE KNIGHT
DB 988 PG 979

196

STEVEN LEE STIREWALT
AND WIFE
KAREN S. STIREWALT
DB 375 PG 985

-L- PT Sta. 361+79J2

365

370

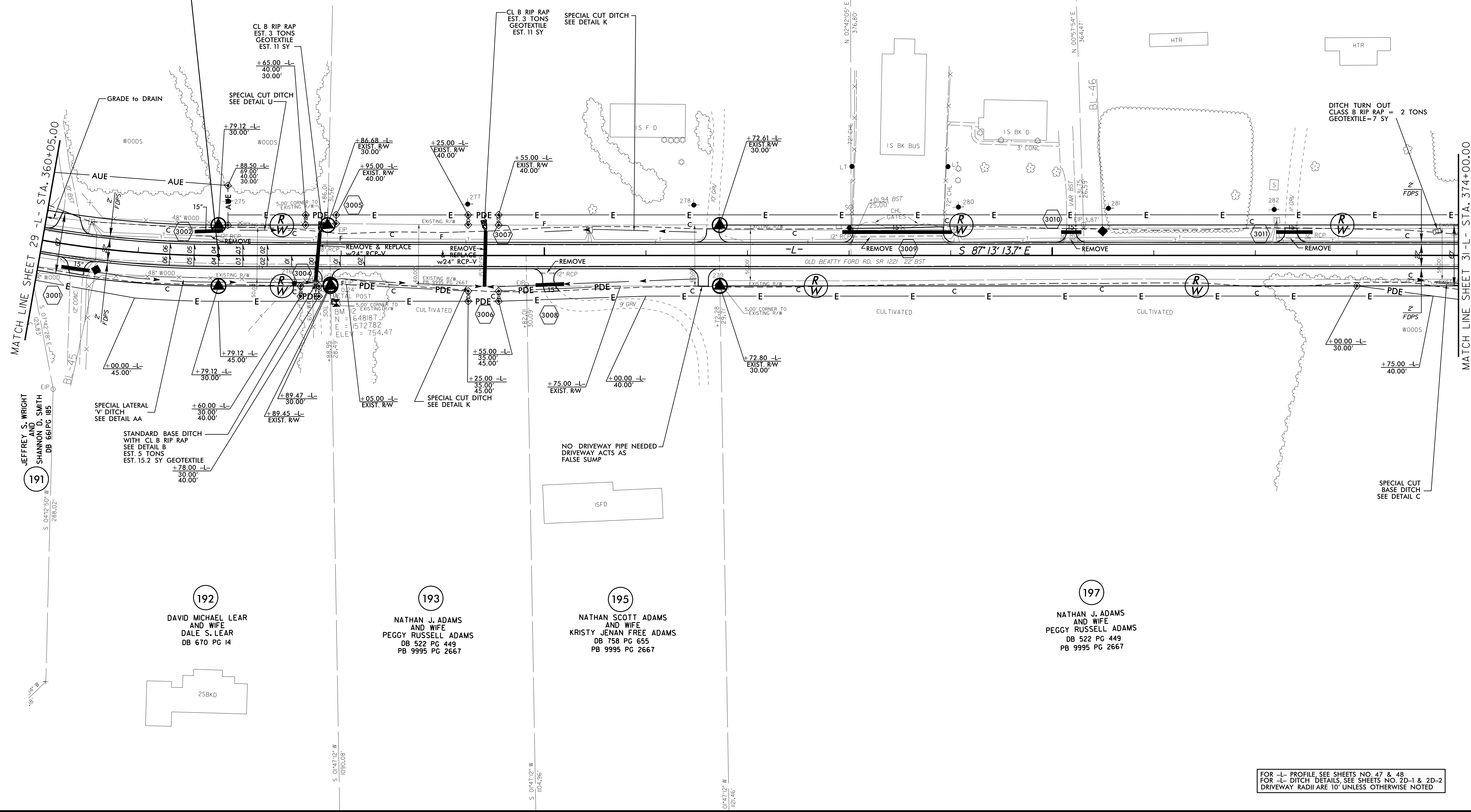

MATCH LINE SHEET 29 -L- STA. 360+05.00

MATCH LINE SHEET 31 -L- STA. 374+00.00

JEFFREY S. WRIGHT
AND
SHANNON D. SMITH
DB 661 PG 185

191

SPECIAL LATERAL
DITCH
SEE DETAIL AA

STANDARD BASE DITCH
WITH CL B RIP RAP
SEE DETAIL B
EST. 5 TONS
GEOTEXTILE

192

DAVID MICHAEL LEAR
AND WIFE
DALE S. LEAR
DB 670 PG 14

193

NATHAN J. ADAMS
AND WIFE
PEGGY RUSSELL ADAMS
DB 522 PG 449
PB 9995 PG 2667

195

NATHAN SCOTT ADAMS
AND WIFE
KRISTY JENAN FREE ADAMS
DB 758 PG 655
PB 9995 PG 2667

197

NATHAN J. ADAMS
AND WIFE
PEGGY RUSSELL ADAMS
DB 522 PG 449
PB 9995 PG 2667

NAD 83/NSRS 2007

FOR -L- PROFILE SEE SHEETS NO. 47 & 48
FOR -L- DITCH DETAILS SEE SHEETS NO. 2D-1 & 2D-2
DRIVEWAY RADII ARE 10' UNLESS OTHERWISE NOTED

8/17/99

REVISIONS

28-MAR-2017 14:27 W:\5313-Rdy_psh-sh\30.dgn
3:58:58 PM W:\5313-Rdy_psh-sh\30.dgn