

PROJECT REFERENCE NO. W-5313	SHEET NO. 26
RW SHEET NO.	
ROADWAY DESIGN ENGINEER DONALD S. WILHELM PROFESSIONAL SEAL 024912 ENGINEER Linda E. Moore 4/5/2017	HYDRAULICS ENGINEER LINDA M. JOHNS PROFESSIONAL SEAL 033246 ENGINEER Linda M. Johns 4/7/2017
DocuSigned by: DocuSigned by: DocuSigned by: DocuSigned by: DOCUMENT NOT CONSIDERED FINAL UNLESS ALL SIGNATURES COMPLETED	

8/17/99

-L-
 PI Sta 308+41.22
 $\Delta = 4' 57" 28.5" (RT)$
 $D = 0' 59" 59.7"$
 $L = 495.83'$
 $T = 248.07'$
 $R = 5,730.00'$
 SE = EXIST.
 RO = EXIST.

-L- PT Sta. 310+88.98

ALFRED RAY WILHELM
AND WIFE
MARGARET JOAN BROWN WILHELM
DB 593 PG 602

DANNY JOE KNIGHT
DB 1058 PG 435

DONALD S. WILHELM
AND WIFE
MILDRED I. WILHELM
DB 584 PG 735
DB 704 PG 454

DONALD S. WILHELM
AND WIFE
MILDRED I. WILHELM
DB 584 PG 735
DB 704 PG 454

168
CORINNA ROBERTSON &
STEVEN ROBERTSON
DB 1197 PG 272

169

MATCH LINE SHEET 25 -L- STA. 305+50.00

MATCH LINE SHEET 27 -L- STA. 319+30.00

REVISIONS

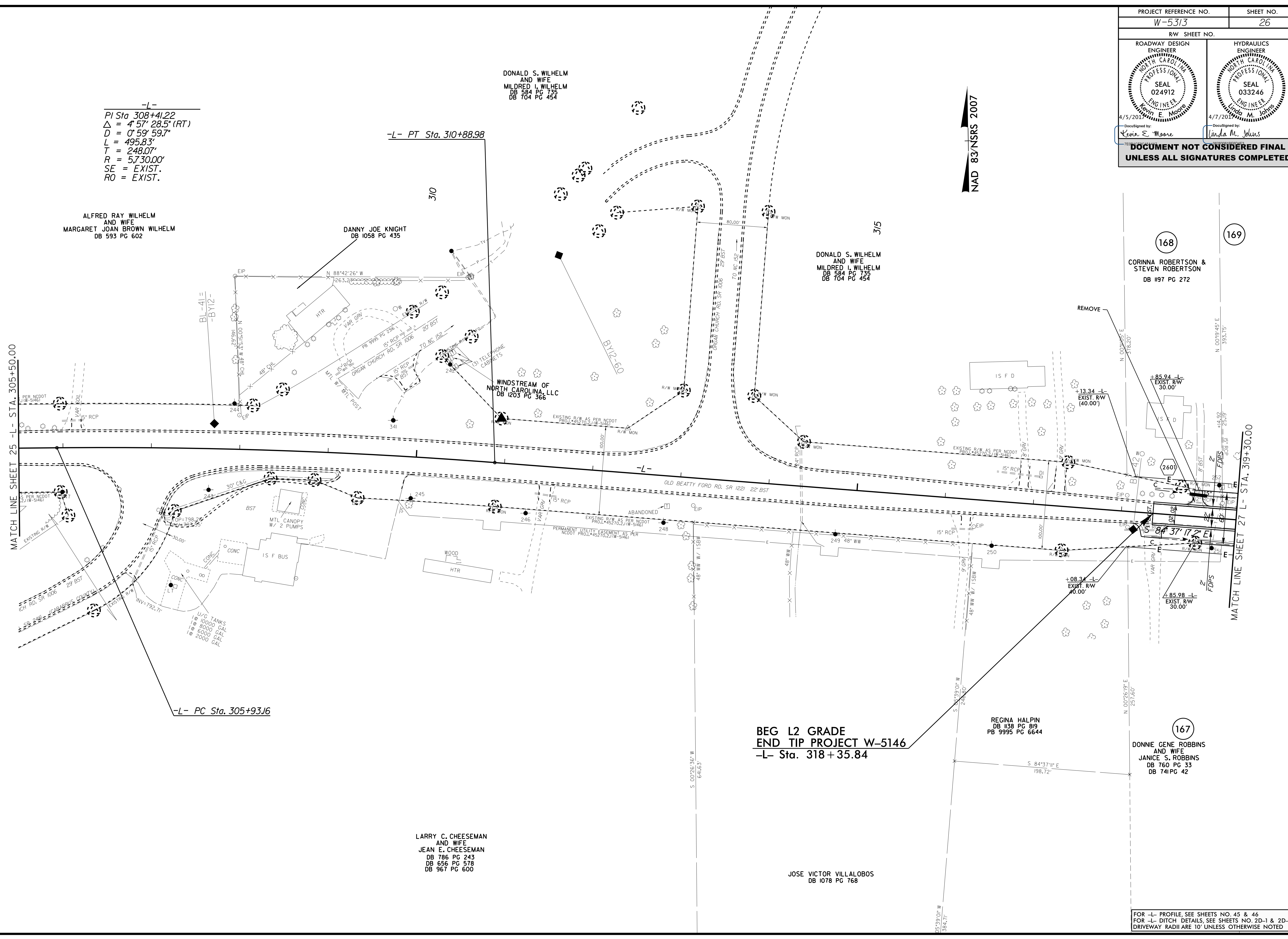

-L- PC Sta. 305+93.16

BEG L2 GRADE
END TIP PROJECT W-5146
-L- Sta. 318 + 35.84

REGINA HALPIN
DB 1138 PG 819
PB 9995 PG 6644

167
DONNIE GENE ROBBINS
AND WIFE
JANICE S. ROBBINS
DB 760 PG 33
DB 741 PG 42

LARRY C. CHEESEMAN
AND WIFE
JEAN E. CHEESEMAN
DB 786 PG 243
DB 656 PG 578
DB 967 PG 600

JOSE VICTOR VILLALOBOS
DB 1078 PG 768

28-MAR-2017 14:27 W-5313-Rdy_psh-sh+26.cdg
 9:58:05PM W-5313-Rdy_psh-sh+26.cdg

FOR -L- PROFILE, SEE SHEETS NO. 45 & 46
 FOR -L- DITCH DETAILS, SEE SHEETS NO. 2D-1 & 2D-2
 DRIVEWAY RADII ARE 10' UNLESS OTHERWISE NOTED