

-L-                      -L-  
 PI Sta 29+53.47      PI Sta 40+64.54  
 $\Delta = 2' 31" 14.3" (RT)$      $\Delta = 15' 11" 24.8" (LT)$   
 $D = 1' 54" 35.5"$          $D = 2' 32" 47.3"$   
 $L = 131.98'$                $L = 596.52'$   
 $T = 66.00'$                  $T = 300.02'$   
 $R = 3,000.00'$              $R = 2,250.00'$   
 $SE = 03$                    $SE = 06$   
 $RO = SEE PLANS$          $RO = 167'$

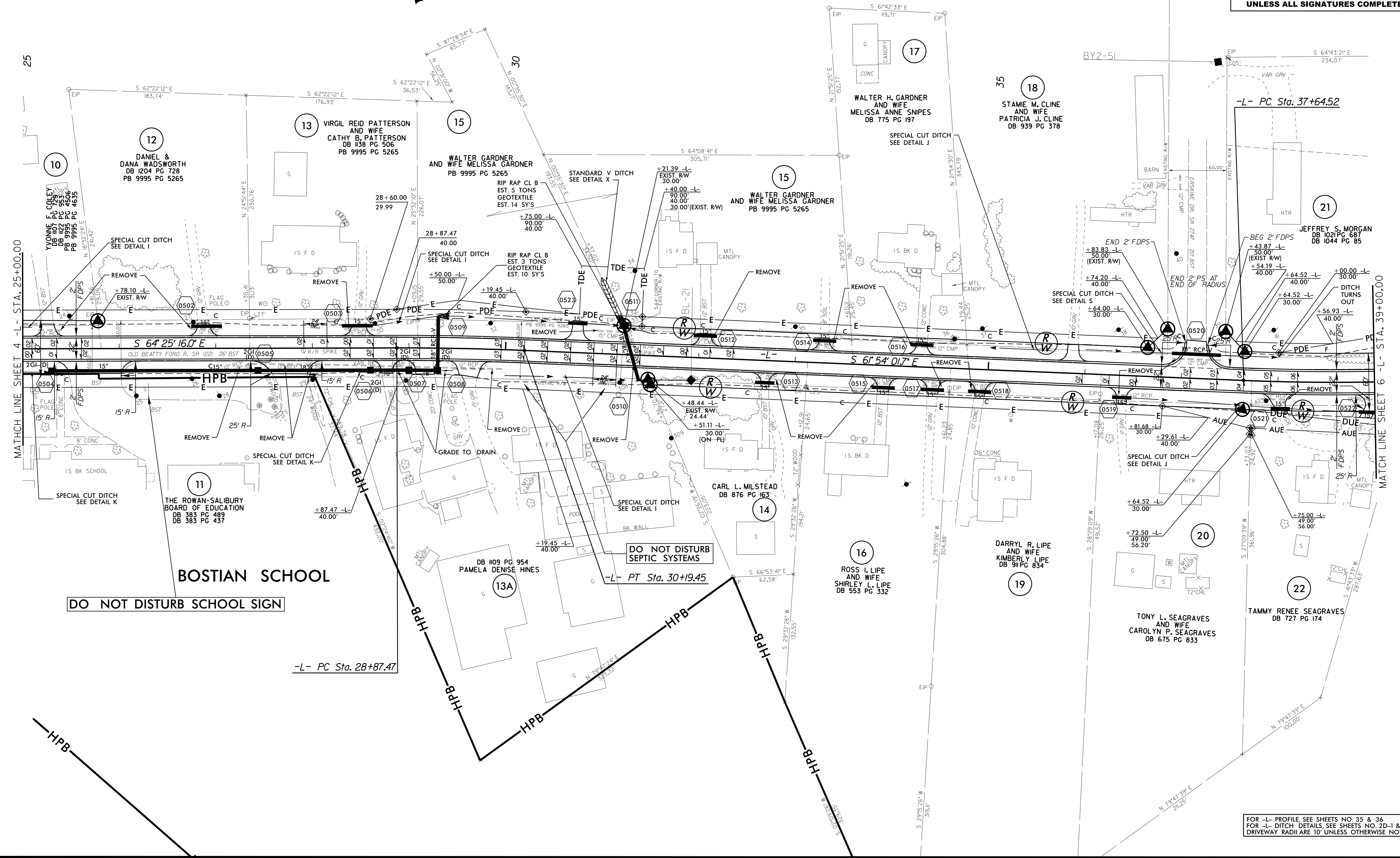

FOR -L- PROFILE SEE SHEETS NO. 35 & 36  
 FOR -L- DITCH DETAILS, SEE SHEETS NO. 2D-1 & 2D-2  
 DRIVEWAY RADII ARE 10' UNLESS OTHERWISE NOTED

8/17/99  
 28-MAR-2017 14:28 W-5313\_RedL\_psh.shx:05.dgn  
 5:58:50 SEGRAMES