

### UTILITIES BY OTHERS

**NOTE:**  
ALL UTILITY WORK SHOWN ON THIS SHEET WILL BE DONE BY OTHERS. NO PAYMENT WILL BE MADE TO THE CONTRACTOR FOR UTILITY WORK SHOWN ON THIS SHEET.

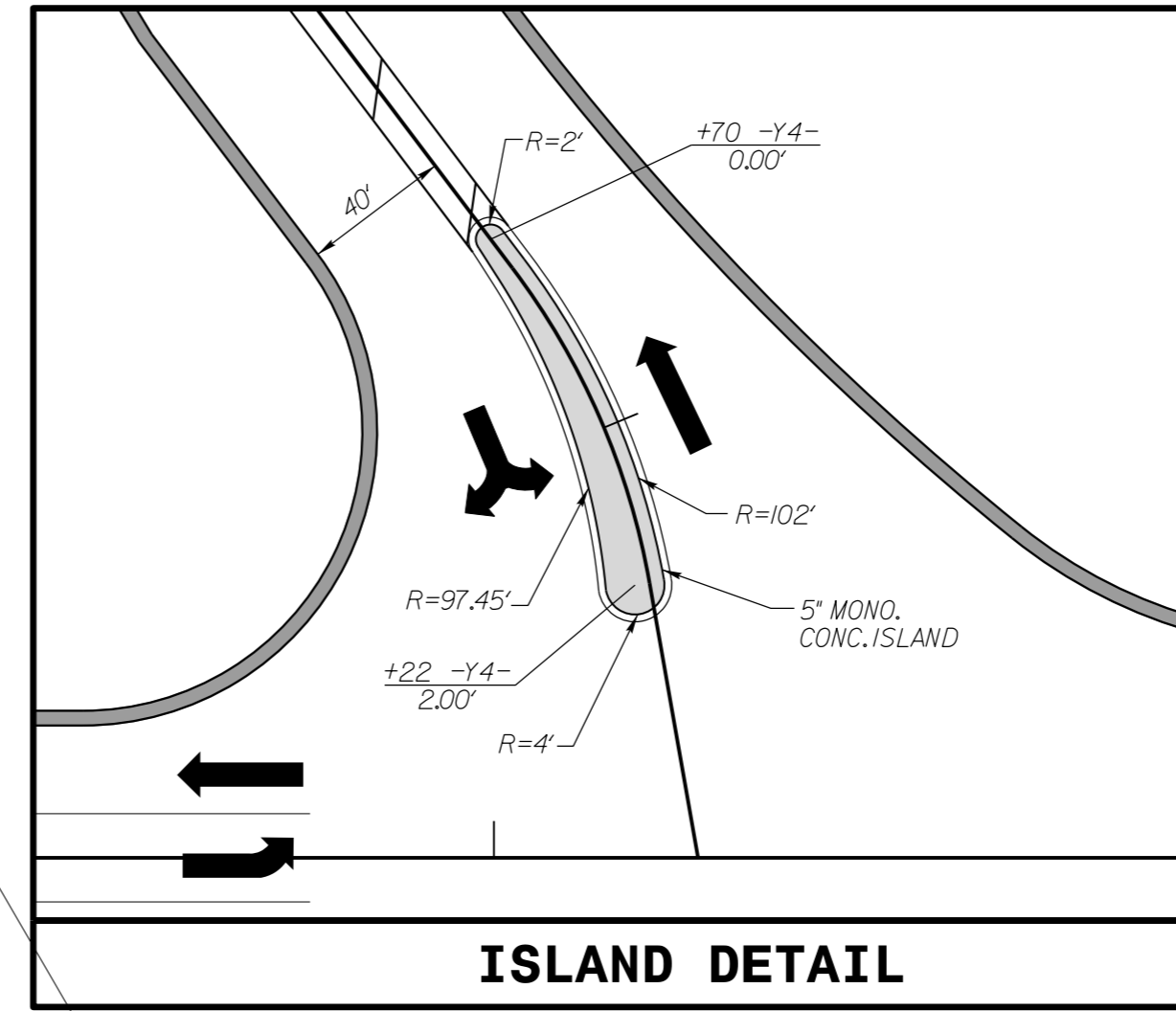

**ISLAND DETAIL**

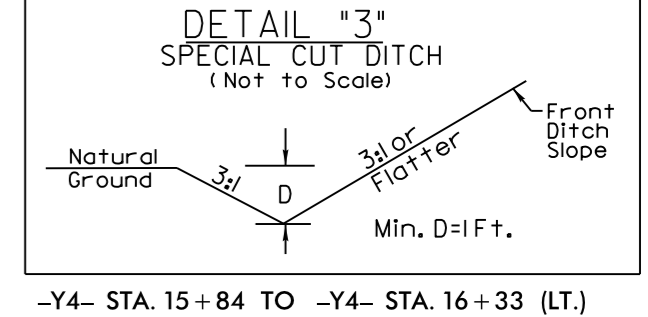
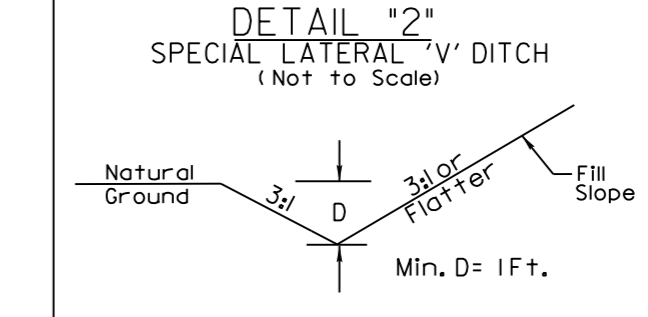

-Y3- STA. 11+30 TO -Y3- STA. 12+00 (LT.)  
-Y3- STA. 16+00 TO -Y3- STA. 16+67 (LT.)  
-Y4- STA. 15+00 TO -Y4- STA. 15+84 (RT.)

-Y4- STA. 15+84 TO -Y4- STA. 16+33 (LT.)

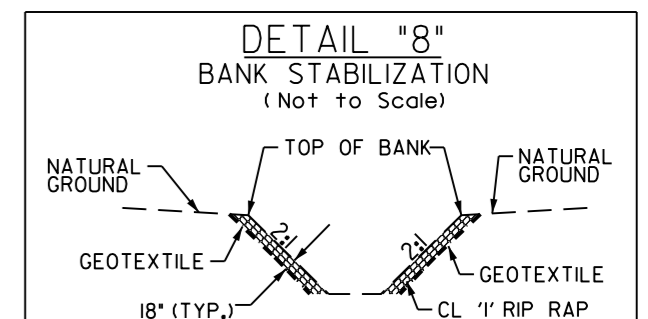
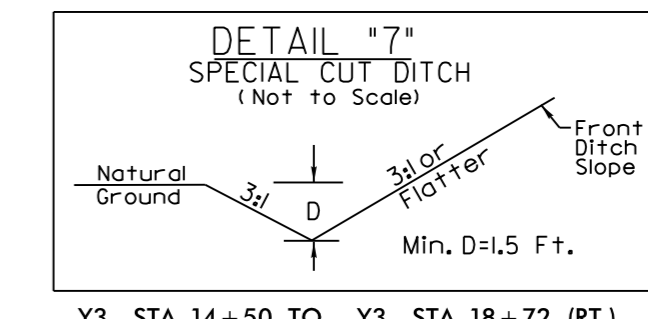

-Y3- STA. 14+50 TO -Y3- STA. 18+72 (RT.)

DRAINAGE STRUCTURE 0704: -Y3- STA. 18+74 (RT.)  
30 TONS CL '1' RIP RAP, 50 SY GEOTEXTILE, 10 CY DDE

**-Y3-**  
PI Sta 13+56.76  
 $\Delta = 9' 12' 36.7''$  (RT)  
D = 3' 05' 49.4"  
L = 297.38'  
T = 149.01'  
R = 1,850.00'  
SE = EXIST.

PI Sta 23+91.33  
 $\Delta = 5' 08' 53.2''$  (RT)  
D = 2' 23' 14.4"  
L = 215.64'  
T = 107.89'  
R = 2,400.00'  
SE = EXIST.

**-Y4-**  
PI Sta 15+98.95  
 $\Delta = 27' 01' 44.5''$  (RT)  
D = 57' 17' 44.8"  
L = 471.7'  
T = 24.03'  
R = 100.00'  
SE = EXIST.

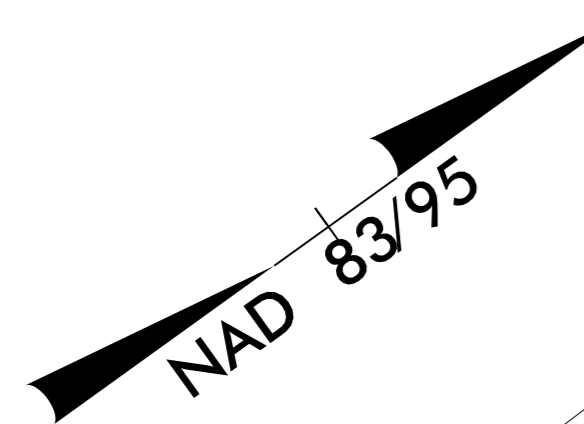
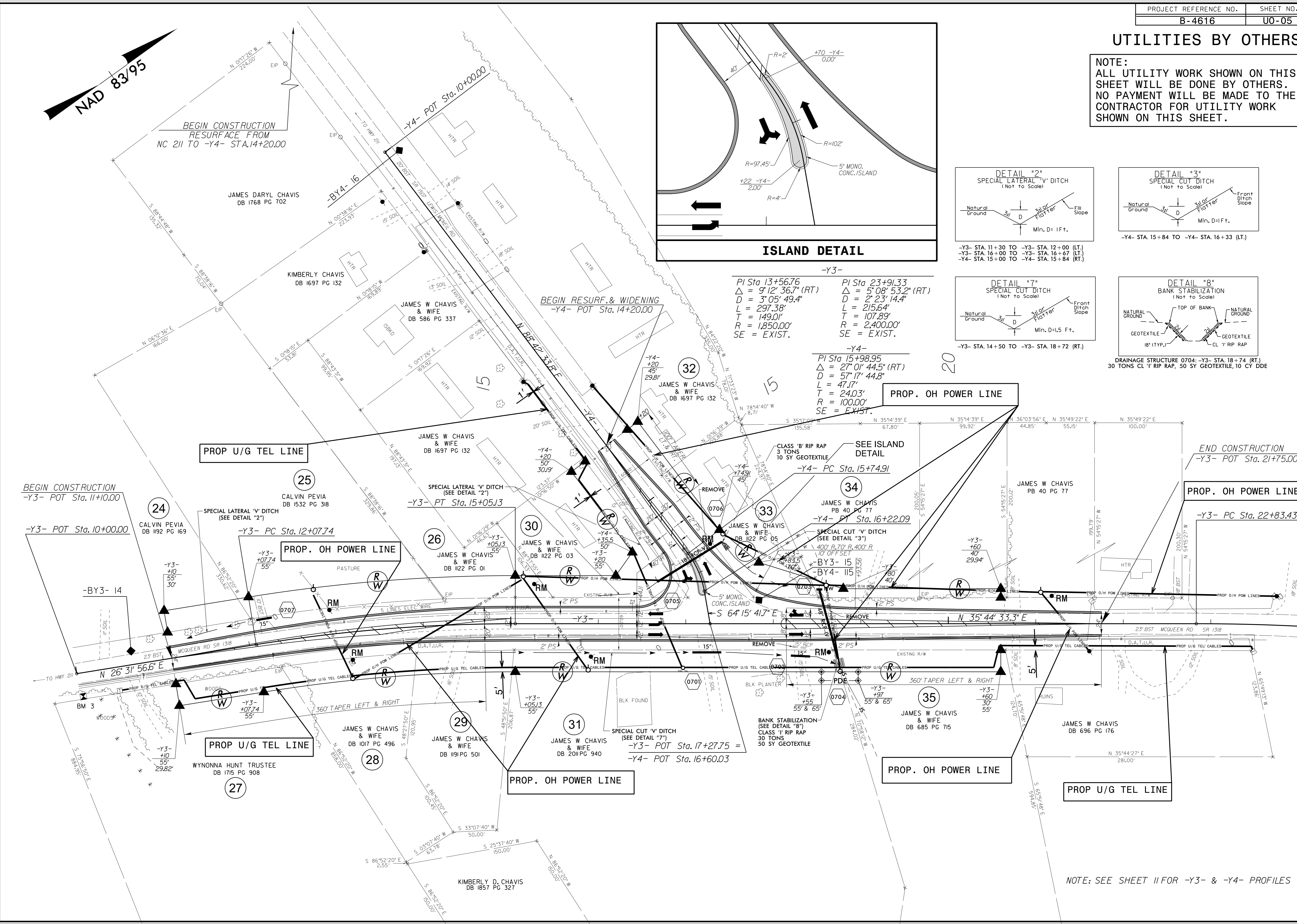

12/12/16 RAW REVISION: ADJUSTED OFFSETS BASED ON THE FIELD STAKING ON PARCELS 24, 27, 30, 32, 34 & 35 (WSP/PB, BAW)

04-MAY-2017 08:49  
C:\PROJECTS\B4616\ut\_rdy7\_U005.psh.dgn

NOTE: SEE SHEET 11 FOR -Y3- & -Y4- PROFILES