

SURVEY CONTROL SHEET B-4616 (DETOUR)

BY3		POINT	DESC.	NORTH	EAST	ELEVATION	EY3 STATION	OFFSET
	14	B4616	BY3-14	369147.3968	1969082.8473	167.66	10+65.28	15.64 LT
	15	B4616	BY3-15	369763.9967	1969454.8124	170.51	17+83.64	27.06 LT

BY4		POINT	DESC.	NORTH	EAST	ELEVATION	EY4 STATION	OFFSET
	115			369763.9667	1969454.8124	170.51	16+66.21	32.72 LT
	16	B4616	BY3-16	369730.6987	1968797.3704	175.86	10+08.18	14.27 LT
	17	B4616	BY4-17	369711.9216	1968029.1816	178.71	OUTSIDE PROJECT LIMITS	

 BM3 ELEVATION = 166.43
 N 369073 E 1969093
 EY4 STATION 12+89.00 650 RIGHT
 RR SPIKE IN BASE OF 16" OAK

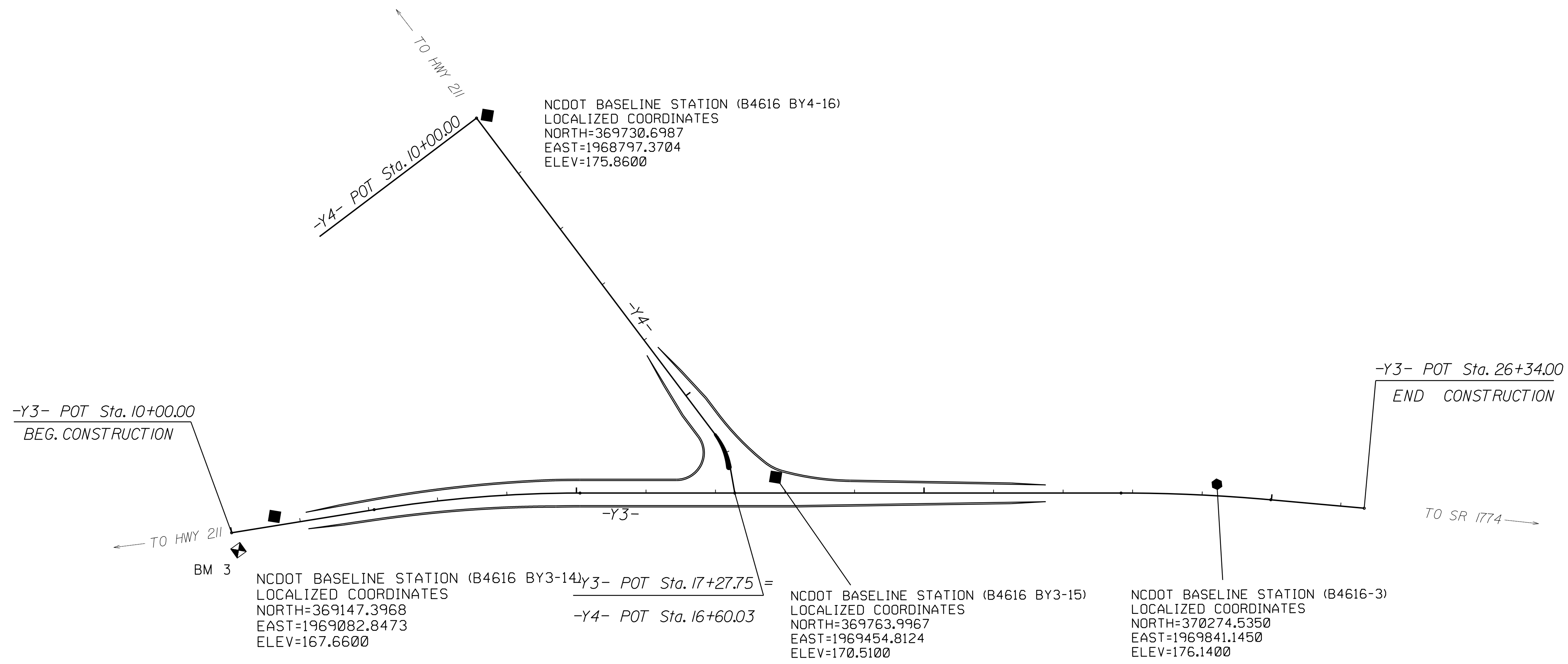
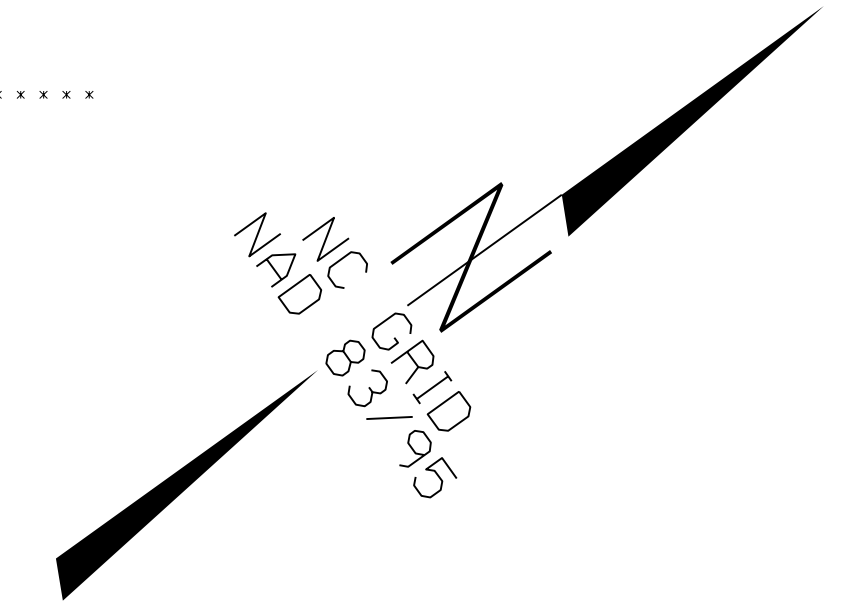

DATUM DESCRIPTION

THE LOCALIZED COORDINATE SYSTEM DEVELOPED FOR THIS PROJECT IS BASED ON THE STATE PLANE COORDINATES ESTABLISHED BY NCOS FOR MONUMENT "PURITAN"

WITH NAD 83/95 STATE PLANE GRID COORDINATES OF
 NORTHING: 370012.554(ft) EASTING: 1959911.038(ft)
 ELEVATION: 182.71(ft)

THE AVERAGE COMBINED GRID FACTOR USED ON THIS PROJECT (GROUND TO GRID) IS: .99990468

THE N.C. LAMBERT GRID BEARING AND LOCALIZED HORIZONTAL GROUND DISTANCE FROM "PURITAN" TO -L- STATION 10+00.00 IS
 S 35°03'20.2" E 6528.5586

ALL LINEAR DIMENSIONS ARE LOCALIZED HORIZONTAL DISTANCES
 VERTICAL DATUM USED IS NAVD 88

NOTES:

1. THE CONTROL DATA FOR THIS PROJECT CAN BE FOUND ELECTRONICALLY BY SELECTING PROJECT CONTROL DATA AT:
[HTTPS://CONNECT.NCDOT.GOV/RESOURCES/LOCATION](https://connect.ncdot.gov/resources/location)

THE FILES TO BE FOUND ARE AS FOLLOWS:
 B-4616_LS_CONTROL.TXT

SITE CALIBRATION INFORMATION HAS NOT BEEN PROVIDED FOR THIS PROJECT. IF FURTHER INFORMATION IS NEEDED, PLEASE CONTACT THE LOCATION AND SURVEYS UNIT.

© INDICATES GEODETIC CONTROL MONUMENTS USED OR SET FOR HORIZONTAL PROJECT CONTROL BY THE NCDOT LOCATION AND SURVEYS UNIT.
 PROJECT CONTROL ESTABLISHED USING GLOBAL POSITIONING SYSTEM.
 NETWORK ESTABLISHED FROM EXISTING HARN MONUMENTATION
 SEE GPS CALIBRATION SHEET FOR HORIZONTAL AND VERTICAL COORDINATE VALUES.

NOTE: DRAWING NOT TO SCALE