

5/28/17

-EL-



5121 Kingdom Way,
Suite 100
Raleigh, NC 27607
NC License No: F-0258

PROJECT REFERENCE NO. <i>R-5311A</i>	SHEET NO. <i>12</i>
ROADWAY DESIGN ENGINEER <i>Dena C. Sneed</i>	HYDRAULICS ENGINEER <i>Isabel O. Colucci</i>
PROFESSIONAL SEAL 032074 DENY C. SNEED	PROFESSIONAL SEAL 034364 ISABEL O. COLUCCI
DocuSigned by: <i>Dena C. Sneed</i> 5/10/2017	DocuSigned by: <i>Isabel O. Colucci</i> 5/10/2017

**DOCUMENT NOT CONSIDERED FINAL
UNLESS ALL SIGNATURES COMPLETED**

TBM-2
R.R. SPIKE IN 14" PINE
-EL- STA 314+73.00, OFFSET 178' LT,
ELEV = 55.41'

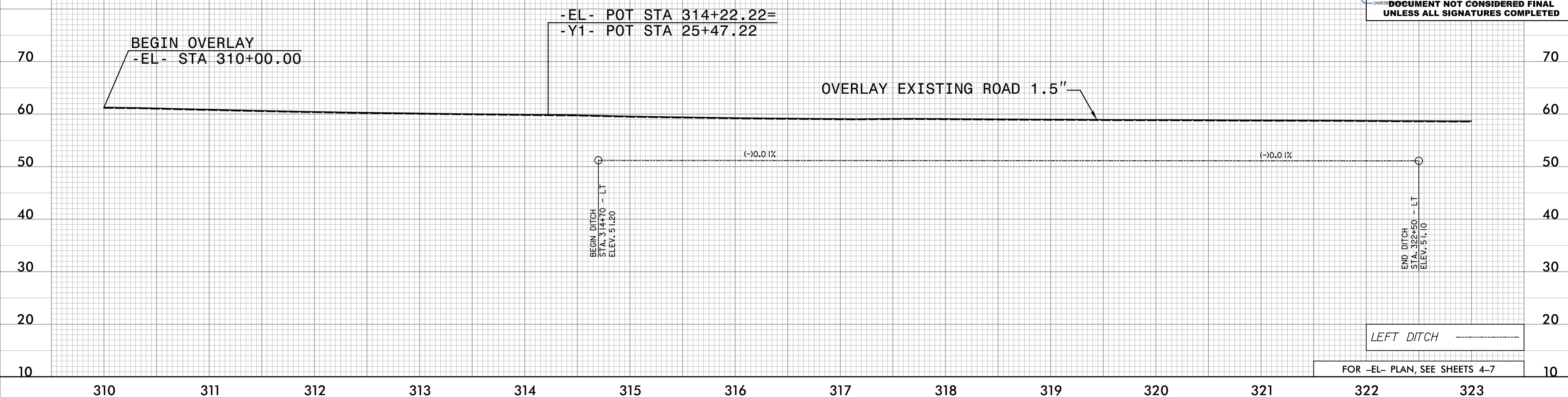

-EL-

TBM-3
R.R. SPIKE IN 20" OAK
-EL- STA 332+78.00, OFFSET 73' RT,
ELEV = 54.01'

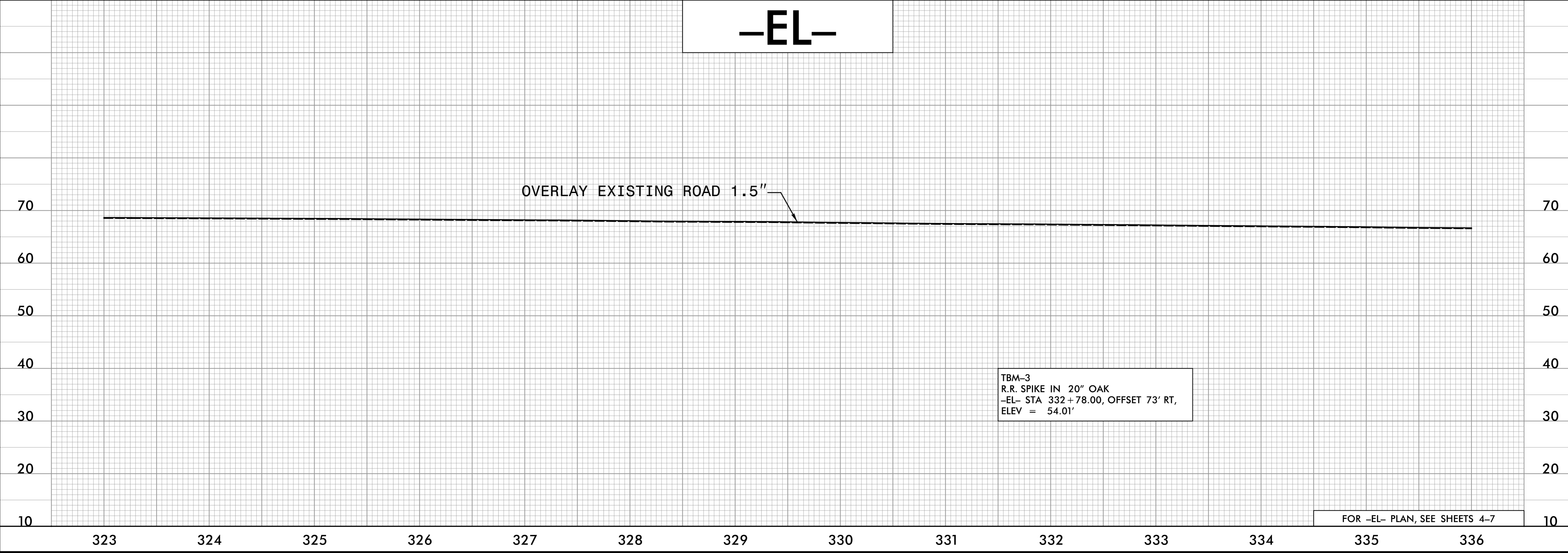

5/16/2017
P:\Projects\171114\RDY_PSH_12.dgn