

-DETI-
PI Sta 11+38.30
 $\Delta = 3^{\circ}12'49.4"$ (LT)
D = 1'09" 43.9"
L = 276.52'
T = 138.30'
R = 4,930.00'
SE = 0.02
V = 45mph

ROADWAY DESIGN ENGINEER
NORTH CAROLINA PROFESSIONAL SEAL 032074
DENNA C. SNEED

HYDRAULICS ENGINEER
NORTH CAROLINA PROFESSIONAL SEAL 034364
DEVON J. CORNER

DocuSigned by: *Denna C. Sneed* 5/10/2017
DocuSigned by: *Devon J. Corner* 5/10/2017
DOCUMENT NOT CONSIDERED FINAL UNLESS ALL SIGNATURES COMPLETED

NAD 83/NSRS 2007

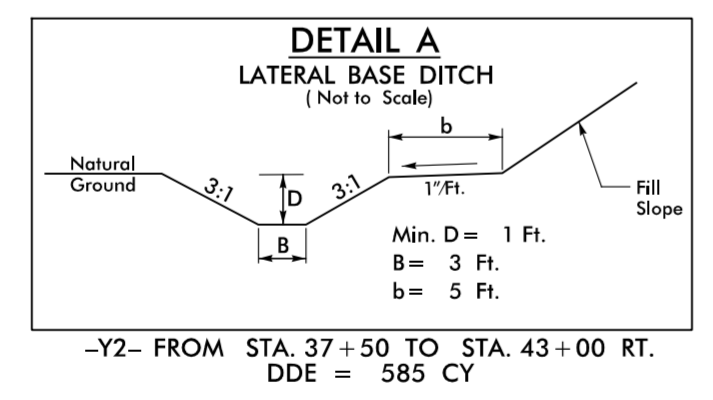
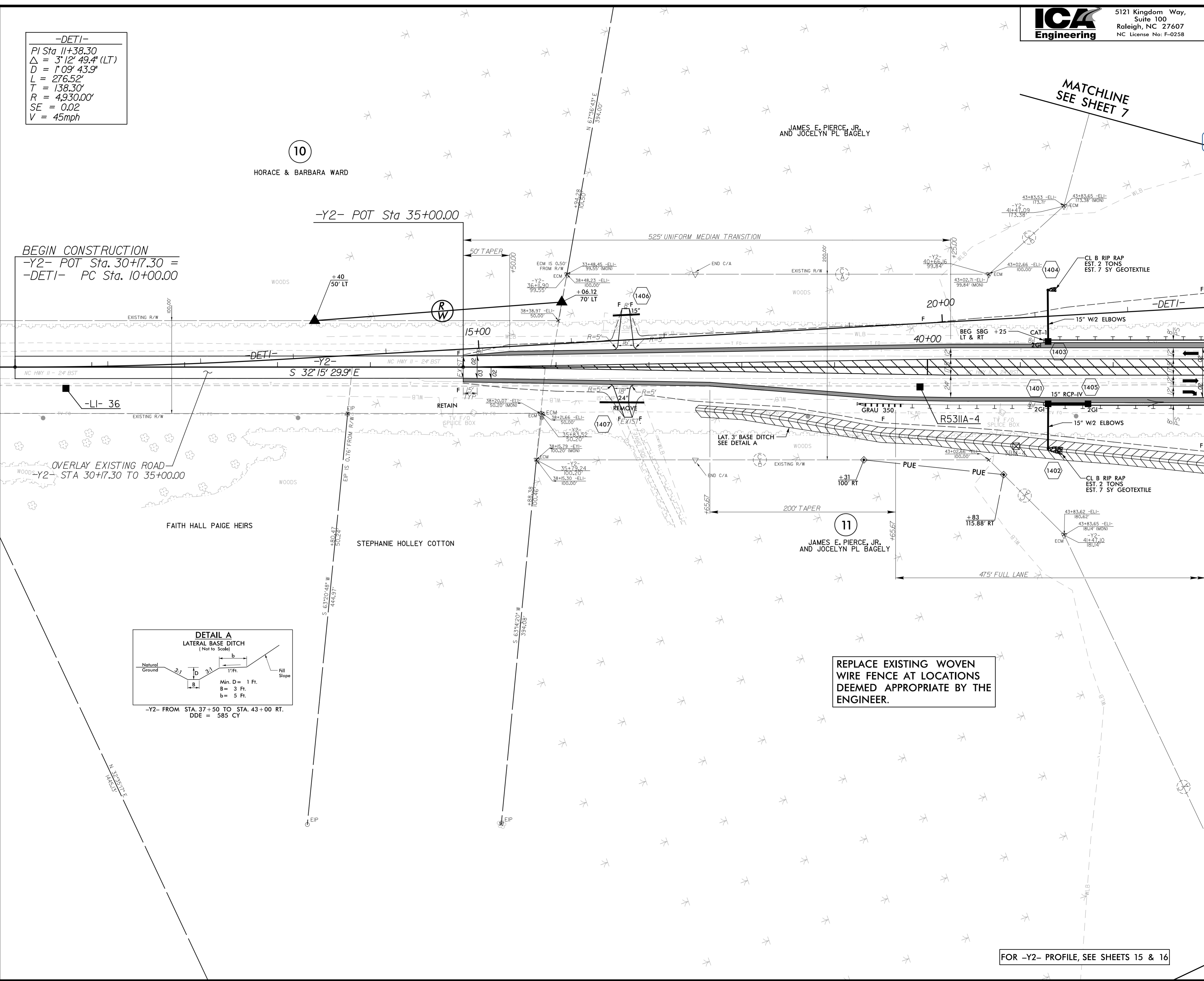

FOR -Y2- PROFILE, SEE SHEETS 15 & 16

MATCHLINE -Y2- STA 43+00 SEE SHEET 7

8/17/19
8/17/2017
P:\Projects\1905311A-RDY_PSH_10.dgn
D:\Engineering\1905311A