

**DOCUMENT NOT CONSIDERED FINAL
UNLESS ALL SIGNATURES COMPLETED**

ROADWAY DESIGN ENGINEER
 DENA C. SNEAD
 SEAL 032074
 5/10/2017

HYDRAULICS ENGINEER
 JACOB J. CORNELL
 SEAL 034364
 5/10/2017

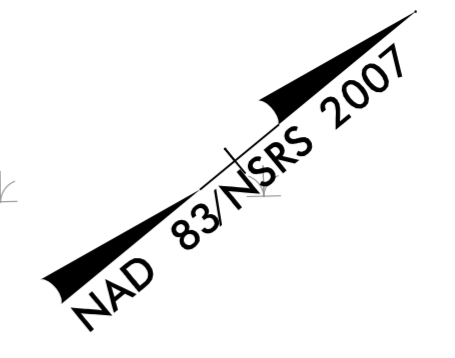

-EL-
 Pls Sta 331+87.41 PI Sta 338+07.68 Pls Sta 344+27.08
 $\theta_s = 0^\circ 30' 00.0''$ $\Delta = 5^\circ 31' 54.0''$ (RT) $\theta_s = 0^\circ 30' 00.0''$
 $L_s = 200.00'$ $D = 0^\circ 30' 00.0''$ $L_s = 200.00'$
 $LT = 133.33'$ $L = 1,106.33'$ $LT = 133.33'$
 $ST = 66.67'$ $T = 553.60'$ $ST = 66.67'$
 $R = 11,459.16'$

JAMES E. PIERCE, JR.
AND JOCELYN PL BAGELY

REPLACE EXISTING WOVEN
 WIRE FENCE AT LOCATIONS
 DEEMED APPROPRIATE BY THE
 ENGINEER.

MATCHLINE -EL- STA 334+00
SEE SHEET 5

MATCHLINE -EL- STA 348+00
SEE SHEET 7

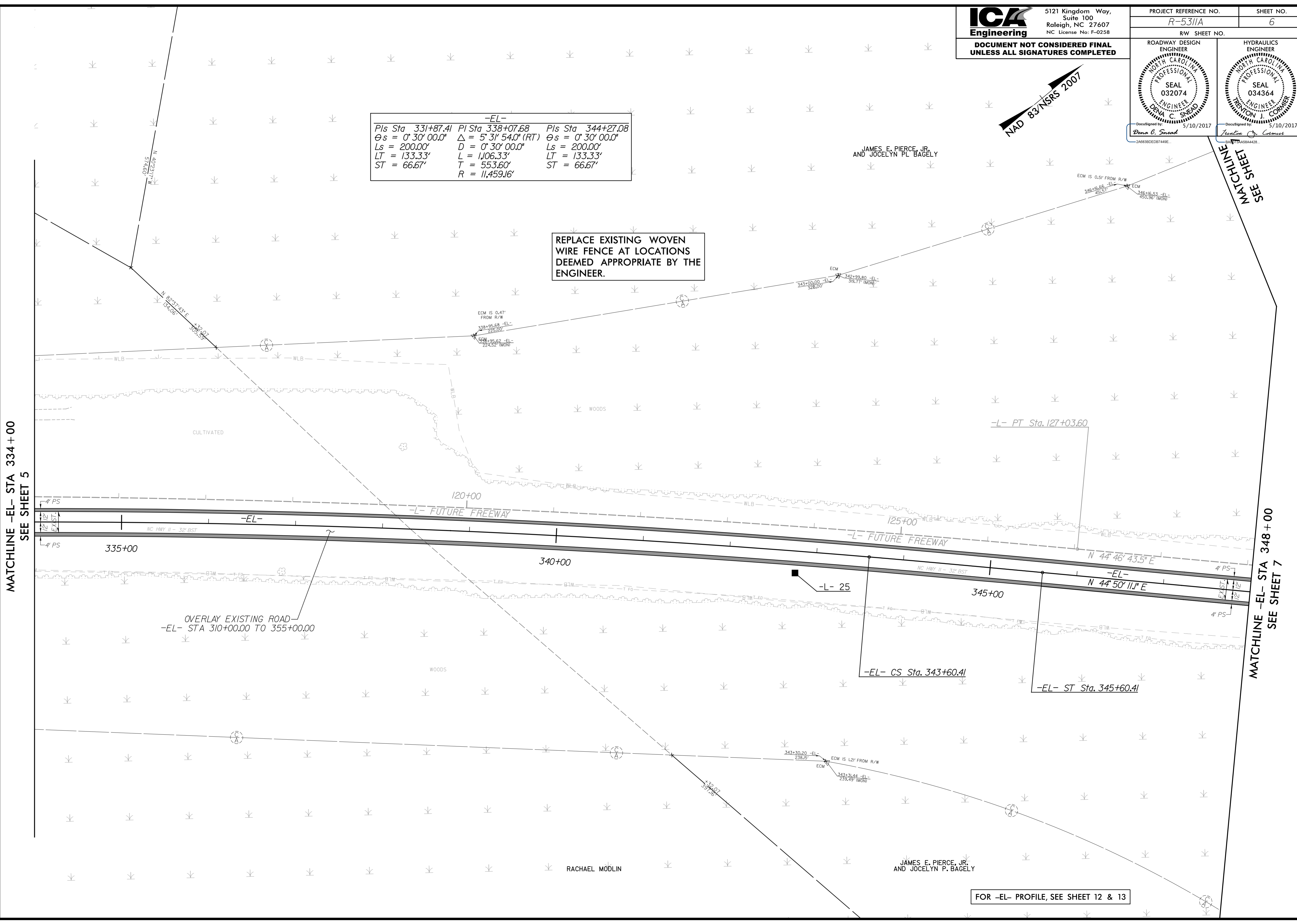

FOR -EL- PROFILE, SEE SHEET 12 & 13