

01/14/2016

B-5345 SURVEY CONTROL SHEET

PROJECT REFERENCE NO.	SHEET NO.
B-5345	1C-1
Location and Surveys	

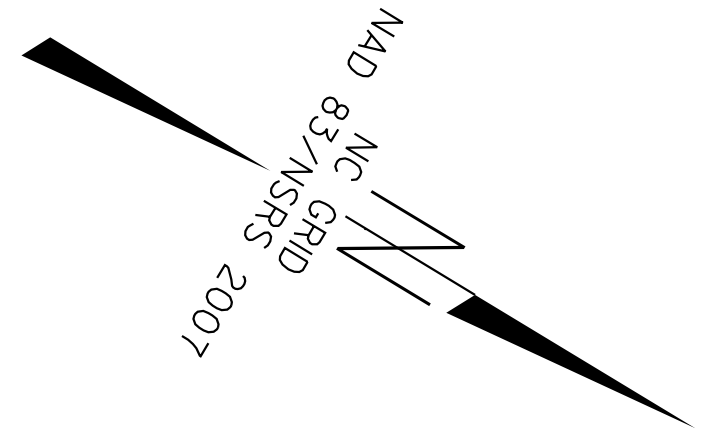

BEGIN TIP PROJECT B-5345
-L- Sta. 12 + 78.62

END TIP PROJECT B-5345
-L- Sta. 20 + 18.63

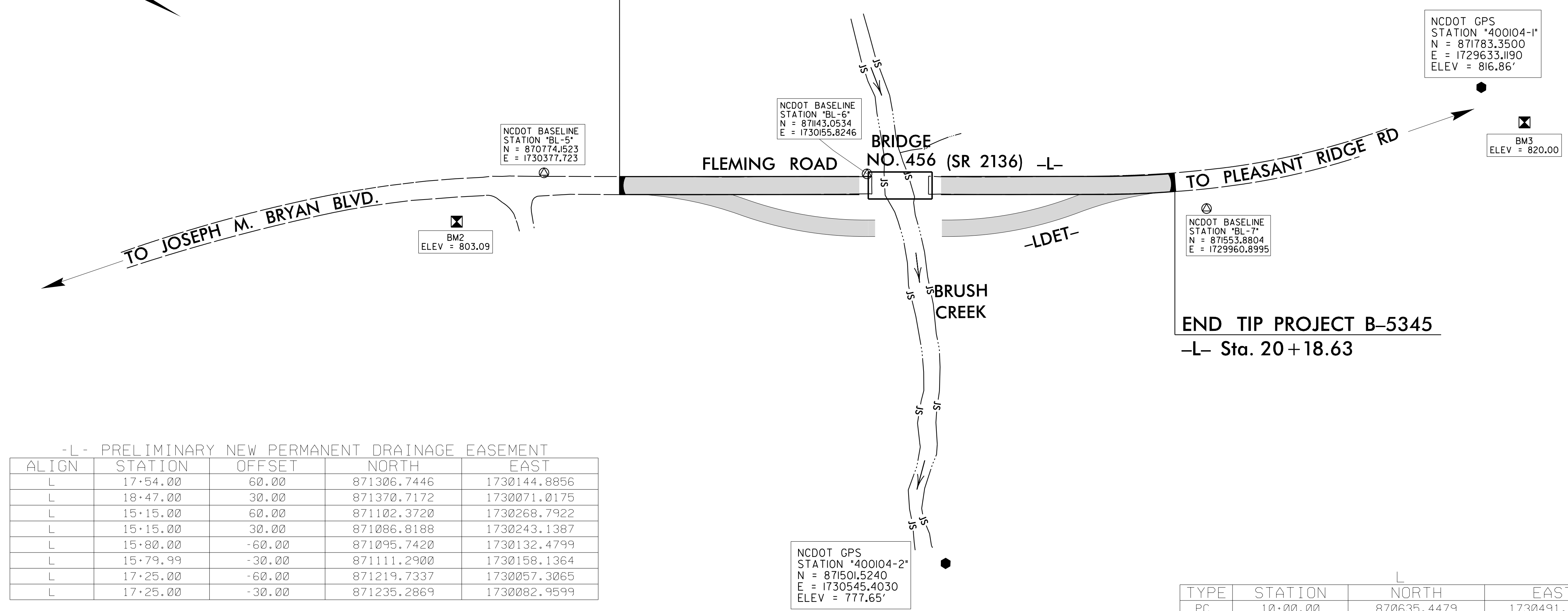

-L- PRELIMINARY NEW PERMANENT DRAINAGE EASEMENT

ALIGN	STATION	OFFSET	NORTH	EAST
L	17+54.00	60.00	871306.7446	1730144.8856
L	18+47.00	30.00	871370.7172	1730071.0175
L	15+15.00	60.00	871102.3720	1730268.7922
L	15+15.00	30.00	871086.8188	1730243.1387
L	15+80.00	-60.00	871095.7420	1730132.4799
L	15+79.99	-30.00	871111.2900	1730158.1364
L	17+25.00	-60.00	871219.7337	1730057.3065
L	17+25.00	-30.00	871235.2869	1730082.9599

BASELINE DATA

BL POINT	DESC.	NORTH	EAST	ELEVATION	L STATION	OFFSET
5	BL-5	870774.1523	1730377.7230	790.07	11+77.86	17.01 LT
6	BL-6	871143.0534	1730155.8246	780.52	16+08.35	15.51 LT
7	BL-7	871553.8804	1729960.8995	794.81	20+56.62	38.76 RT
A1	400104-1	871783.3500	1729633.1190	816.86	24+49.04	23.91 LT

BENCHMARK DATA

.....
 BM2 ELEVATION = 803.09
 N 870708 E 1730494
 L STATION 10+58.00 45' RIGHT

 BM3 ELEVATION = 820.00
 N 871857 E 1729643
 L STATION 24+88.20 39' RIGHT

DATUM DESCRIPTION

THE LOCALIZED COORDINATE SYSTEM DEVELOPED FOR THIS PROJECT IS BASED ON THE STATE PLANE COORDINATES ESTABLISHED BY NCGS FOR MONUMENT "400104-2" WITH NAD 83/NSRS 2007 STATE PLANE GRID COORDINATES OF NORTHING: 871501.5240(ft) EASTING: 1730545.4030(ft) ELEVATION: 777.65(ft)
 THE AVERAGE COMBINED GRID FACTOR USED ON THIS PROJECT (GROUND TO GRID) IS: 0.9999608137
 THE N.C. LAMBERT GRID BEARING AND LOCALIZED HORIZONTAL GROUND DISTANCE FROM "400104-2" TO -L- STATION 12+78.62 IS
 S 17°59'28" W 664.90'
 ALL LINEAR DIMENSIONS ARE LOCALIZED HORIZONTAL DISTANCES
 VERTICAL DATUM USED IS NAVD 88

TYPE	STATION	NORTH	EAST
PC	10+00.00	870635.4479	1730491.4221
PT	11+50.25	870759.3614	1730406.5860
PC	19+20.50	871418.0134	1730007.2599
PT	23+18.71	871718.3765	1729748.5947
POT	25+00.00	871834.3203	1729609.2325

NOTES

- THE CONTROL DATA FOR THIS PROJECT CAN BE FOUND ELECTRONICALLY BY SELECTING PROJECT CONTROL DATA AT:
[HTTP://WWW.DOH.DOT.STATE.NC.US/PRECONSTRUCT/HIGHWAY/LOCATION/PROJECT/](http://www.doh.dot.state.nc.us/preconstruct/highway/location/project/)
 THE FILES TO BE FOUND ARE AS FOLLOWS:
 B5345_LS_control.txt
 SITE CALIBRATION INFORMATION HAS NOT BEEN PROVIDED FOR THIS PROJECT. IF FURTHER INFORMATION IS NEEDED, PLEASE CONTACT THE LOCATION AND SURVEYS UNIT.
- ⊙ INDICATES GEODETIC CONTROL MONUMENTS USED OR SET FOR HORIZONTAL PROJECT CONTROL BY THE NCDOT LOCATION AND SURVEYS UNIT.
 PROJECT CONTROL ESTABLISHED USING GLOBAL POSITIONING SYSTEM.
 NETWORK ESTABLISHED FROM NGS ONLINE POSITIONING SERVICE (OPUS)

NOTE: DRAWING NOT TO SCALE