

| | |
|--|---|
| PROJECT REFERENCE NO. R-516 | SHEET NO. 9 |
| RW SHEET NO. | |
| ROADWAY DESIGN ENGINEER <i>[Signature]</i> 5/15/2011 | HYDRAULICS ENGINEER <i>[Signature]</i> 5/15/2011 |
| Prepared in the Office of: AECOM NC FIRM LICENSE No F-0342 70 Corporate Center Drive, Suite 415 Cary, NC 27513 (919) 654-6200 • (919) 654-6259 FAX | |

DOCUMENT NOT CONSIDERED FINAL UNLESS ALL SIGNATURES COMPLETED

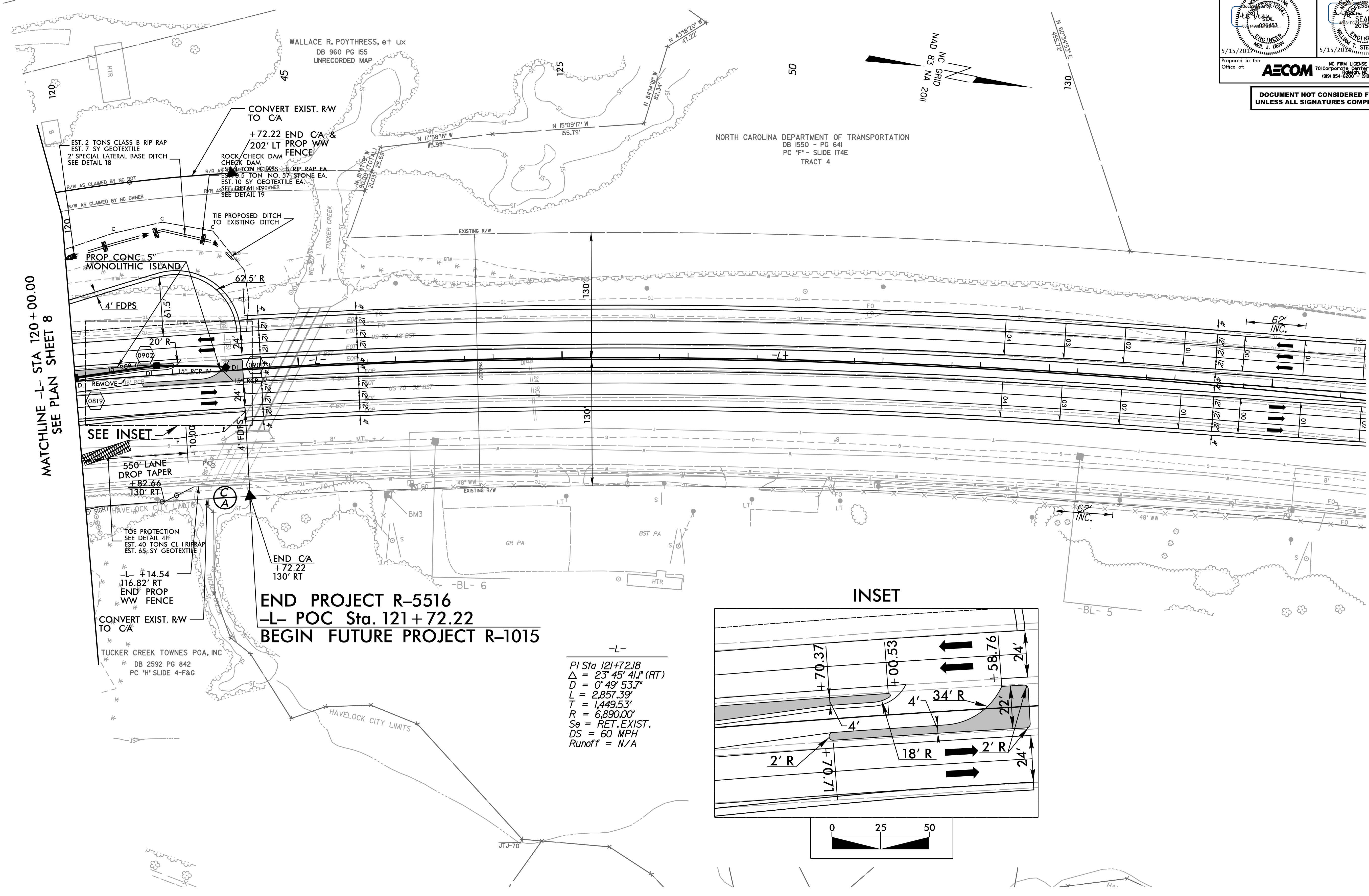

MATCHLINE -L- STA 120+00.00 SEE PLAN SHEET 8

END PROJECT R-516
-L- POC Sta. 121+72.22
BEGIN FUTURE PROJECT R-1015

-L-
 PI Sta 121+72.18
 $\Delta = 23^{\circ} 45' 41''$ (RT)
 $D = 0^{\circ} 49' 53.7''$
 $L = 2,857.39'$
 $T = 1,449.53'$
 $R = 6,890.00'$
 $S_e = \text{RET. EXIST.}$
 $DS = 60 \text{ MPH}$
 $\text{Runoff} = \text{N/A}$

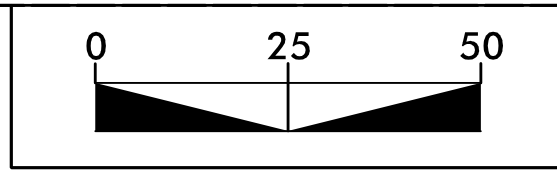
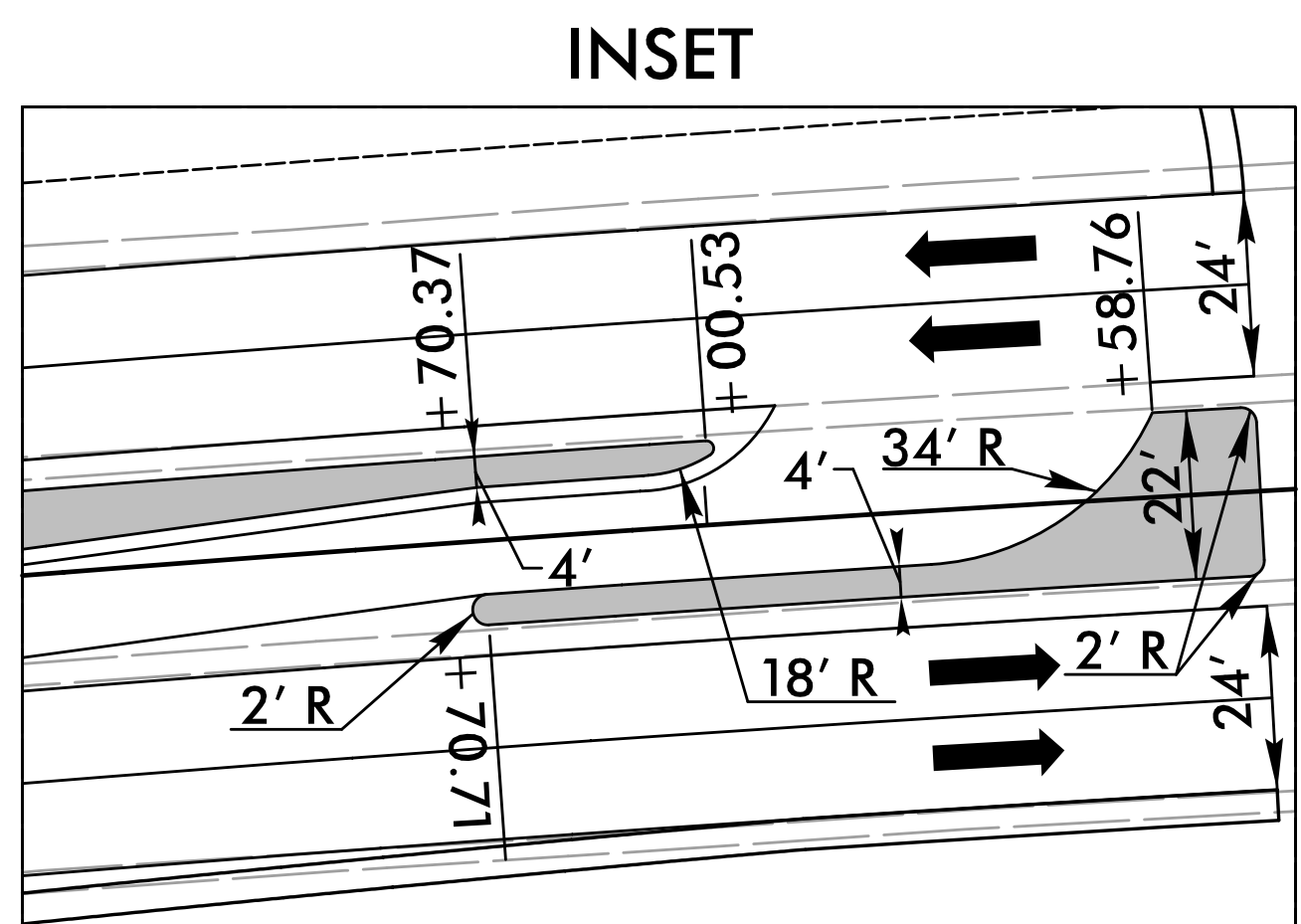

REVISIONS

DATE/TIME: 10/30/10 AM
 DES: R:\Roadway\Proj\R-516\rdw\plan_09.dwg

FOR -L- PROFILE, SEE SHEET NO. 18