

NOTES

AT THE CONTRACTOR'S OPTION, THE APPROACH SLAB MAY BE CAST MONOLITHICALLY WITH THE INTEGRAL END BENT DIAPHRAGM AND THE END SECTION OF BRIDGE DECK. IF CAST WITH THE INTEGRAL DIAPHRAGM, THE LAYERS OF ROOFING FELT SHALL BE OMITTED. IF CAST SEPARATE FROM THE INTEGRAL DIAPHRAGM, APPROACH SLAB SHALL NOT BE CONSTRUCTED PRIOR TO COMPLETION OF THE BRIDGE DECK.

AREA BETWEEN THE WINGWALL AND APPROACH SLAB SHALL BE GRADED TO DRAIN THE WATER AWAY FROM THE FILL FACE OF THE BRIDGE AND SHALL BE PAVED. SEE ROADWAY PLANS.

THE JOINT OPENING AT THE APPROACH SLAB/DECK INTERFACE SHALL BE SAWED NO MORE THAN 12 HOURS AFTER THE APPROACH SLAB IS CAST. THE JOINT SHALL BE CLEANED OF ALL DEBRIS BEFORE THE SEALANT IS APPLIED. THE JOINT SEALER MATERIAL SHALL CONFORM TO THE REQUIREMENTS OF SECTION 1028-3 OF THE STANDARD SPECIFICATIONS. FOR BRIDGE APPROACH FILL INCLUDING GEOTEXTILE, 4" Ø DRAINAGE PIPE, AND #78M STONE BACKFILL, SEE ROADWAY PLANS.

THE JOINT IN THE DECK SHALL BE SAWED PRIOR TO THE CASTING OF THE MONOLITHIC ISLAND.

FOR BRIDGE APPROACH FILL INCLUDING GEOTEXTILE, 4" Ø DRAINAGE PIPE, AND #78M STONE BACKFILL, SEE ROADWAY PLANS.

GEOTEXTILE SHALL BE TYPE 1 IN ACCORDANCE WITH THE STANDARD SPECIFICATIONS SECTION 1056.

#78M STONE BACKFILL (CLASS V SELECT MATERIAL) SHALL BE IN ACCORDANCE WITH STANDARD SPECIFICATIONS SECTION 1016.

#78M STONE BACKFILL IS TO BE CONTINUOUS ALONG FILL FACE OF BACKWALL FROM OUTSIDE EDGE TO OUTSIDE EDGE OF APPROACH SLAB.

FOR THE 4" Ø DRAINAGE PIPE OUTLET(S), SEE ROADWAY STANDARD DRAWINGS.

FOR REINFORCING IN THE MONOLITHIC ISLAND, SEE "BRIDGE APPROACH SLAB DETAILS" SHEET.

BILL OF MATERIAL

STAGE I
FOR ONE APPROACH SLAB
(2 REQ'D)

| BAR | NO. | SIZE | TYPE | LENGTH | WEIGHT |
|-----|-----|------|------|--------|--------|
| A1E | 78 | #4 | STR | 22'-7" | 1,177 |
| A2 | 78 | #4 | STR | 22'-4" | 1,164 |
| B1E | 123 | #5 | STR | 24'-2" | 3,100 |
| B2 | 123 | #6 | STR | 24'-8" | 4,557 |

| | | |
|--------------------------------|-------|-------|
| REINFORCING STEEL | LBS. | 4,277 |
| EPOXY COATED REINFORCING STEEL | LBS. | 5,721 |
| CLASS AA CONCRETE | C. Y. | 66.4 |

STAGE II
FOR ONE APPROACH SLAB
(2 REQ'D)

| BAR | NO. | SIZE | TYPE | LENGTH | WEIGHT |
|-----|-----|------|------|--------|--------|
| A1E | 78 | #4 | STR | 22'-7" | 1,177 |
| A2 | 78 | #4 | STR | 22'-4" | 1,164 |
| B1E | 123 | #5 | STR | 24'-2" | 3,100 |
| B2 | 123 | #6 | STR | 24'-8" | 4,557 |

| | | |
|--------------------------------|-------|-------|
| REINFORCING STEEL | LBS. | 4,277 |
| EPOXY COATED REINFORCING STEEL | LBS. | 5,721 |
| CLASS AA CONCRETE | C. Y. | 66.4 |

FOR ONE MONOLITHIC ISLAND
(2 REQ'D)

| BAR | NO. | SIZE | TYPE | LENGTH | WEIGHT |
|-----|-----|------|------|--------|--------|
| B3E | 3 | #4 | STR | 24'-8" | 49 |
| G1E | 17 | #4 | STR | 2'-10" | 32 |

| | | |
|--------------------------------|-------|-----|
| EPOXY COATED REINFORCING STEEL | LBS. | 81 |
| CLASS AA CONCRETE | C. Y. | 1.3 |

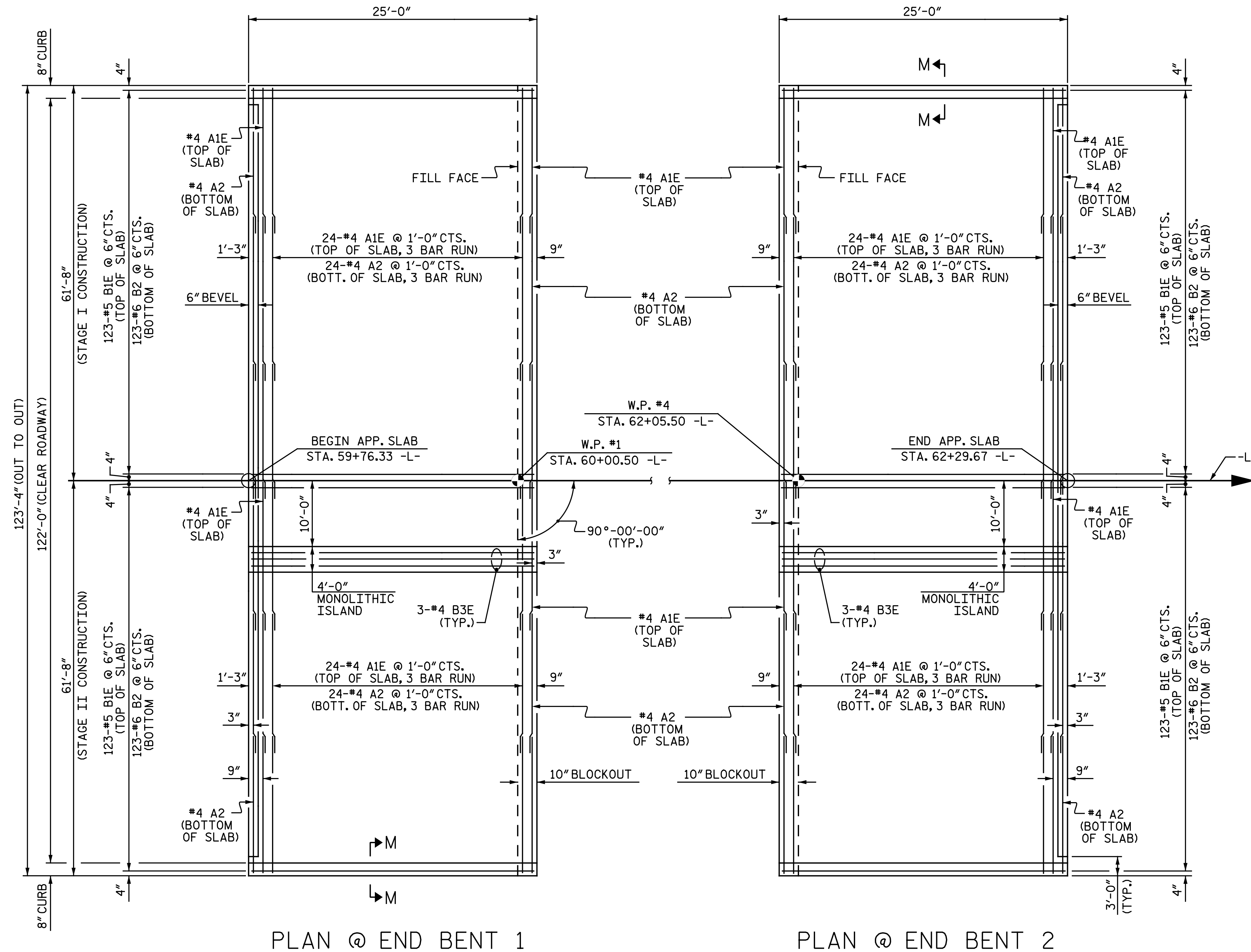

| SPlice LENGTHS | | |
|----------------|--------------|----------|
| BAR SIZE | EPOXY COATED | UNCOATED |
| #4 | 2'-0" | 1'-9" |

PROJECT NO. U-3330
NASH COUNTY
 STATION: 61+03.00 -L-

DRAWN BY : M. D. M. / N. B. S. DATE : 9-14-16
 CHECKED BY : A. H. SHARPE DATE : 9-27-16

| DOCUMENT NOT CONSIDERED FINAL UNLESS ALL SIGNATURES COMPLETED | | STATE OF NORTH CAROLINA DEPARTMENT OF TRANSPORTATION RALEIGH | | | | | | | | | | | | | | | | | |
|---|--|---|-----|-----|-------|-----|-----|-------|---|--|--|---|--|--|---|--|--|---|--|
| | Michael Baker Engineering 8000 Regency Parkway, Suite 600 Cary, North Carolina 27518 NC License No.: F-1084 | BRIDGE APPROACH SLAB FOR INTEGRAL ABUTMENT | | | | | | | | | | | | | | | | | |
| | Michael Baker INTERNATIONAL | REVISIONS <table border="1"> <thead> <tr> <th>NO.</th> <th>BY:</th> <th>DATE:</th> <th>NO.</th> <th>BY:</th> <th>DATE:</th> </tr> </thead> <tbody> <tr> <td>1</td> <td></td> <td></td> <td>3</td> <td></td> <td></td> </tr> <tr> <td>2</td> <td></td> <td></td> <td>4</td> <td></td> <td></td> </tr> </tbody> </table> | NO. | BY: | DATE: | NO. | BY: | DATE: | 1 | | | 3 | | | 2 | | | 4 | |
| NO. | BY: | DATE: | NO. | BY: | DATE: | | | | | | | | | | | | | | |
| 1 | | | 3 | | | | | | | | | | | | | | | | |
| 2 | | | 4 | | | | | | | | | | | | | | | | |
| | | SHEET NO. S3-41 TOTAL SHEETS 42 | | | | | | | | | | | | | | | | | |