

POURING SEQUENCE
 # DENOTES POUR NUMBER AND DIRECTION
 [Hatched Box] DENOTES POUR 8 (CLOSURE POUR)

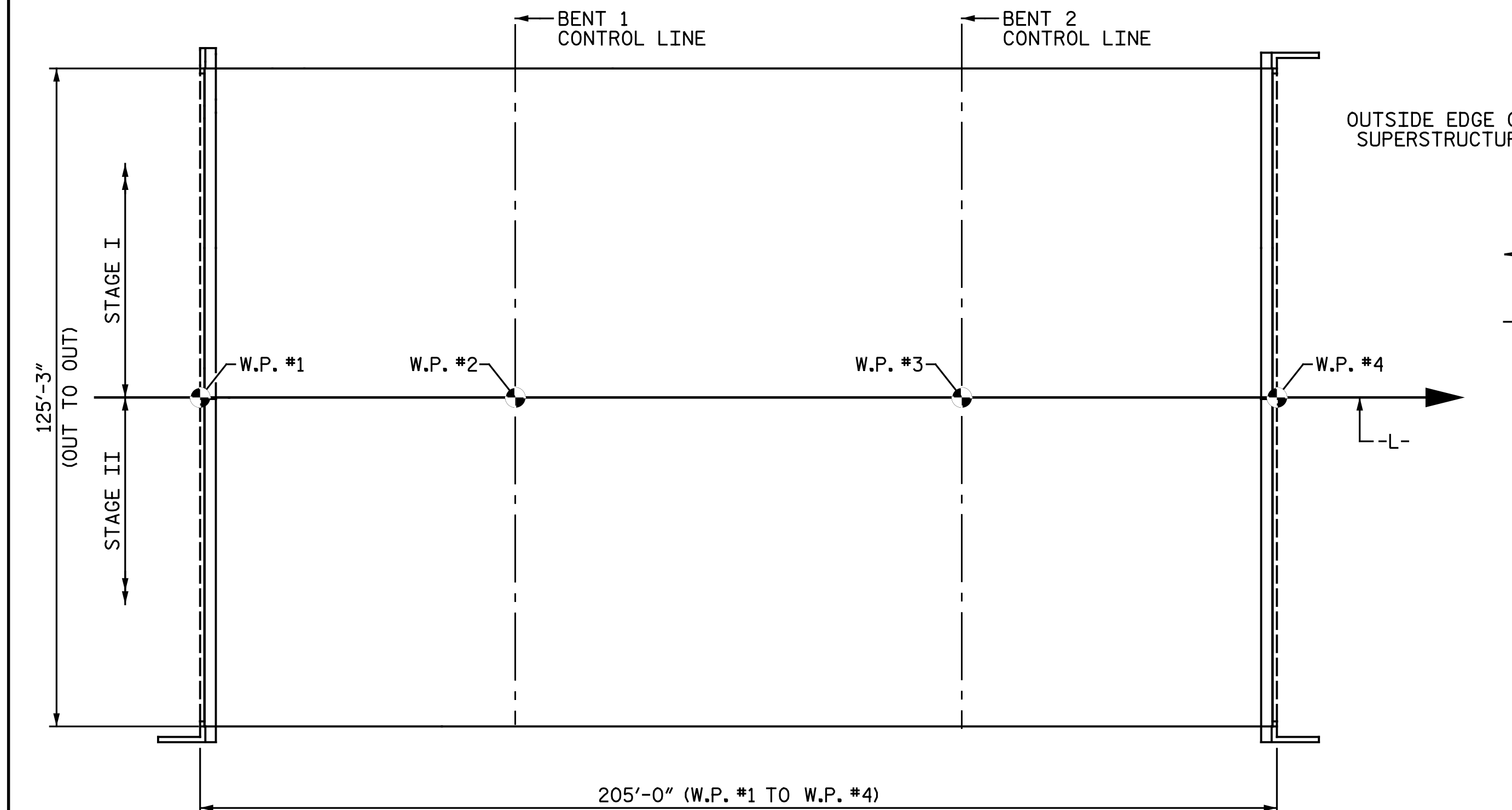

LAYOUT FOR COMPUTING AREA OF REINFORCED CONCRETE DECK SLAB
 (STAGE I - SQ. FT. = 12,838)
 (STAGE II - SQ. FT. = 12,838)
 (TOTAL SQ. FT. = 25,676)

REINFORCING BAR SCHEDULE STAGE I					REINFORCING BAR SCHEDULE STAGE II						
BAR	NO.	SIZE	TYPE	LENGTH	WEIGHT	BAR	NO.	SIZE	TYPE	LENGTH	WEIGHT
A1E	814	#5	STR.	32' - 5"	27,522	A1E	407	#5	STR.	57' - 3"	24,303
A2	814	#5	STR.	32' - 3"	27,380	A2	407	#5	STR.	57' - 3"	24,303
B1E	344	#4	STR.	27' - 2"	6,243	B1E	344	#4	STR.	27' - 2"	6,243
B2	324	#5	STR.	52' - 5"	17,713	B2	308	#5	STR.	52' - 5"	16,839
B3E	84	#6	STR.	14' - 2"	1,787	B3E	82	#6	STR.	14' - 2"	1,745
B4E	84	#6	STR.	16' - 4"	2,061	B4E	82	#6	STR.	16' - 4"	2,012
B5E	168	#6	STR.	33' - 11"	8,558	B5E	164	#6	STR.	33' - 11"	8,355
D1E	814	#5	STR.	6' - 5"	5,448	D1E	814	#5	STR.	6' - 5"	5,448
K1E	36	#4	STR.	22' - 11"	551	K1E	36	#4	STR.	22' - 1"	531
S1E	102	#4	1	11' - 8"	795	S1E	110	#4	1	11' - 8"	857
S2E	100	#4	1	9' - 6"	635	S2E	108	#4	1	9' - 6"	685
U1E	102	#4	2	7' - 2"	488	U1E	110	#4	2	7' - 2"	527
REINFORCING STEEL					LBS. 45,093	REINFORCING STEEL					LBS. 41,142
EPOXY COATED REINF. STEEL					LBS. 54,088	EPOXY COATED REINF. STEEL					LBS. 50,706

'E' SUFFIX DENOTES EPOXY COATED REINFORCING STEEL

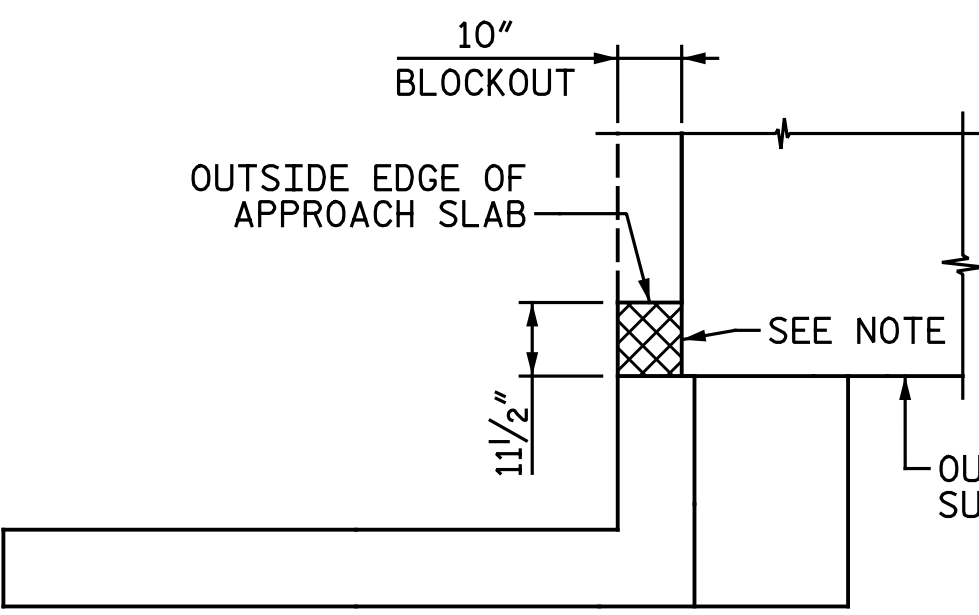

DETAIL "A"
 RIGHT SIDE OF BRIDGE AT END BENT 1 SHOWN, RIGHT SIDE AT END BENT 2 SIMILAR

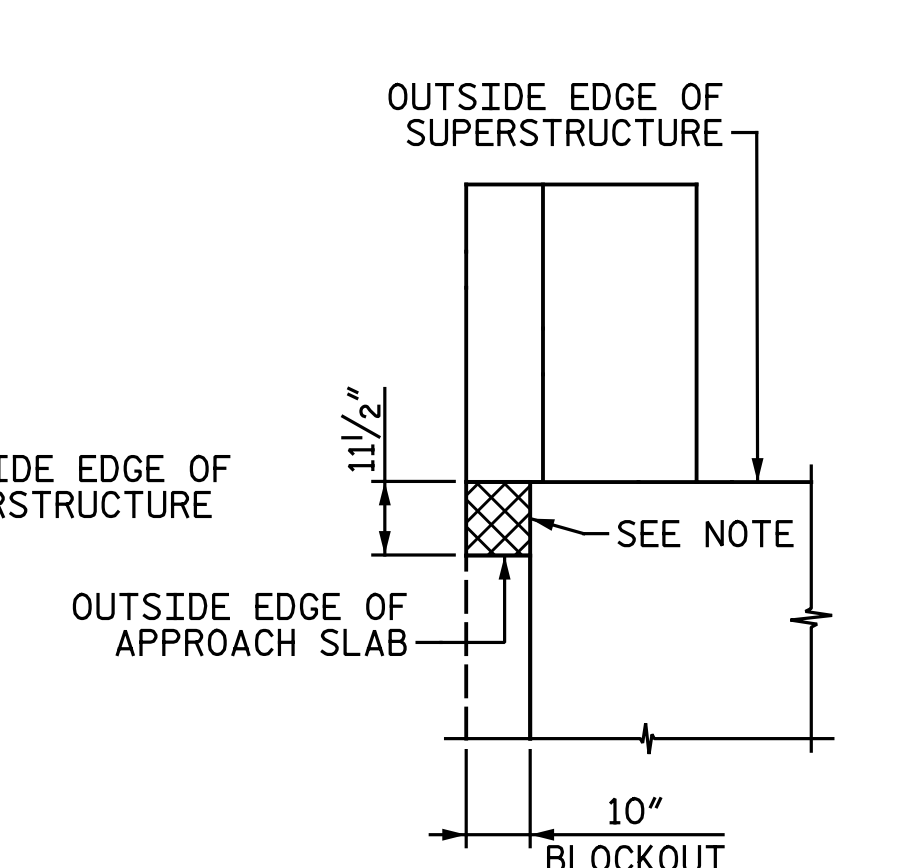

DETAIL "C"

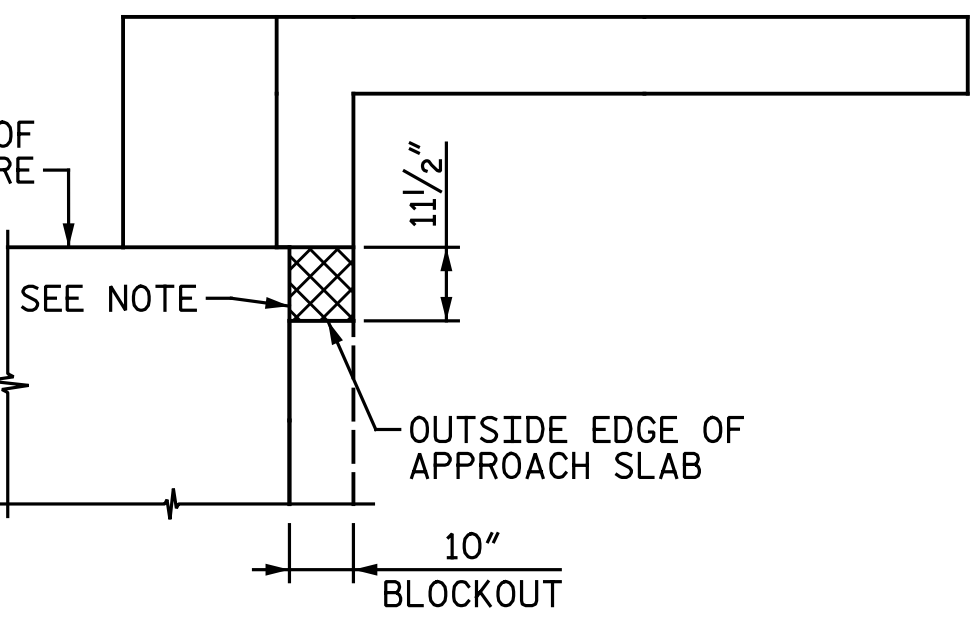

DETAIL "B"

NOTE:
 CONCRETE SHALL BE POURED IN THE CROSS-HATCHED AREAS SHOWN IN DETAIL "A", DETAIL "B" AND DETAIL "C" TO MATCH THE TOP OF END BENT WINGS. UNLESS OTHERWISE DIRECTED BY THE ENGINEER, THE CONCRETE IN THESE AREAS SHALL BE POURED AT THE SAME TIME THE BLOCKOUTS IN THE END BENT WINGS ARE FILLED WITH CONCRETE AS NOTED ON SHEET 1 OF "INTEGRAL END BENT 1" AND "INTEGRAL END BENT 2" SHEETS.

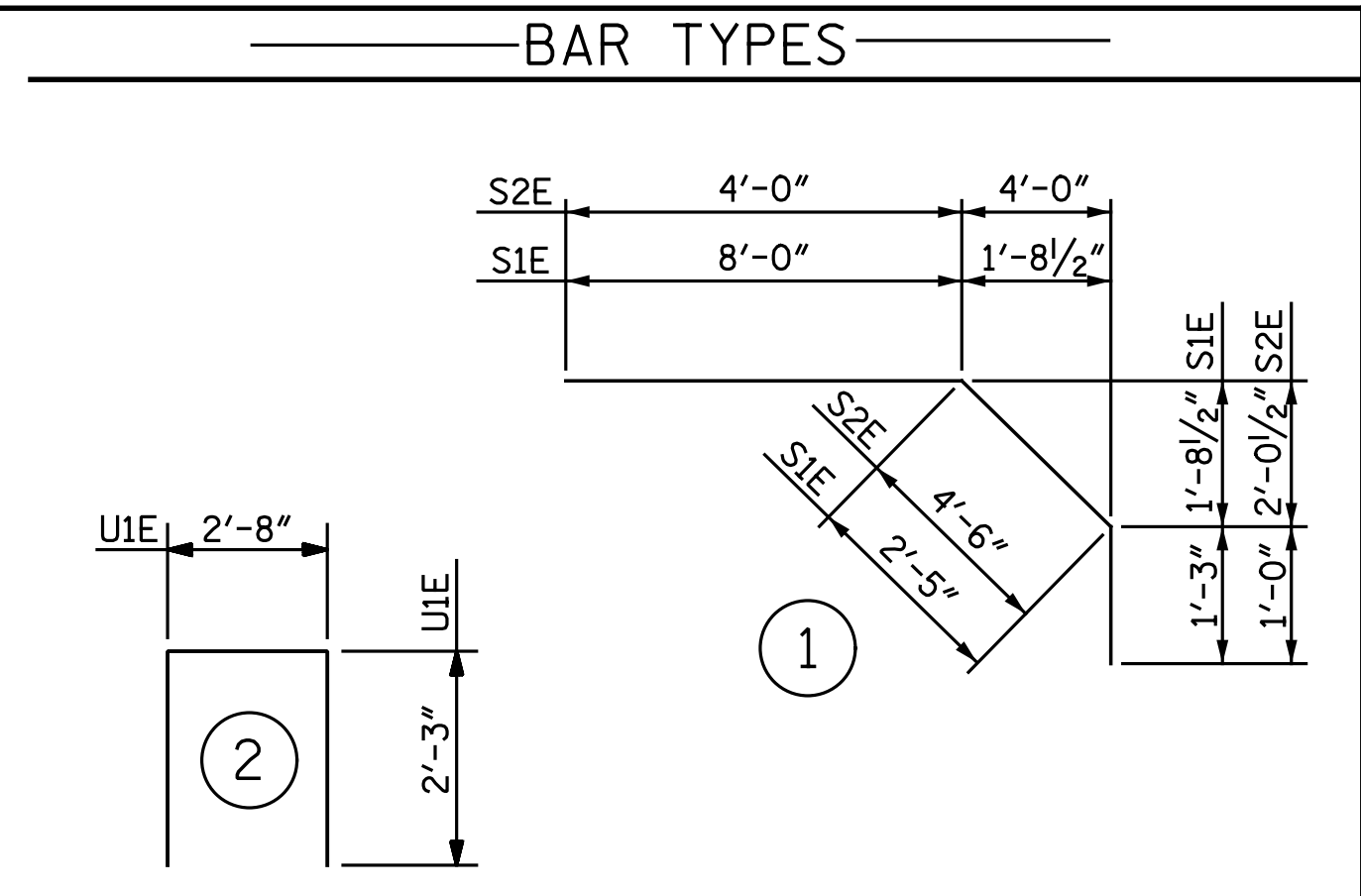

ALL BAR DIMENSIONS ARE OUT TO OUT

SUPERSTRUCTURE BILL OF MATERIAL						
	CLASS AA CONCRETE (CU. YDS.)		REINFORCING STEEL (LBS.)		EPOXY COATED REINFORCING STEEL (LBS.)	
	STAGE I	STAGE II	STAGE I	STAGE II	STAGE I	STAGE II
SPANS A, B & C			45,093	41,142	54,088	50,706
POUR 1	44.7					
POUR 2	168.0					
POUR 3	152.3					
POUR 4 *	61.5					
POUR 5		41.1				
POUR 6		154.6				
POUR 7		140.1				
POUR 8		34.0				
POUR 9 *		61.7				
MONO-LITHIC ISLAND						693
TOTALS **	426.5	442.6	45,093	41,142	54,088	51,399

* POUR 4 AND POUR 9 INCLUDES DIAPHRAGM PORTION OF INTEGRAL END BENT.
 ** QUANTITIES FOR BARRIER RAIL ARE NOT INCLUDED.

GROOVING BRIDGE FLOORS	
APPROACH SLABS - STAGE I	2,896 SQ.FT.
APPROACH SLABS - STAGE II	2,896 SQ.FT.
BRIDGE DECK - STAGE I	12,079 SQ.FT.
BRIDGE DECK - STAGE II	12,079 SQ.FT.
TOTAL	29,950 SQ.FT.

PROJECT NO. U-3330
 NASH COUNTY
 STATION: 61+03.00 -L-

SUPERSTRUCTURE REINFORCING STEEL LENGTHS ARE BASED ON THE FOLLOWING MINIMUM SPLICE LENGTHS					
BAR SIZE	SUPERSTRUCTURE EXCEPT APPROACH SLABS, PARAPET, AND BARRIER RAIL		APPROACH SLABS		PARAPET AND BARRIER RAIL
	EPOXY COATED	UNCOATED	EPOXY COATED	UNCOATED	
#4	2'-0"	1'-9"	2'-0"	1'-9"	2'-9"
#5	2'-6"	2'-2"	2'-6"	2'-2"	3'-5"
#6	3'-0"	2'-7"	3'-10"	2'-7"	4'-4"
#7	5'-3"	3'-6"			
#8	6'-10"	4'-7"			

DRAWN BY: C. E. MAYHEW DATE: 12-12-16
 CHECKED BY: A. H. SHARPE DATE: 12-14-16

DOCUMENT NOT CONSIDERED FINAL UNLESS ALL SIGNATURES COMPLETED

Professional Engineer Seal for Todd M. Garrison, North Carolina License No. 033139, dated 2/3/2017.

Michael Baker Engineering
 8000 Regency Parkway, Suite 600
 Cary, North Carolina 27518
 NC License No.: F-1084

STATE OF NORTH CAROLINA DEPARTMENT OF TRANSPORTATION RALEIGH SUPERSTRUCTURE BILL OF MATERIAL					
REVISIONS					
NO.	BY:	DATE:	NO.	BY:	DATE:
1			3		
2			4		

SHEET NO. S3-23
 TOTAL SHEETS 42