

PLAN OF SIDEWALK

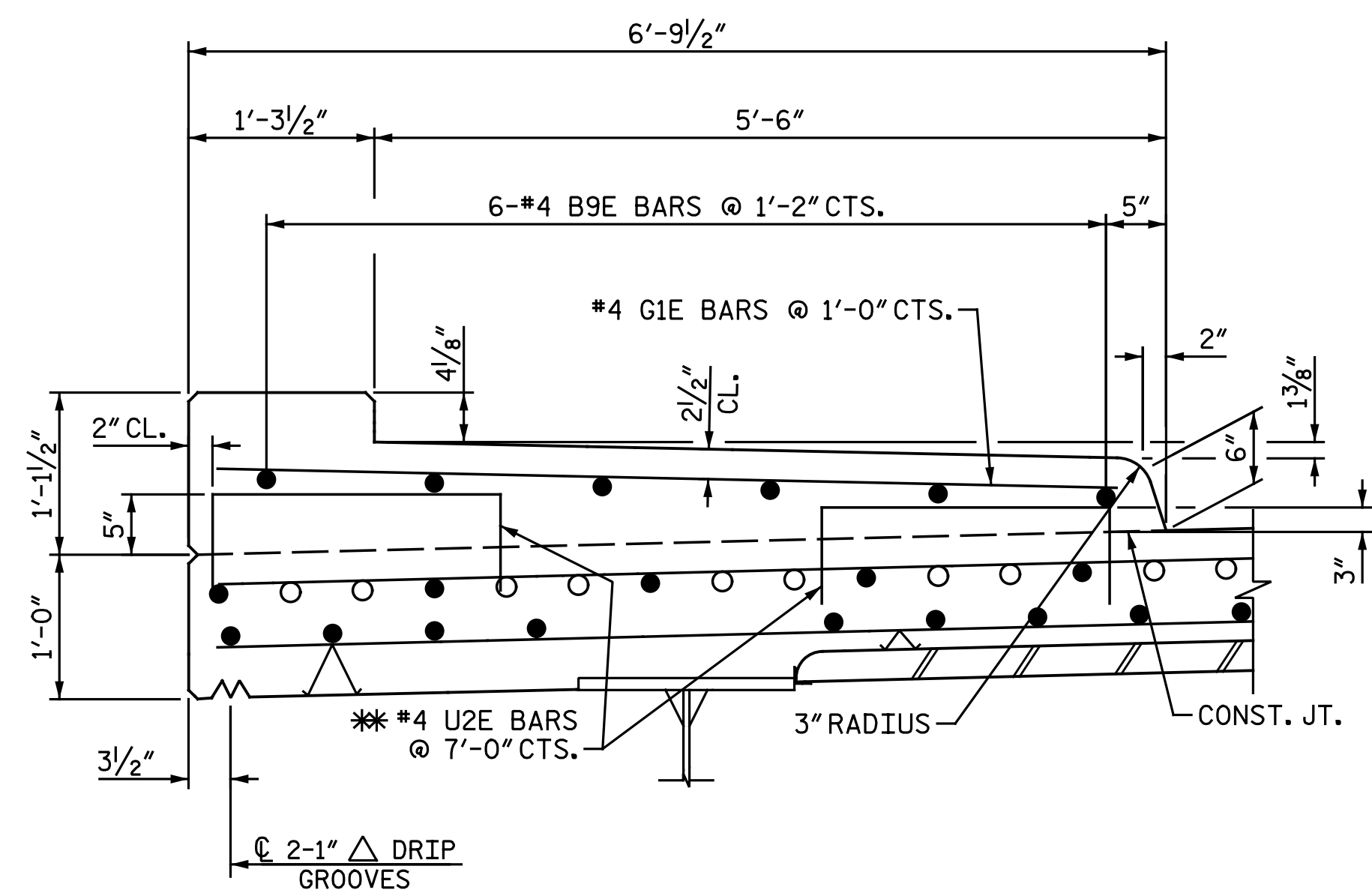

SECTION THRU SIDEWALK

**U2E BARS MAY BE PUSHED INTO GREEN CONCRETE AFTER SPAN HAS BEEN SCREEDED OFF.

NOTES:

FOR END POST DETAILS AND REINFORCING STEEL, SEE "RAIL POST SPACINGS AND END OF RAIL DETAILS" SHEET.

SIDEWALK IN A CONTINUOUS UNIT SHALL NOT BE CAST UNTIL ALL SLAB CONCRETE IN THE UNIT HAS BEEN CAST AND HAS REACHED A MINIMUM COMPRESSIVE STRENGTH OF 3,000 PSI.

ALL REINFORCING STEEL IN SIDEWALKS SHALL BE EPOXY COATED.

SIDEWALK REINFORCING STEEL AND CONCRETE ON BRIDGE SHALL BE INCLUDED IN THE PAY ITEM FOR THE "REINFORCED CONCRETE DECK SLAB".

GROOVED CONTRACTION JOINTS 1/2" IN DEPTH, SHALL BE TOOLED IN ALL EXPOSED FACES OF THE SIDEWALK IN ACCORDANCE WITH ARTICLE 825-10(B) OF THE STANDARD SPECIFICATIONS. THE CONTRACTION JOINTS SHALL BE LOCATED AT EACH CENTERLINE RAIL POST LOCATION. NO CONTRACTION JOINTS WILL BE REQUIRED IN THE SHORT PARAPET SECTION OF THE SIDEWALK.

PROJECT NO. U-3330
NASH COUNTY
 STATION: 18+22.61 -Y1-

DRAWN BY : M. D. MAYHEW DATE : 9-2-16
 CHECKED BY : J. M. GARRISON DATE : 9-6-16

DOCUMENT NOT CONSIDERED FINAL UNLESS ALL SIGNATURES COMPLETED		STATE OF NORTH CAROLINA DEPARTMENT OF TRANSPORTATION RALEIGH SUPERSTRUCTURE SIDEWALK DETAILS LEFT LANES		SHEET NO. SI-23																	
	DocuSigned by: Bradley J. Bell CA1A3F8EC3A3434 1/27/2017	Michael Baker Engineering 8000 Regency Parkway, Suite 600 Cary, North Carolina 27518 NC License No.: F-1084		TOTAL SHEETS 38																	
	Michael Baker INTERNATIONAL	REVISIONS <table border="1" style="width: 100%;"> <thead> <tr> <th>NO.</th> <th>BY:</th> <th>DATE:</th> <th>NO.</th> <th>BY:</th> <th>DATE:</th> </tr> </thead> <tbody> <tr> <td>1</td> <td></td> <td></td> <td>3</td> <td></td> <td></td> </tr> <tr> <td>2</td> <td></td> <td></td> <td>4</td> <td></td> <td></td> </tr> </tbody> </table>		NO.	BY:	DATE:	NO.	BY:	DATE:	1			3			2			4		
NO.	BY:	DATE:	NO.	BY:	DATE:																
1			3																		
2			4																		