

SECTION ALONG GRADE LINE (LEFT LANE)

(BENTS ON SECTION AT RIGHT ANGLES TO BENTS)
(SOME EXISTING SUBSTRUCTURE UNITS NOT SHOWN FOR CLARITY)

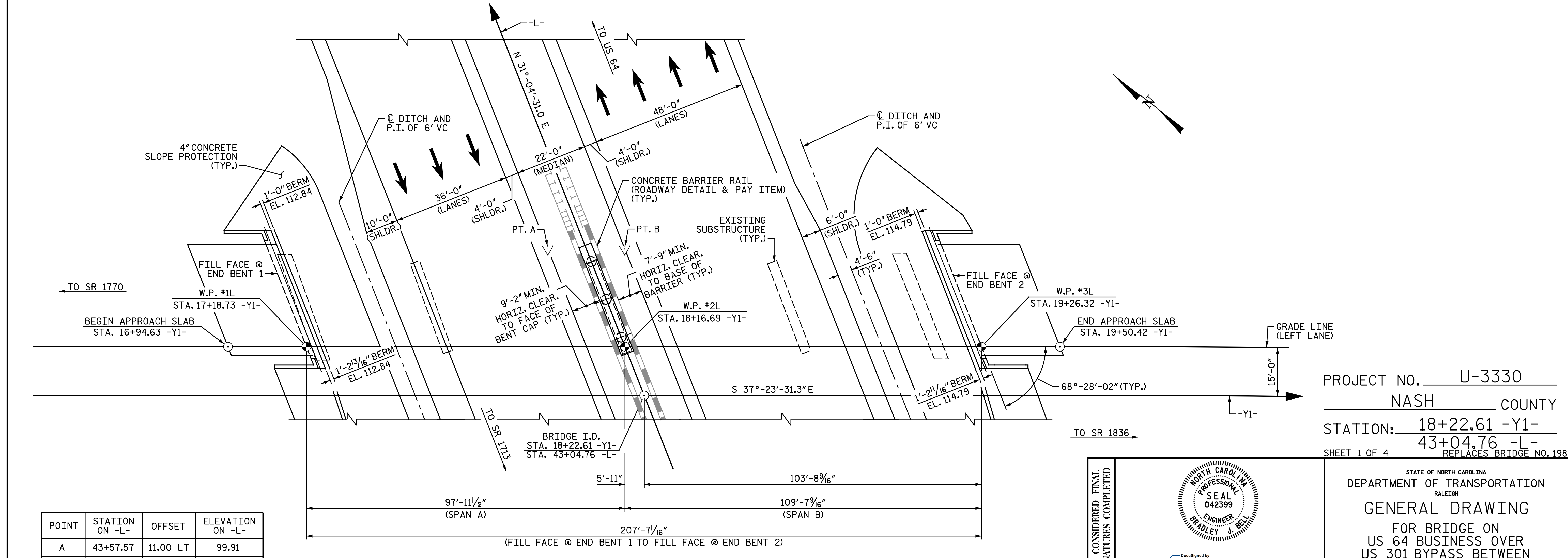

PLAN

(PILES NOT SHOWN IN PLAN VIEW FOR CLARITY)
(SOME EXISTING SUBSTRUCTURE UNITS NOT SHOWN FOR CLARITY)

POINT	STATION ON -L-	OFFSET	ELEVATION ON -L-
A	43+57.57	11.00 LT	99.91
B	43+48.89	11.00 RT	99.94

▽ - DENOTES POINT OF MINIMUM VERTICAL CLEARANCE

DRAWN BY: CEM / MDM DATE: 8-2-16
CHECKED BY: B. J. BELL DATE: 9-7-16

PROJECT NO. U-3330
NASH COUNTY
STATION: 18+22.61 -Y1-
43+04.76 -L-
SHEET 1 OF 4 REPLACES BRIDGE NO. 198

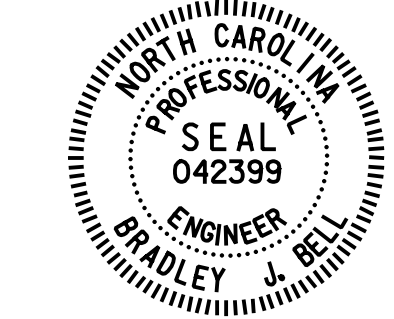

DocuSigned by:
Bradley J. Bell
1/27/2017

Michael Baker
INTERNATIONAL

Michael Baker Engineering
8000 Regency Parkway, Suite 600
Cary, North Carolina 27518
NC License No.: F-1084

STATE OF NORTH CAROLINA
DEPARTMENT OF TRANSPORTATION
RALEIGH
GENERAL DRAWING
FOR BRIDGE ON
US 64 BUSINESS OVER
US 301 BYPASS BETWEEN
SR 1770 & SR 1836
LEFT LANES

REVISIONS						SHEET NO.
NO.	BY:	DATE:	NO.	BY:	DATE:	SI-1
1			3			TOTAL SHEETS
2			4			38