

-Y3RPB-		
PIs Sta 10+60.00	PI Sta 12+68.57	PI Sta 16+13.10
$\Theta_s = 2^\circ 04' 45.4''$	$\Delta = 16^\circ 23' 21.1''$ (LT)	$\Delta = 19^\circ 53' 57.1''$ (LT)
$L_s = 90.00'$	$D = 4^\circ 37' 14.3''$	$D = 5^\circ 58' 05.9''$
$LT = 60.00'$	$L = 354.70'$	$L = 333.41'$
$ST = 30.00'$	$T = 178.57'$	$T = 168.40'$
	$R = 1,240.00'$	$R = 960.00'$
	$SUPER = 0.045$	

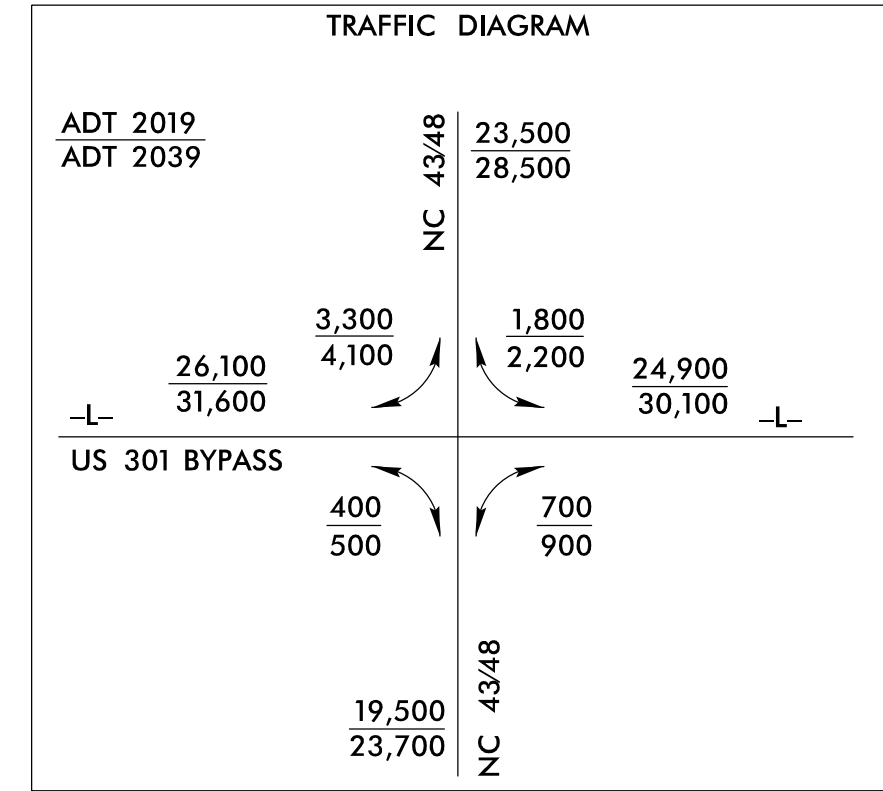

PROJECT REFERENCE NO. U-3330	SHEET NO. EC-21/CONST.11
RW SHEET NO.	
ROADWAY DESIGN ENGINEER	HYDRAULICS ENGINEER

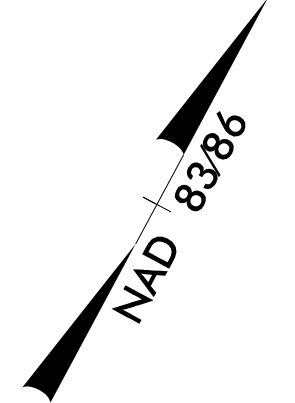

MATCHLINE -L- STA. 119+00 SEE SHEET 10

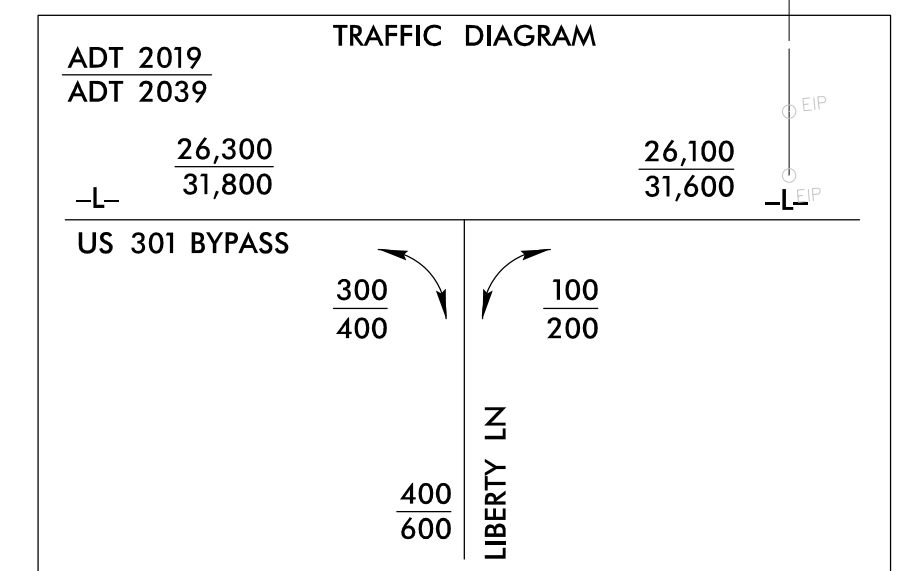
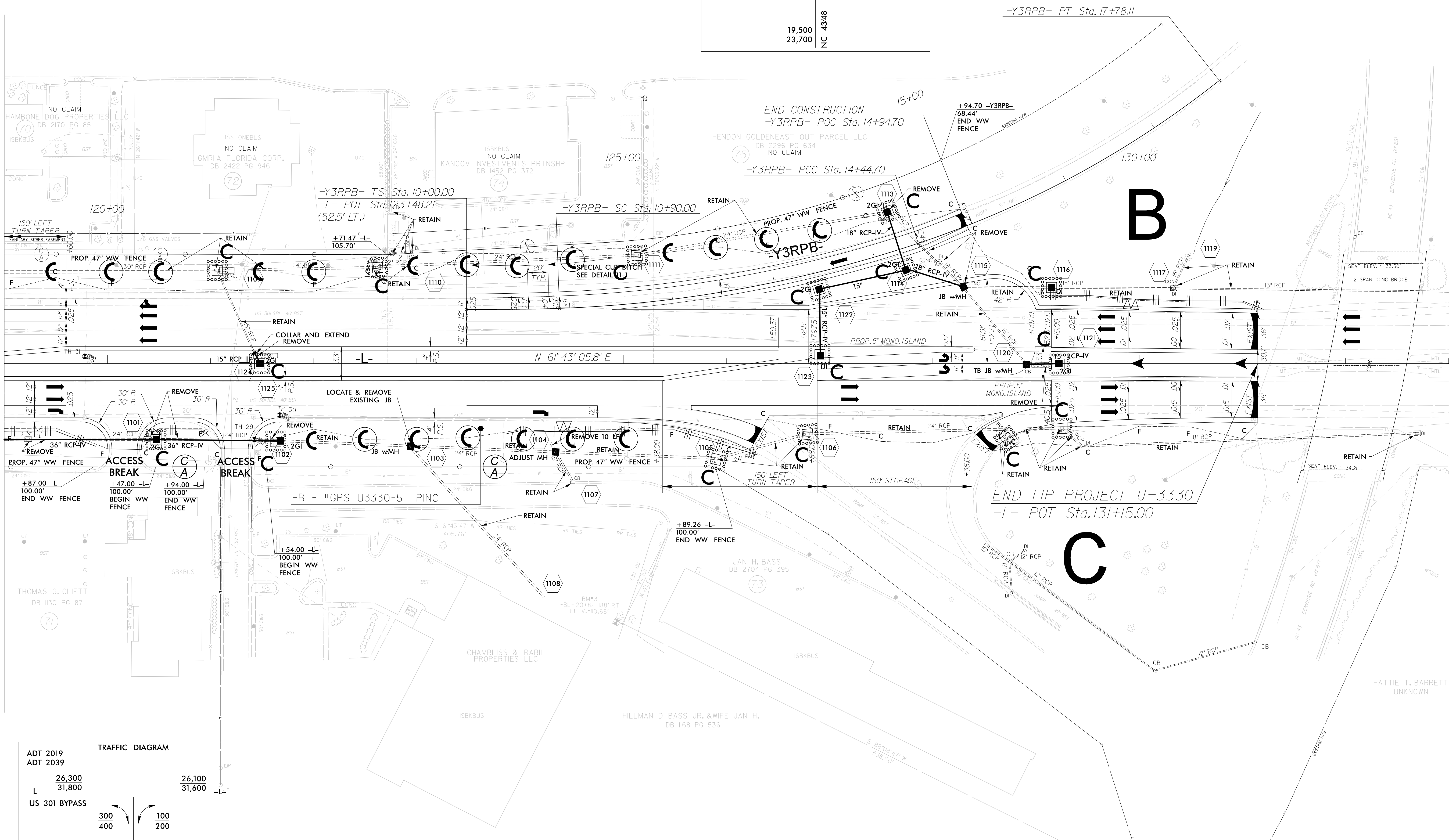

DRIVEWAY RADII ARE 25' UNLESS OTHERWISE NOTED

FOR -L- PROFILE SEE SHT.18 & 19
FOR -Y3RPB- PROFILE SEE SHT.22
FOR DITCH DETAILS SEE SHT.2-F

