

PROJECT REFERENCE NO.	SHEET NO.
U-3330	EC-08/CONST.08
RW SHEET NO.	
ROADWAY DESIGN ENGINEER	HYDRAULICS ENGINEER

-Y2RPA-	-Y2RPA-	-Y2RPA-	-L-	-L-	-L-
Pls Sta 13+22.59 Δs = 8° 0' 17.1" Ls = 140.00' LT = 93.43' ST = 46.75'	Pls Sta 14+75.37 Δ = 23° 59' 04.2" (RT) D = 11° 27' 33.0" L = 209.30' T = 106.21' R = 500.00' SUPER = EXIST.	Pls Sta 16+25.22 Δs = 8° 0' 17.1" Ls = 140.00' LT = 93.43' ST = 46.75'	Pls Sta 77+22.10 Δs = 1° 07' 29.7" Ls = 150.00' LT = 100.00' ST = 50.00'	Pls Sta 87+38.46 Δ = 28° 23' 35.4" (RT) D = 1° 29' 59.6" L = 1,893.02' T = 966.37' R = 3,820.00' SUPER = 0.03 RO = 150.00'	Pls Sta 97+15.11 Δs = 1° 07' 29.7" Ls = 150.00' LT = 100.00' ST = 50.00'

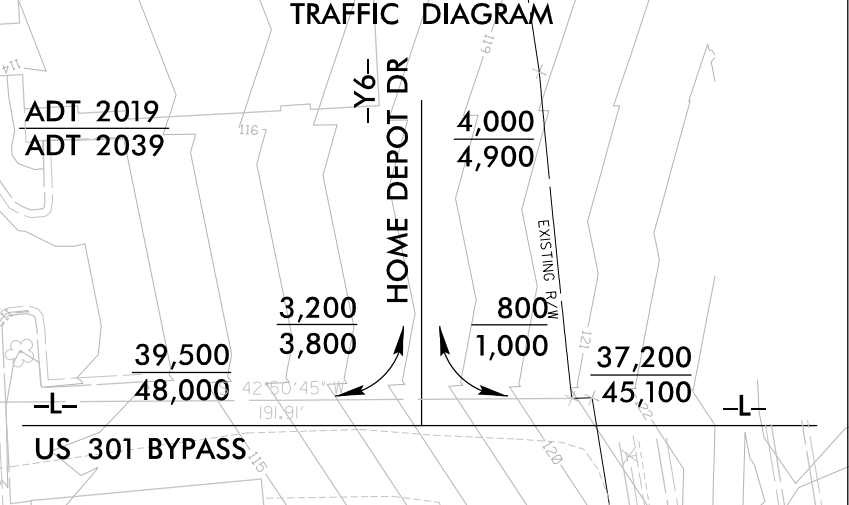

CLEARING AND GRUBBING EROSION CONTROL FOR CONSTRUCTION SHEET 08

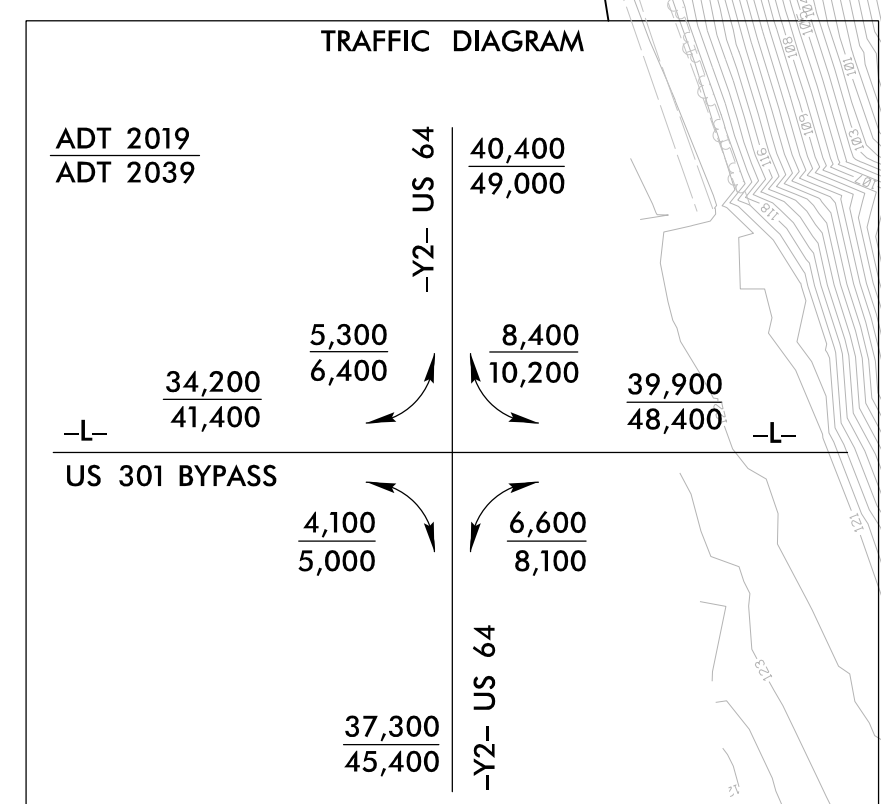
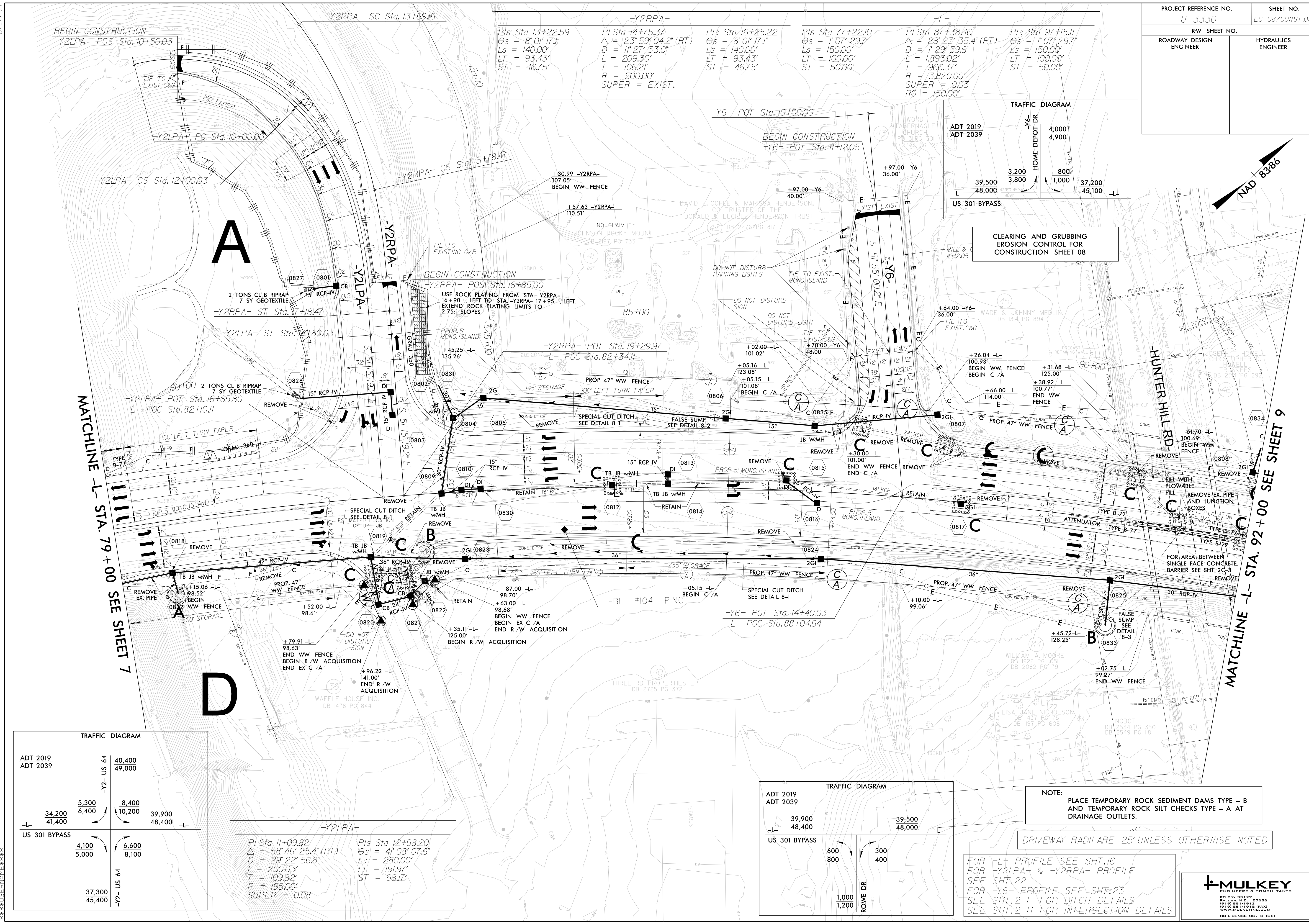

-Y2LPA-	-Y2LPA-
Pls Sta 11+09.82 Δ = 58° 46' 25.4" (RT) D = 29° 22' 56.8" L = 200.03' T = 109.82' R = 195.00' SUPER = 0.08	Pls Sta 12+98.20 Δs = 41° 08' 07.6" Ls = 280.00' LT = 191.97' ST = 98.17'

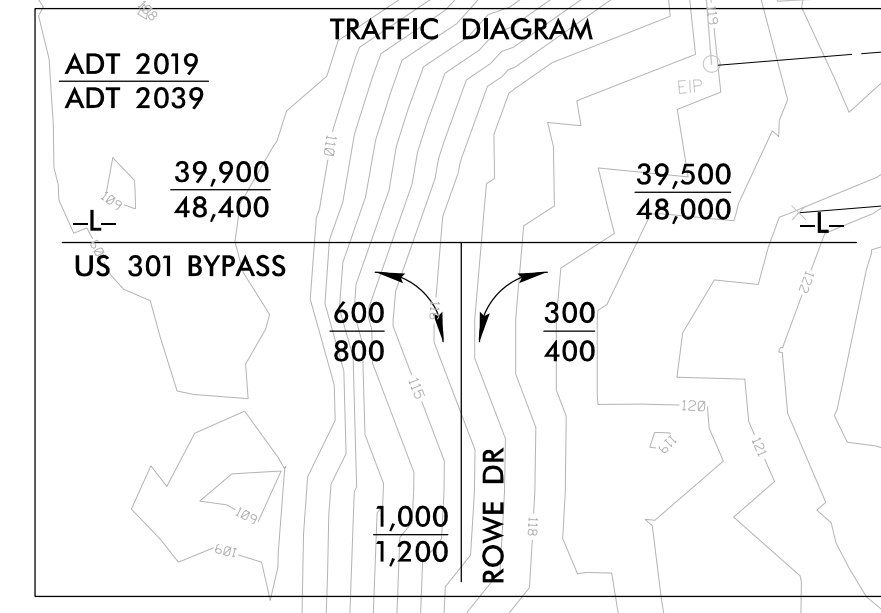

NOTE: PLACE TEMPORARY ROCK SEDIMENT DAMS TYPE - B AND TEMPORARY ROCK SILT CHECKS TYPE - A AT DRAINAGE OUTLETS.

DRIVEWAY RADII ARE 25' UNLESS OTHERWISE NOTED

FOR -L- PROFILE SEE SHT.16
FOR -Y2LPA- & -Y2RPA- PROFILE SEE SHT.22
FOR -Y6- PROFILE SEE SHT.23
SEE SHT.2-F FOR DITCH DETAILS
SEE SHT.2-H FOR INTERSECTION DETAILS



8.17.799