

- ANGLES**
- ① 117°-07'-22"
  - ② 120°-00'-00"
  - ③ 122°-43'-14"
  - ④ 121°-42'-31"
  - ⑤ 120°-43'-05"
  - ⑥ 120°-00'-07"
  - ⑦ 119°-07'-37"
  - ⑧ 118°-06'-55"
  - ⑨ 28°-12'-45"
  - ⑩ 116°-24'-23"
  - ⑪ 119°-07'-30"

**NOTES**

ASSUMED LIVE LOAD = HS 20-44 OR ALTERNATE LOADING.  
 FOR OTHER DESIGN DATA AND GENERAL NOTES, SEE SHEET S-N.  
 COMPUTED FOUNDATION LOAD FOR END BENT NO. 1 EQUALS 3.0 TONS PER SQ. FOOT.  
 PILES FOR BENT NO. 1, BENT NO. 2, AND END BENT #2 TO BE DRIVEN TO A MINIMUM BEARING CAPACITY OF 45 TONS EACH.  
 FOR CURING BRIDGE DECK SLABS, SEE SPECIAL PROVISION, "REINFORCED CONCRETE DECK SLAB".  
 ALL REINFORCING STEEL SHALL BE GRADE 60.  
 AFTER SERVING AS A TEMPORARY CROSSING, THE EXISTING STRUCTURE (BRIDGE NO. 215) CONSISTING OF 3 R.C.D.G. SPANS (1@ 36'-9", 1@ 42'-6", 1@ 41'-9") WITH CONCRETE AND 3" B.S.T. WEARING SURFACE FLOOR AND 18" CLEAR ROADWAY WIDTH ON CONCRETE ABUTMENTS AND PIERS LOCATED 100' DOWNSTREAM FROM THE PROPOSED STRUCTURE, SHALL BE REMOVED.  
 FOR EPOXY PROTECTIVE COATING, SEE SPECIAL PROVISIONS.  
 THE MATERIAL SHOWN IN THE CROSS-HATCHED AREA SHALL BE EXCAVATED FOR A DISTANCE OF 32 FT. EACH SIDE OF CENTER LINE ROADWAY AS DIRECTED BY THE ENGINEER. NO PAYMENT WILL BE MADE FOR THIS EXCAVATION AS SUCH EXCAVATION IS CONSIDERED INCIDENTAL IN THE CONSTRUCTION OF THE END BENT CAP AND THE BERM.  
 THE EXISTING BRIDGE IS PRESENTLY POSTED BELOW THE LEGAL LOAD LIMIT. SHOULD THE STRUCTURAL INTEGRITY OF THE BRIDGE FURTHER DETERIORATE THIS LOAD LIMITATION MAY BE REDUCED AS FOUND NECESSARY DURING THE LIFE OF THE PROJECT.  
 FOR REINFORCED CONCRETE DECK SLAB, SEE SPECIAL PROVISIONS.  
 FOR FABRICATED METAL STAY-IN-PLACE FORMS, SEE SPECIAL PROVISIONS.  
 FOR PRESTRESSED CONCRETE PANELS, SEE SPECIAL PROVISIONS.

B.M. - R.R. SPIKE IN BASE OF 24" POPLAR 33' RT. OF STA. 14+15 -Y- EL. 252.92. DATUM: M.S.L.

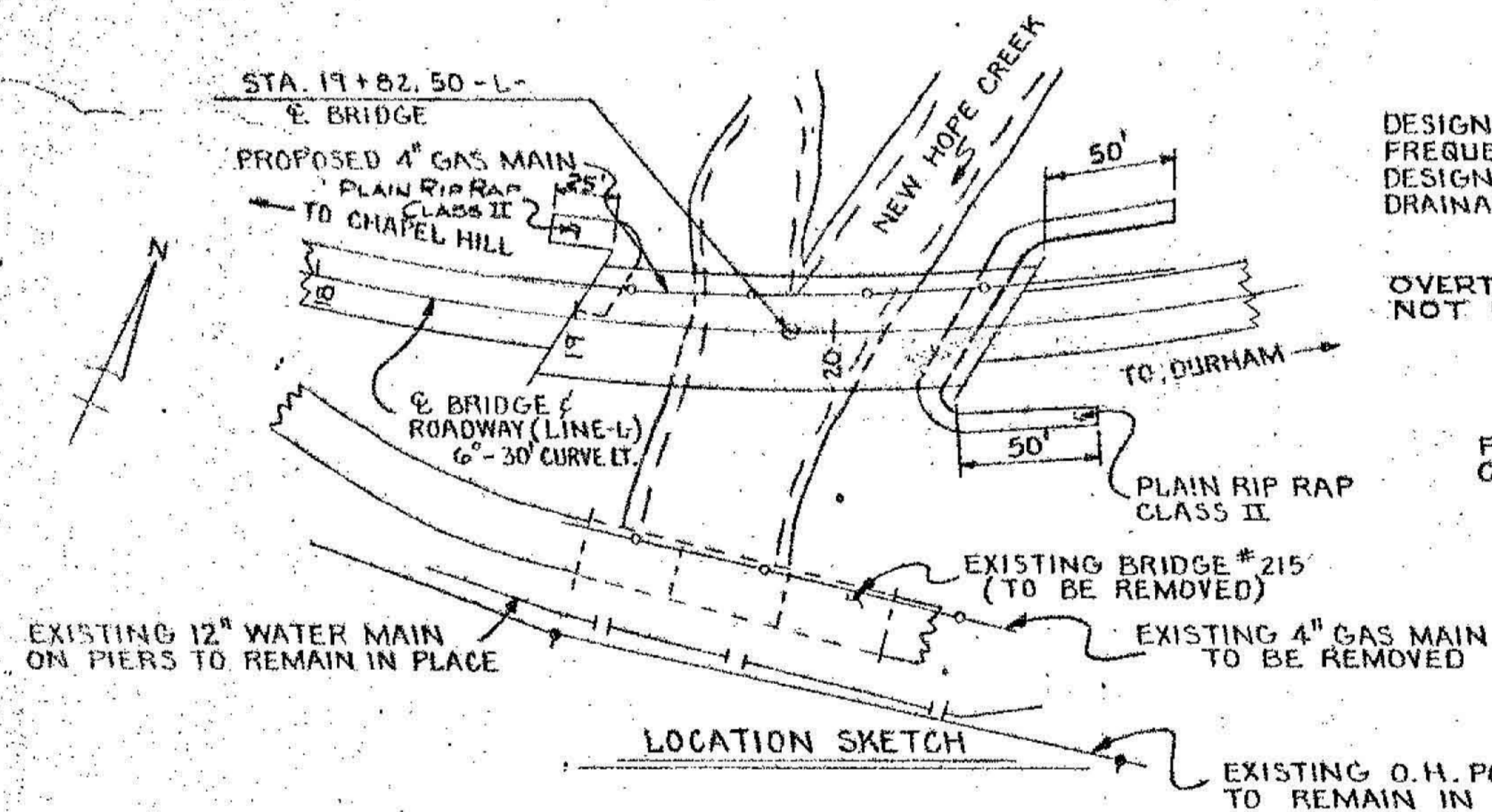

DESIGN DISCHARGE = 12,100 C.F.S.  
 FREQUENCY OF DESIGN FLOOD = 100 YRS.  
 DESIGN HIGH WATER EL. = 248.0  
 DRAINAGE AREA = 52.2 SQ. MILES

OVERTOPPING FLOOD DATA NOT REQUIRED.

FOR ADJUSTMENT OF UTILITY CONFLICTS, SEE SPECIAL PROVISIONS.

**FOR INFORMATION ONLY**

DRAWING C11 OF 24

PROJECT No. 8.2522503

DURHAM COUNTY

STATION: 19+82.50-L

SHEET 2 OF 2

TOTAL BILL OF MATERIAL																	
	PREFORMED COMPRESSION JOINT SEAL	REMOVAL OF EXISTING STRUCTURE	FOUNDATION EXCAVATION	FOUNDATION EXCAVATION FOR BENTS	REINFORCED CONCRETE DECK SLAB	CLASS A CONCRETE	REINFORCING STEEL	SPIRAL COLUMN REINFORCING STEEL	45" PRESTRESSED CONCRETE GIRDERS	HP 12 x 53 STEEL PILES	CONCRETE BARRIER RAIL	LINSEED OIL CONC. PROTECTION	BRIDGE APPROACH SLABS	ELASTOMERIC BEARINGS	PLAIN RIP RAP CLASS II		
	LUMP SUM	LUMP SUM	CU. YDS.	LUMP SUM	SQ. FT.	CU. YDS.	LBS.	LBS.	NO.	LIN. FT.	NO.	LIN. FT.	LIN. FT.	GALS.	LUMP SUM	LUMP SUM	SQ. YDS.
SUPERSTRUCTURE					7119												
END BENT #1			65			30.2	4,191										265
BENT #1						39.0	7,412	1,054					13	195			
BENT #2						40.0	7,904	1,104					13	195			
END BENT #2						17.4	3,953						10	350			575
CURVED END BLOCK						2.9	593										
<b>TOTAL</b>	<b>LUMP SUM</b>	<b>LUMP SUM</b>	<b>65</b>	<b>LUMP SUM</b>	<b>7119</b>	<b>129.5</b>	<b>24,053</b>	<b>2,158</b>	<b>18</b>	<b>984.00</b>	<b>36</b>	<b>740</b>	<b>336.82</b>	<b>17</b>	<b>LUMP SUM</b>	<b>LUMP SUM</b>	<b>840</b>

DRAWN BY G. DEMENT DATE FEB-1977  
 CHECKED BY K. BRIGGEN DATE APR. 1977

STATE OF NORTH CAROLINA  
 DEPARTMENT OF TRANSPORTATION  
 RALEIGH  
 GENERAL DRAWING FOR BRIDGE OVER NEW HOPE CREEK ON SR 2720 BETWEEN CHAPEL HILL AND DURHAM  
 FEB. 1977

REVISIONS				SHEET NO.	
NO.	BY	DATE	NO.	BY	DATE
1			2		
2			3		
			4		

TOTAL SHEETS 23