

USP: Enter Up Stream Protection, Location, Device Type, and Facility ID of the Blocking Device
 W2S: Remember "Your Circle of Safety"

PROJECT REFERENCE NO. EB-4707		SHEET NO. 10	
RW SHEET NO.			
ROADWAY DESIGN ENGINEER		HYDRAULICS ENGINEER	
Kimley-Horn and Associates, Inc. P.O. BOX 33068 RALEIGH, N.C. 27636-3068			
RIGHT-OF-WAY REV.		CONST. REV.	

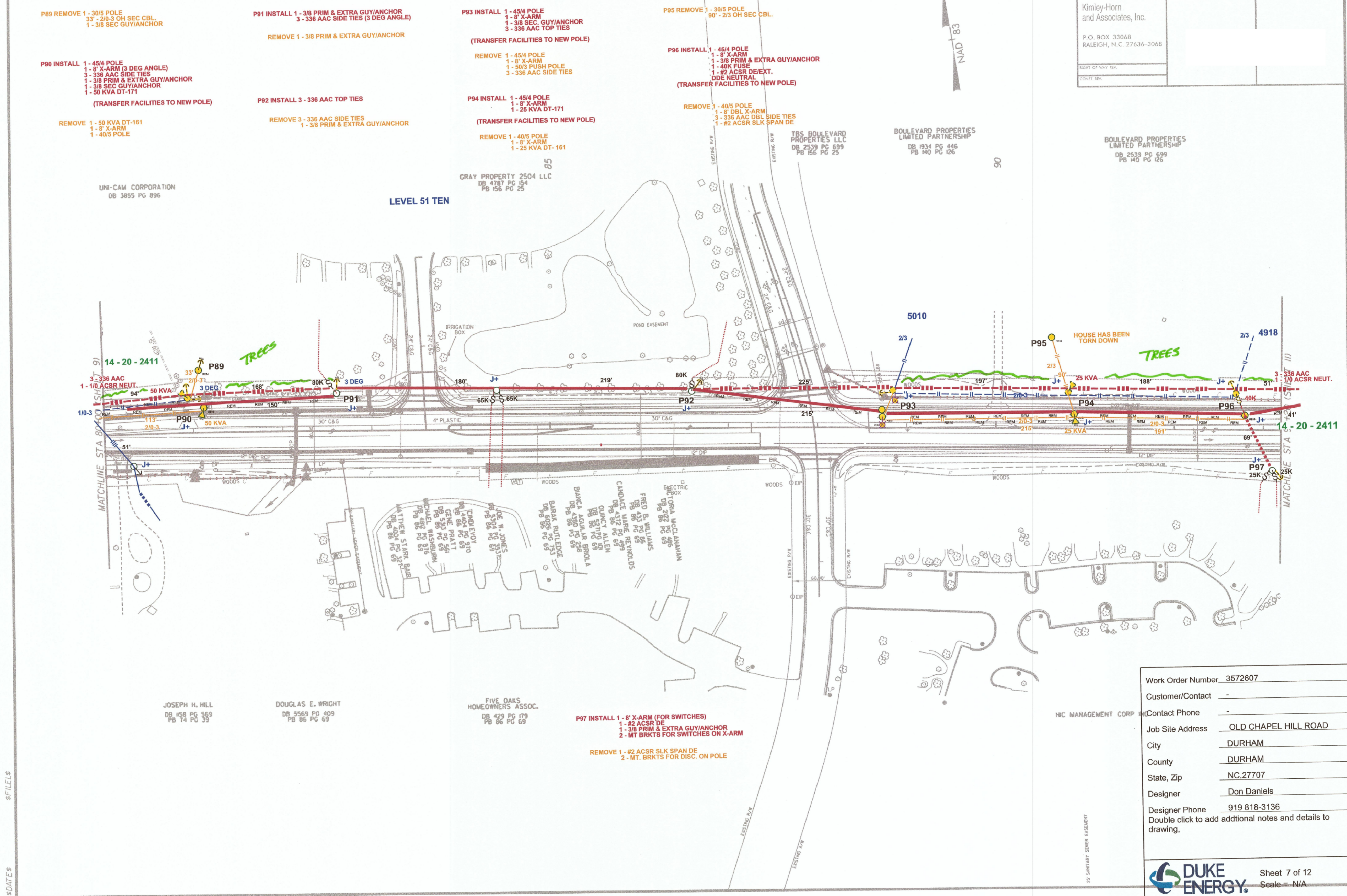

P89 REMOVE 1 - 30/5 POLE
 1 - 8' X-ARM (3 DEG ANGLE)
 33' - 2/0-3 OH SEC CBL
 1 - 3/8 SEC GUY/ANCHOR

P90 INSTALL 1 - 45/4 POLE
 1 - 8' X-ARM (3 DEG ANGLE)
 3 - 336 AAC SIDE TIES
 1 - 3/8 PRIM & EXTRA GUY/ANCHOR
 1 - 3/8 SEC GUY/ANCHOR
 1 - 50 KVA DT-171
 (TRANSFER FACILITIES TO NEW POLE)

REMOVE 1 - 50 KVA DT-161
 1 - 8' X-ARM
 1 - 40/5 POLE

P91 INSTALL 1 - 3/8 PRIM & EXTRA GUY/ANCHOR
 3 - 336 AAC SIDE TIES (3 DEG ANGLE)

REMOVE 1 - 3/8 PRIM & EXTRA GUY/ANCHOR

P92 INSTALL 3 - 336 AAC TOP TIES

REMOVE 3 - 336 AAC SIDE TIES
 1 - 3/8 PRIM & EXTRA GUY/ANCHOR

P93 INSTALL 1 - 45/4 POLE
 1 - 8' X-ARM
 1 - 3/8 SEC. GUY/ANCHOR
 3 - 336 AAC TOP TIES
 (TRANSFER FACILITIES TO NEW POLE)

REMOVE 1 - 45/4 POLE
 1 - 8' X-ARM
 1 - 50/3 PUSH POLE
 3 - 336 AAC SIDE TIES

P94 INSTALL 1 - 45/4 POLE
 1 - 8' X-ARM
 1 - 25 KVA DT-171
 (TRANSFER FACILITIES TO NEW POLE)

REMOVE 1 - 40/5 POLE
 1 - 8' X-ARM
 1 - 25 KVA DT-161

P95 REMOVE 1 - 30/5 POLE
 90' - 2/3 OH SEC CBL.

P96 INSTALL 1 - 45/4 POLE
 1 - 8' X-ARM
 1 - 3/8 PRIM & EXTRA GUY/ANCHOR
 1 - 40K FUSE
 1 - #2 ACSR DE/EXT.
 DDE NEUTRAL
 (TRANSFER FACILITIES TO NEW POLE)

REMOVE 1 - 40/5 POLE
 1 - 8' DBL X-ARM
 3 - 336 AAC DBL SIDE TIES
 1 - #2 ACSR SLK SPAN DE

P97 INSTALL 1 - 8' X-ARM (FOR SWITCHES)
 1 - #2 ACSR DE
 1 - 3/8 PRIM & EXTRA GUY/ANCHOR
 2 - MT BRKTS FOR SWITCHES ON X-ARM

REMOVE 1 - #2 ACSR SLK SPAN DE
 2 - MT. BRKTS FOR DISC. ON POLE

Work Order Number	3572607
Customer/Contact	-
Contact Phone	-
Job Site Address	OLD CHAPEL HILL ROAD
City	DURHAM
County	DURHAM
State, Zip	NC.27707
Designer	Don Daniels
Designer Phone	919 818-3136
Double click to add additional notes and details to drawing.	