

# EXISTING SIGNING PLAN

SEE SHEET NO. SIGN-24 FOR PROPOSED SIGNING PLAN

**Kimley»Horn**

P.O. BOX 33068  
RALEIGH, N.C. 27636-3068

RIGHT-OF-WAY REV.  
CONST. REV.

PROJECT REFERENCE NO. EB-4707B	SHEET NO. SIGN-12
RW SHEET NO.	
ROADWAY DESIGN ENGINEER	
DocuSigned by: Matt West ACT1A1D079B8425... 1/30/2017	
<b>DOCUMENT NOT CONSIDERED FINAL UNLESS ALL SIGNATURES COMPLETED</b>	

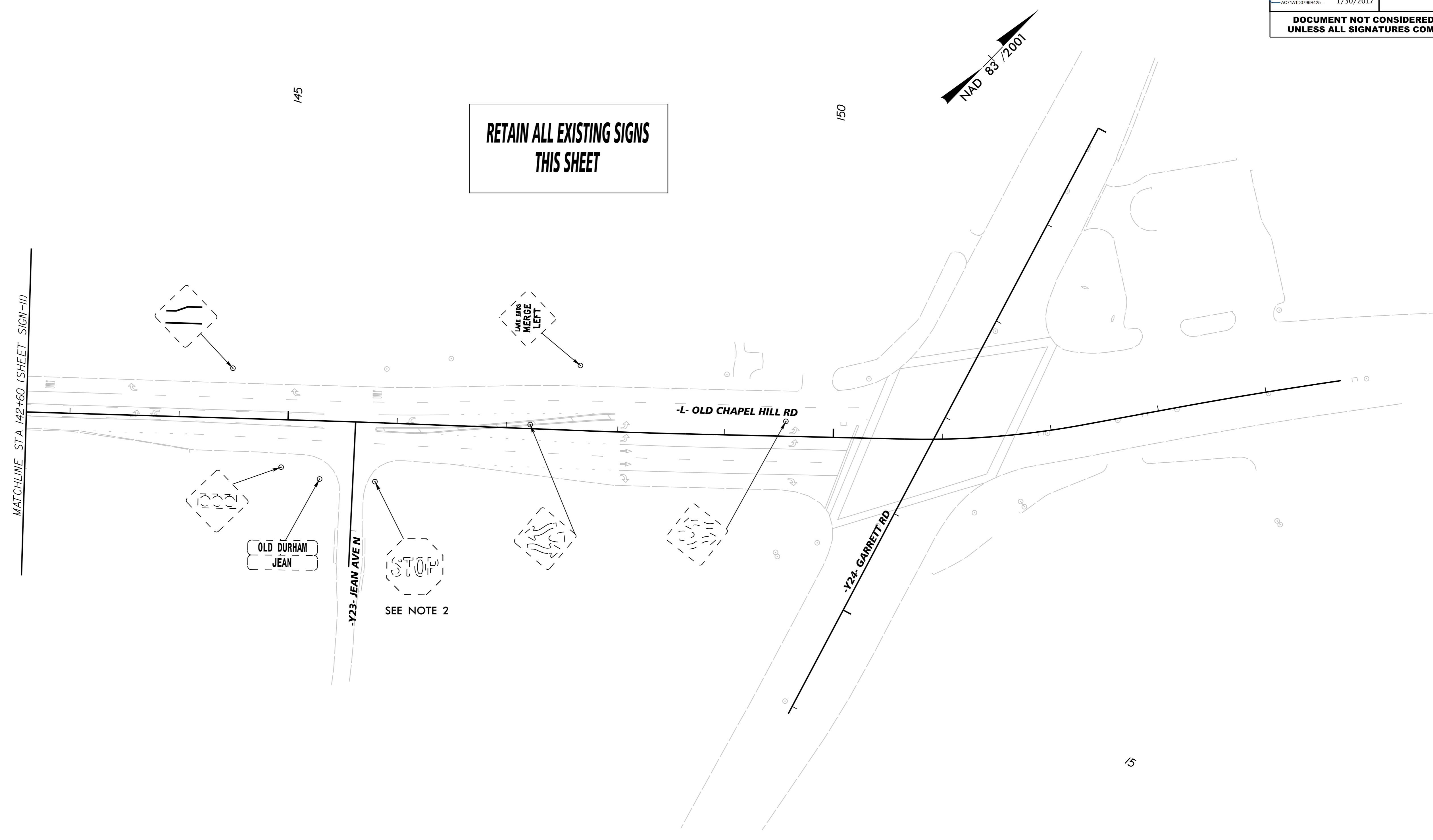

RETAIN ALL EXISTING SIGNS  
THIS SHEET

- PAY ITEM NOTES:**
1. RELOCATE EXISTING TYPE E SIGN.
  2. REMOVE AND DISPOSE OF EXISTING SIGN SYSTEM, "U" CHANNEL.

1/30/2017 \$ FILE \$