

SUPERSTRUCTURE REINFORCING STEEL LENGTHS ARE BASED ON THE FOLLOWING MINIMUM SPLICE LENGTHS

BAR SIZE	SUPERSTRUCTURE EXCEPT APPROACH SLABS, PARAPET, AND BARRIER RAIL		APPROACH SLABS		PARAPET AND BARRIER RAIL
	EPOXY COATED	UNCOATED	EPOXY COATED	UNCOATED	
#4	2'-0"	1'-9"	2'-0"	1'-9"	2'-9"
#5	2'-6"	2'-2"	2'-6"	2'-2"	3'-5"
#6	3'-0"	2'-7"	3'-10"	2'-7"	4'-4"
#7	5'-3"	3'-6"			
#8	6'-10"	4'-7"			

GROOVING BRIDGE FLOORS

APPROACH SLABS	1,850 SQ.FT.
BRIDGE DECK	4,480 SQ.FT.
TOTAL	6,330 SQ.FT.

SUPERSTRUCTURE BILL OF MATERIAL

	CLASS AA CONCRETE	CLASS A CONCRETE	*EPOXY COATED STEEL REINFORCING	STEEL REINFORCING
	(CU. YDS.)	(CU. YDS.)	(LBS.)	(LBS.)
SPAN A				
POUR 1	147.4			
POUR 2	68.4			
POUR 3		16.6		
TOTAL**	215.8	16.6	16,329	20,319

- ** QUANTITIES FOR CONCRETE BARRIER RAIL ARE NOT INCLUDED
- POUR 2 INCLUDES CONCRETE FOR SUPERSTRUCTURE PORTION OF INTEGRAL END BENT. ALL COSTS ASSOCIATED WITH THE SUPERSTRUCTURE PORTION OF THE INTEGRAL END BENT, INCLUDING BUT NOT LIMITED TO, MATERIALS, LABOR AND ALL INCIDENTALS SHALL BE INCLUDED IN THE CONTRACT BID PRICE FOR REINFORCED CONCRETE DECK SLAB. NO ADDITIONAL PAYMENT WILL BE MADE.
- POUR 3 INCLUDES CONCRETE FOR SUPERSTRUCTURE PORTION OF WING WALLS. ALL COSTS ASSOCIATED WITH THE SUPERSTRUCTURE PORTION OF THE WING WALLS, INCLUDING BUT NOT LIMITED TO, MATERIALS, LABOR AND ALL INCIDENTALS SHALL BE INCLUDED IN THE CONTRACT BID PRICE FOR REINFORCED CONCRETE DECK SLAB. NO ADDITIONAL PAYMENT WILL BE MADE.

REINFORCING BAR SCHEDULE

MARK	NO.	SIZE	TYPE	LENGTH	WEIGHT
*A1	194	#5	STR	42'-10"	8,667
A2	194	#5	STR	42'-10"	8,667
*B1	150	#4	STR	25'-9"	2,580
*B2	54	#6	STR	27'-6"	2,230
*B3	54	#6	STR	24'-6"	1,987
B4	34	#5	STR	41'-9"	1,481
B5	68	#6	STR	41'-9"	4,264
H1	54	#7	(3)	16'-4"	1,803
H2	54	#7	(3)	15'-1"	1,665
K1	28	#4	STR	22'-4"	418
K2	40	#4	STR	8'-1"	216
K3	8	#4	STR	6'-6"	35
K4	8	#4	STR	5'-1"	27
K5	20	#4	STR	3'-0"	40
K6	4	#4	STR	2'-2"	6
K7	4	#4	STR	1'-6"	4
K8	58	#4	STR	2'-8"	103
*S1	60	#4	(2)	11'-11"	478
*S2	56	#4	(2)	10'-4"	387
U1	60	#4	(1)	12'-11"	518
U2	8	#4	(1)	8'-11"	48
V1	38	#5	STR	6'-4"	251
V2	38	#5	STR	6'-3"	248
V3	38	#5	STR	6'-8"	264
V4	38	#5	STR	6'-7"	261
*EPOXY COATED REINF. STEEL (LBS.)				16,329	
REINFORCING STEEL (LBS.)				20,319	

BAR TYPES

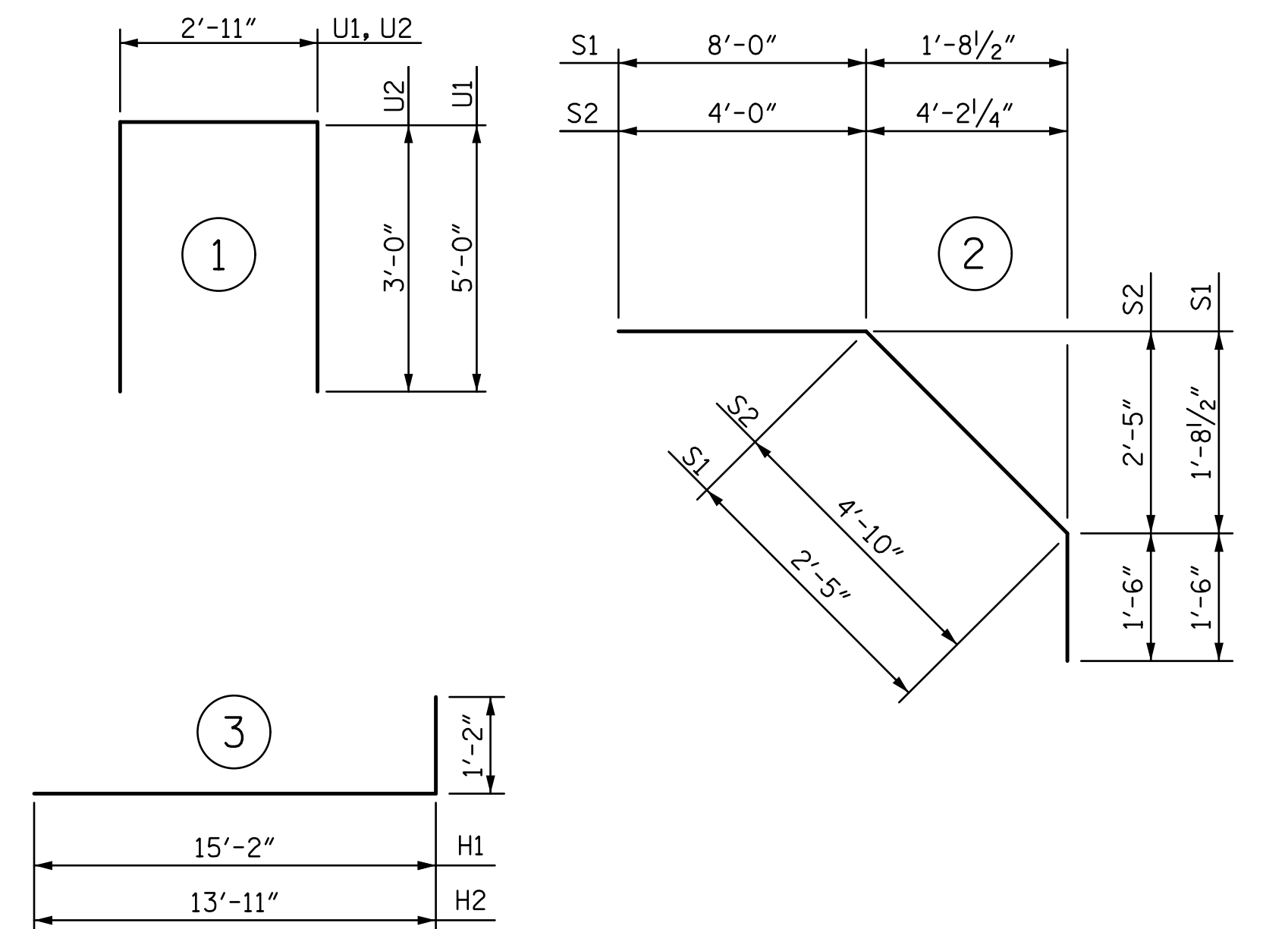

ALL BAR DIMENSIONS ARE OUT TO OUT.

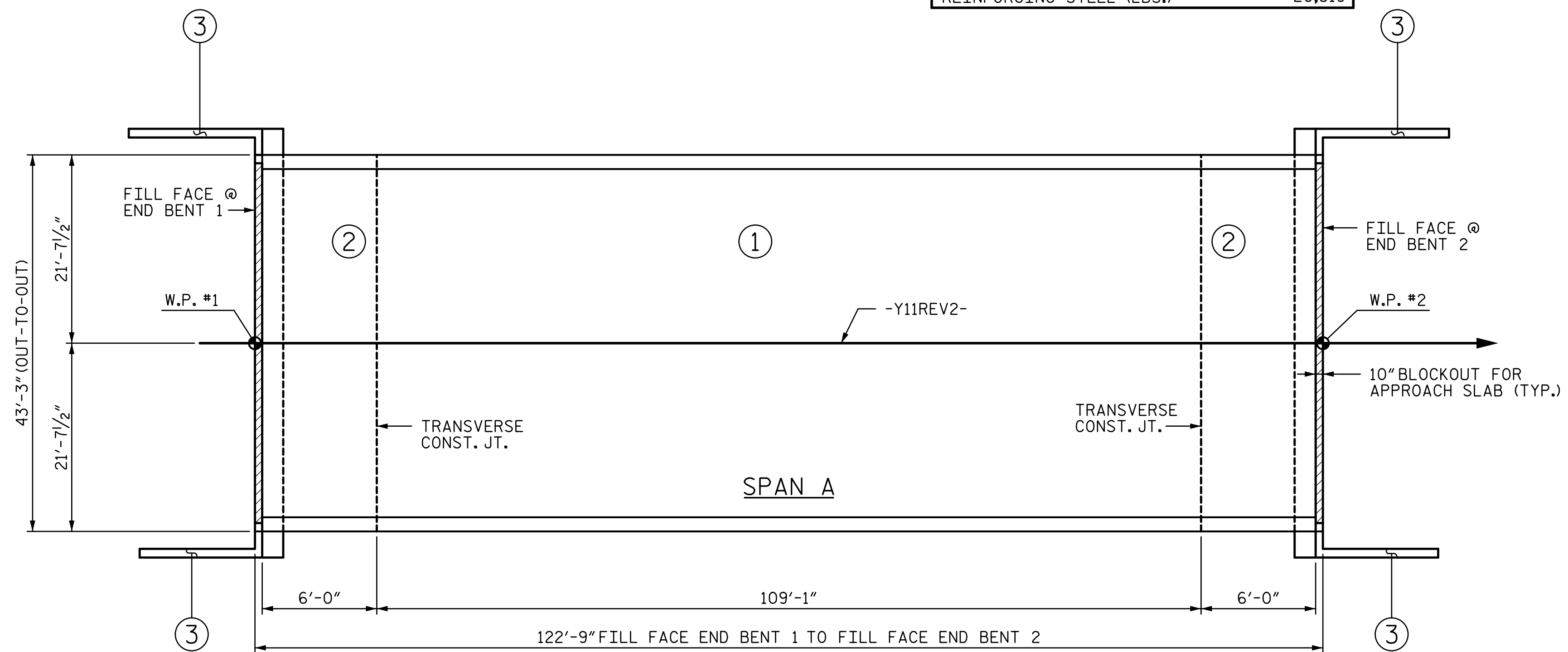

POURING DIAGRAM AND LAYOUT FOR COMPUTING AREA REINFORCED CONCRETE DECK SLAB (SQ. FT. = 5,309)

(#) = INDICATES POUR NUMBER

PROJECT NO. R-2707C
CLEVELAND COUNTY
 STATION: 32+31.41 -Y11REV2-

DOCUMENT NOT CONSIDERED FINAL UNLESS ALL SIGNATURES COMPLETED

DocuSigned by:
Tony R. Laws, Jr.
3/6/2017 12:25:45 PM

STATE OF NORTH CAROLINA
 DEPARTMENT OF TRANSPORTATION
 RALEIGH

**SUPERSTRUCTURE
 BILL OF MATERIAL**

REVISIONS			
NO.	BY:	DATE:	DATE:
1			
2			

SHEET NO.
 S11-19
 TOTAL SHEETS
 27