

**SPAN B GIRDERS ELEVATION**  
(CONNECTOR PLATES AND COMBINATION CONNECTOR/STIFFENER PLATES NOT SHOWN FOR CLARITY. FOR PLACEMENT, SEE "FRAMING PLAN".)

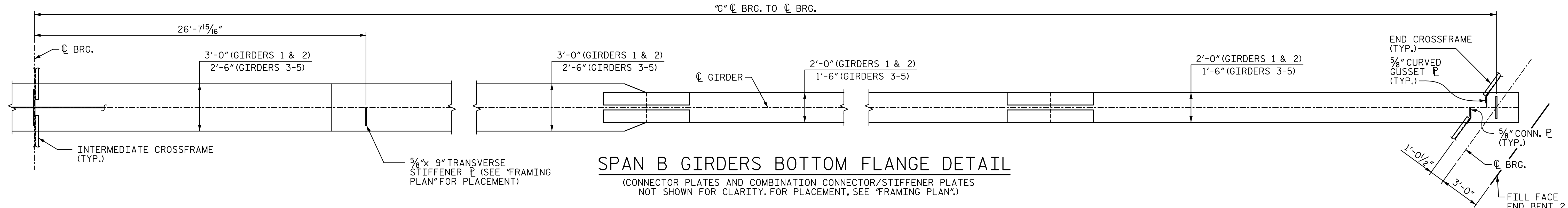

**SPAN B GIRDERS BOTTOM FLANGE DETAIL**  
(CONNECTOR PLATES AND COMBINATION CONNECTOR/STIFFENER PLATES NOT SHOWN FOR CLARITY. FOR PLACEMENT, SEE "FRAMING PLAN".)

- NOTES:**
1. CHARPY V-NOTCH TESTS ARE REQUIRED FOR ALL TOP OR BOTTOM FLANGE PLATES WHICH FALL WITHIN THESE LIMITS, ALL WEB PLATES AND ALL SPLICE PLATES. IF A PERMITTED SHOP FLANGE SPLICE IS NOT USED, CHARPY V-NOTCH TESTS WILL BE REQUIRED FOR THE ENTIRE FLANGE PLATE. FOR CHARPY V-NOTCH TESTS, SEE ARTICLE 1072-7 OF THE STANDARD SPECIFICATIONS.
  2. NO WELDING OF FORMS OR FALSEWORK TO THE TOP FLANGE WILL BE PERMITTED IN THIS REGION.
  3. SEE "GIRDER DIMENSIONS" TABLE ON SHEET 1 OF 8 FOR VARIABLE DIMENSIONS
  4. SEE "SUPERSTRUCTURE STRUCTURAL STEEL BOLTED FIELD SPLICE" SHEETS FOR LOCATIONS & DETAILS OF SHEAR CONNECTORS ON TOP FLANGE SPLICE PLATES.

36" FLANGE	4 1/2"	3 SPA. @ 9"	4 1/2"
30" FLANGE	4 1/2"	3 SPA. @ 7"	4 1/2"
24" FLANGE	3"	3 SPA. @ 6"	3"
18" FLANGE	3"	3 SPA. @ 4"	3"

7"

3/4" Ø x 7" SHEAR CONNECTOR (TYP.)

**SHEAR CONNECTOR DETAIL**  
(TYPICAL EXCEPT @ TOP FLANGE SPLICE PLATE, SEE SHEETS TITLED "STRUCTURAL STEEL BOLTED FIELD SPLICE" FOR DETAILS)

PROJECT NO. **R-2707C**  
**CLEVELAND** COUNTY  
 STATION: **596+50.98 -L-**  
 SHEET 2 OF 8

DOCUMENT NOT CONSIDERED FINAL UNLESS ALL SIGNATURES COMPLETED			STATE OF NORTH CAROLINA DEPARTMENT OF TRANSPORTATION RALEIGH SUPERSTRUCTURE STRUCTURAL STEEL GIRDER ELEVATION SPAN B (SITE 6R)		SHEET NO. S8-14
	DocuSigned by: Tony R. Laws, Jr. CARCE06FB76AF7 12/13/2016		REVISIONS		TOTAL SHEETS 44
	STV 100 Years STV ENGINEERS, INC. 900 West Trade St., Suite 715 Charlotte, NC 28202 NC License Number F-5991	NO. 1 BY: TRL DATE: 10-16	NO. 2 BY: TRL DATE: 10-16	NO. 3 BY: V.WU DATE: 10-16	NO. 4 BY: V.WU DATE: 10-16

R:\408\_027\_R2707C\_SMU\_SSD02\_S8-14.dgn  
 7:03:27 PM  
 12/13/2016  
 aveyac