

QUANTITIES			
		BENT 2	
REINFORCING STEEL	LBS.	19,334	
SPIRAL REINFORCING STEEL	LBS.	1,686	
CLASS A CONCRETE :			
POUR 1 - FOOTINGS	CU. YDS.	64.0	
POUR 2 - COLUMNS	CU. YDS.	21.8	
POUR 3 - CAP	CU. YDS.	30.5	
TOTAL	CU. YDS.	116.3	
HP12x53 STEEL PILES			
NUMBER	NO.	24	
LENGTH	FT.	1,904	
PILE DRIVING EQUIP. SETUP FOR HP 12x53 STEEL PILES	EA.	24	

### BAR TYPES

#### BILL OF MATERIAL FOR BENT 2

BAR	NO.	SIZE	TYPE	LENGTH	WEIGHT
B1	8	#11	STR.	46'-8"	1,984
B2	6	#11	①	36'-8"	1,169
B3	6	#11	①	26'-9"	853
B4	12	#4	STR.	10'-2"	81
B5	6	#4	STR.	4'-2"	17
B6	6	#5	STR.	46'-8"	292
B7	2	#5	STR.	14'-7"	30
B8	3	#4	STR.	3'-8"	7
F1	72	#10	④	14'-4"	4,441
F2	72	#10	STR.	11'-6"	3,563
M1	36	#10	③	12'-4"	1,911
S1	42	#5	②	10'-4"	453
S2	42	#5	②	11'-2"	489
U1	13	#4	⑤	5'-6"	48
U2	4	#4	⑤	5'-11"	16
U3	53	#4	⑤	6'-8"	236
V1	36	#10	①	24'-2"	3,744
SP-1	3	*	⑥	841'-4"	1,686

ALL BAR DIMENSIONS ARE OUT TO OUT

\* THE SP-1 SPIRAL REINFORCING SHALL BE W20 OR D-20 COLD DRAWN WIRE OR #4 PLAIN OR DEFORMED BAR WITH A 3" PITCH.

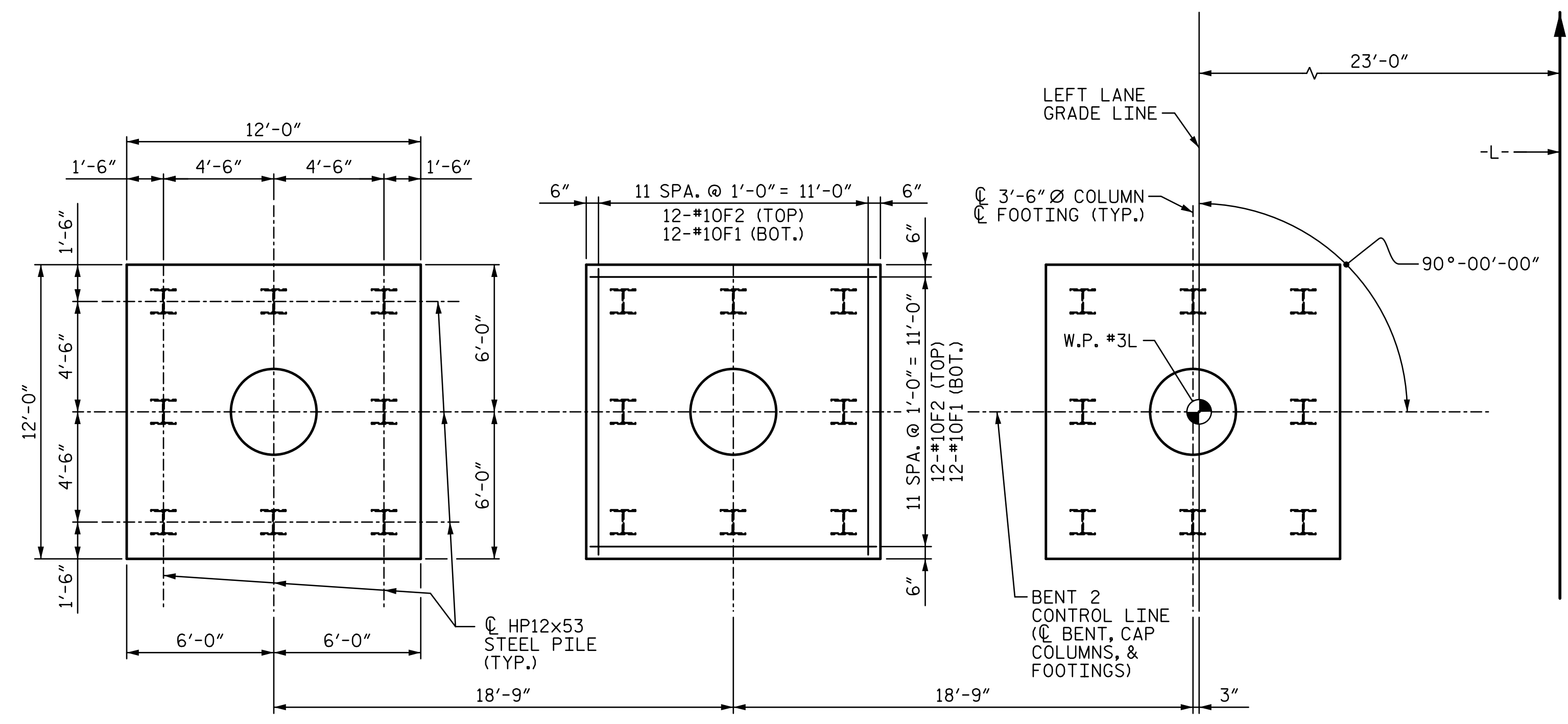

PROJECT NO. R-2707C  
CLEVELAND COUNTY  
 STATION: 596+50.98 -L-  
 SHEET 3 OF 3

DOCUMENT NOT CONSIDERED FINAL UNLESS ALL SIGNATURES COMPLETED

DocuSigned by:  
Tony R. Laws, Jr.  
2/21/2017

STV ENGINEERS, INC.  
900 West Trade St., Suite 715  
Charlotte, NC 28202  
NC License Number F-5991

STATE OF NORTH CAROLINA  
 DEPARTMENT OF TRANSPORTATION  
 RALEIGH

**SUBSTRUCTURE**

**BENT 2**

**DETAILS & QUANTITIES**

(SITE 6L)

SHEET NO.  
S7-47

TOTAL SHEETS  
56

REVISIONS					
NO.	BY:	DATE:	NO.	BY:	DATE:
1			3		
2			4		

2/21/2017 12:55:08 PM R:\407\_093\_R2707C\_SMU\_B203\_S7-47.dgn

DRAWN BY: ATH DATE: 10-16 DESIGN ENGINEER OF RECORD: V. WU DATE: 10-16

CHECKED BY: TJT DATE: 10-16