

QUANTITIES			
			BENT 1
REINFORCING STEEL	LBS.		32,770
SPIRAL REINFORCING STEEL	LBS.		2,657
CLASS A CONCRETE :			
POUR 1 - FOOTINGS	CU. YDS.		106.7
POUR 2 - COLUMNS	CU. YDS.		34.3
POUR 3 - CAP	CU. YDS.		49.3
TOTAL	CU. YDS.		190.3
HP12x53 STEEL PILES			
NUMBER	NO.		60
LENGTH	FT.		2,940
PILE DRIVING EQUIP. SETUP FOR HP 12x53 STEEL PILES	EA.		60

BAR TYPES

ALL BAR DIMENSIONS ARE OUT TO OUT

BILL OF MATERIAL FOR BENT 1					
BAR	NO.	SIZE	TYPE	LENGTH	WEIGHT
B1	8	#11	STR.	32'-8"	1,388
B2	8	#11	STR.	53'-3"	2,263
B3	8	#11	(1)	51'-2"	2,175
B4	8	#11	(1)	41'-9"	1,775
B5	16	#4	STR.	17'-10"	191
B6	8	#4	STR.	4'-2"	22
B7	2	#5	STR.	29'-7"	62
B8	12	#5	STR.	39'-7"	495
B9	3	#4	STR.	3'-8"	7
F1	120	#10	(4)	14'-4"	7,401
F2	120	#10	STR.	11'-6"	5,938
M1	60	#10	(3)	12'-4"	3,184
S1	66	#5	(2)	10'-9"	740
S2	70	#5	(2)	11'-7"	846
U1	13	#4	(5)	5'-6"	48
U2	4	#4	(5)	5'-11"	16
U3	63	#4	(5)	6'-8"	281
V1	60	#10	(1)	23'-0"	5,938
SP-1	5	*	(6)	795'-6"	2,657

* THE SP-1 SPIRAL REINFORCING SHALL BE W20 OR D-20 COLD DRAWN WIRE OR #4 PLAIN OR DEFORMED BAR WITH A 3" PITCH.

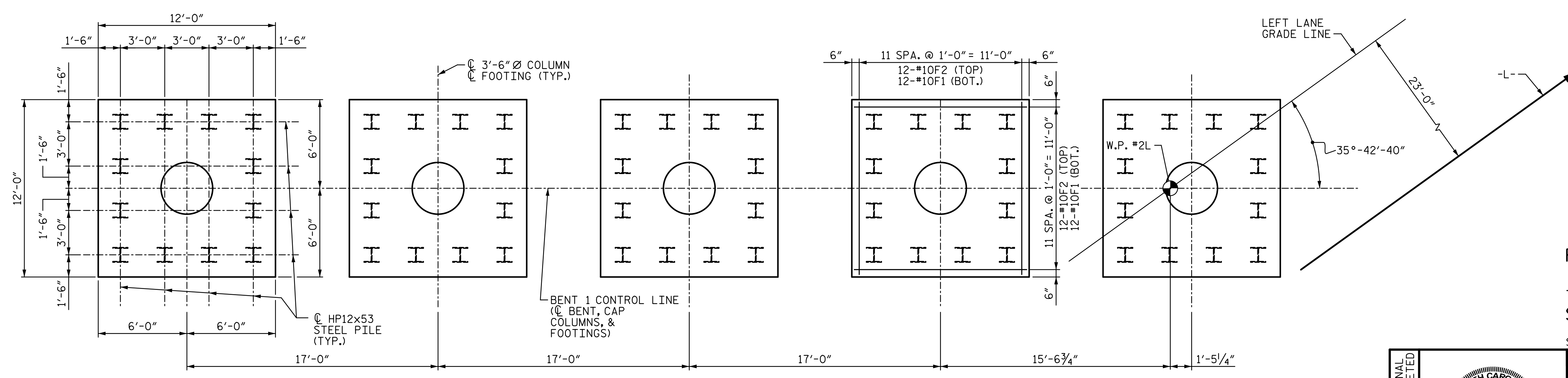

PROJECT NO. R-2707C
CLEVELAND COUNTY
 STATION: 596+50.98 -L-
 SHEET 3 OF 3

DOCUMENT NOT CONSIDERED FINAL UNLESS ALL SIGNATURES COMPLETED

DocuSigned by:
Tony R. Laws, Jr.
 2/21/2017

STATE OF NORTH CAROLINA
 DEPARTMENT OF TRANSPORTATION
 RALEIGH

SUBSTRUCTURE

BENT 1
DETAILS & QUANTITIES

(SITE 6L)

REVISIONS			
NO.	BY:	DATE:	NO.
1			3
2			4

SHEET NO. **S7-44**
 TOTAL SHEETS **56**

2/21/2017 12:55:08 PM R:\407_087_R2707C_SMU_B103_S7-44.dgn

DRAWN BY: ATH DATE: 10-16 DESIGN ENGINEER OF RECORD: V. WU DATE: 10-16
 CHECKED BY: TJT DATE: 10-16