

SPAN B GIRDERS ELEVATION

(CONNECTOR PLATES AND COMBINATION CONNECTOR/STIFFENER PLATES NOT SHOWN FOR CLARITY. FOR PLACEMENT, SEE "FRAMING PLAN")

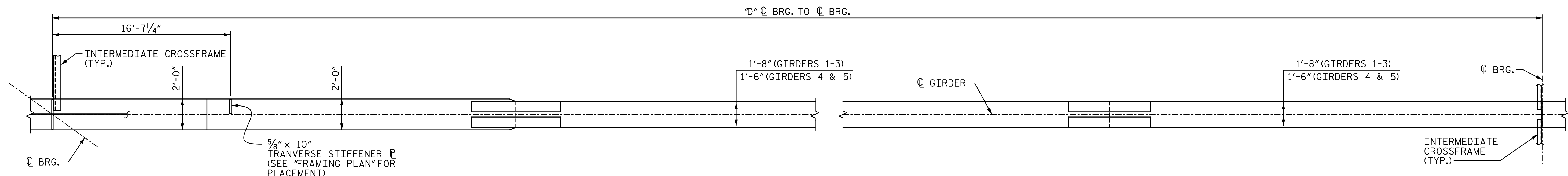

SPAN B GIRDERS BOTTOM FLANGE DETAIL

(CONNECTOR PLATES AND COMBINATION CONNECTOR/STIFFENER PLATES NOT SHOWN FOR CLARITY. FOR PLACEMENT, SEE "FRAMING PLAN")

NOTES:

- CHARPY V-NOTCH TESTS ARE REQUIRED FOR ALL TOP OR BOTTOM FLANGE PLATES WHICH FALL WITHIN THESE LIMITS, ALL WEB PLATES AND ALL SPLICE PLATES. IF A PERMITTED SHOP FLANGE SPLICE IS NOT USED, CHARPY V-NOTCH TESTS WILL BE REQUIRED FOR THE ENTIRE FLANGE PLATE. FOR CHARPY V-NOTCH TESTS, SEE ARTICLE 1072-7 OF THE STANDARD SPECIFICATIONS.
- NO WELDING OF FORMS OR FALSEWORK TO THE TOP FLANGE WILL BE PERMITTED IN THIS REGION.
- SEE SHEET 1 OF 11 FOR SHEAR CONNECTOR DETAILS.
- SEE "SUPERSTRUCTURE STRUCTURAL STEEL BOLTED FIELD SPLICE" SHEETS FOR LOCATIONS & DETAILS OF SHEAR CONNECTORS ON TOP FLANGE SPLICE PLATES.

GIRDER DIMENSIONS													
GDR.	"A"	SPAN B			SHEAR CONNECTORS				TENSION ZONE				
		"B"	"C"	"D"	"E"	"F"	"G"	NO. OF SHEAR CONN.	"EE"	"FF"	"GG"	"HH"	"II"
1	636'-7 1/2"	100'-0"	124'-7 1/2"	157'-7 11/16"	97	80'-10"	3'-2"	600	57'-7"	75'-0 1/16"	25'-0"	29'-7 11/16"	128'-0"
2	614'-5 1/4"	85'-4 3/4"	117'-0 1/2"	143'-0 7/16"	80	66'-8"	2'-8 3/4"	532	57'-0"	69'-0 7/16"	17'-0"	30'-3 7/16"	112'-9"
3	592'-2 1/2"	70'-9 7/16"	109'-5 1/16"	128'-5 5/8"	62	51'-8"	3'-1 7/16"	460	58'-2"	57'-8 1/8"	12'-7"	29'-6 1/8"	98'-11"
4	569'-11 3/4"	56'-2 3/16"	101'-9 9/16"	113'-9 7/8"	45	37'-6"	2'-8 3/16"	392	51'-8"	50'-1 7/8"	12'-0"	26'-8 7/8"	87'-1"
5	547'-9 1/8"	41'-6 7/8"	94'-2 1/4"	99'-2 9/16"	27	22'-6"	3'-0 7/8"	320	54'-10"	36'-7 9/16"	7'-9"	24'-7 9/16"	74'-7"

PROJECT NO. R-2707C
CLEVELAND COUNTY
 STATION: 596+50.98 -L-
 SHEET 2 OF 11

DOCUMENT NOT CONSIDERED FINAL UNLESS ALL SIGNATURES COMPLETED

DocuSigned by:
Tony R. Laws, Jr.
CA0CE9F8B764F7... 12/13/2016

STATE OF NORTH CAROLINA
 DEPARTMENT OF TRANSPORTATION
 RALEIGH

SUPERSTRUCTURE

STRUCTURAL STEEL GIRDER ELEVATION SPAN B

(SITE 6L)

SHEET NO. S7-15
 TOTAL SHEETS 56

REVISIONS			
NO.	BY:	DATE:	NO.
1			3
2			4

R:\407_029_R2707C_SMU_SSD02_S7-15.dgn
 6:59:33 PM
 12/13/2016
 aveyac

DRAWN BY: VMW DATE: 10-16
 CHECKED BY: TRL DATE: 10-16
 DESIGN ENGINEER OF RECORD: V. WU DATE: 10-16