

PLAN @ END BENT #1 PLAN @ END BENT #2
DIMENSIONS SHOWN ARE TYPICAL FOR BOTH APPROACH SLABS

BAR TYPES
ALL DIMENSIONS ARE OUT TO OUT

BILL OF MATERIAL
FOR ONE APPROACH SLAB
(2 REQ'D)

BAR	NO.	SIZE	TYPE	LENGTH	WEIGHT
* A1	78	#4	STR	27'-9"	1446
A2	78	#4	STR	27'-7"	1437
* B1	158	#5	STR	24'-2"	3983
B2	158	#6	STR	24'-8"	5854
* B3	8	#4	STR	24'-8"	132
* G1	52	#4	STR	5'-0"	173
* U1	16	#4	STR	3'-6"	37

REINFORCING STEEL 7291 LBS.
* EPOXY COATED REINFORCING STEEL 5771 LBS.

CLASS AA CONCRETE
POUR 1 85.0 C.Y.
POUR 2 (SIDEWALK) 6.2 C.Y.
TOTAL 91.2 C.Y.

SPLICE LENGTHS

BAR SIZE	EPOXY COATED	UNCOATED
#4	2'-0"	1'-9"
#5	2'-6"	2'-2"
#6	3'-10"	2'-7"

NOTES

APPROACH SLAB SHALL NOT BE CONSTRUCTED PRIOR TO COMPLETION OF THE BRIDGE DECK.

FOR REINFORCED BRIDGE APPROACH FILL FABRIC WALL INCLUDING GEOTEXTILE, IMPERMEABLE GEOMEMBRANE, 4" Ø DRAINAGE PIPE, #78M STONE, WELDED WIRE FORM, AND SELECT MATERIAL, SEE ROADWAY PLANS.

AREA BETWEEN THE WINGWALL AND APPROACH SLAB SHALL BE GRADED TO DRAIN THE WATER AWAY FROM THE FILL FACE OF THE BRIDGE AND SHALL BE PAVED. SEE ROADWAY PLANS.

THE JOINT OPENING AT THE APPROACH SLAB/DECK INTERFACE SHALL BE SAWED NO MORE THAN 12 HOURS AFTER THE APPROACH SLAB IS CAST. THE JOINT SHALL BE CLEANED OF ALL DEBRIS BEFORE THE SEALANT IS APPLIED. THE JOINT SEALER MATERIAL SHALL CONFORM TO THE REQUIREMENTS OF SECTION 1028-3 OF THE STANDARD SPECIFICATIONS.

FOR SIDEWALK DETAILS, SEE SHEET 2 OF 2.

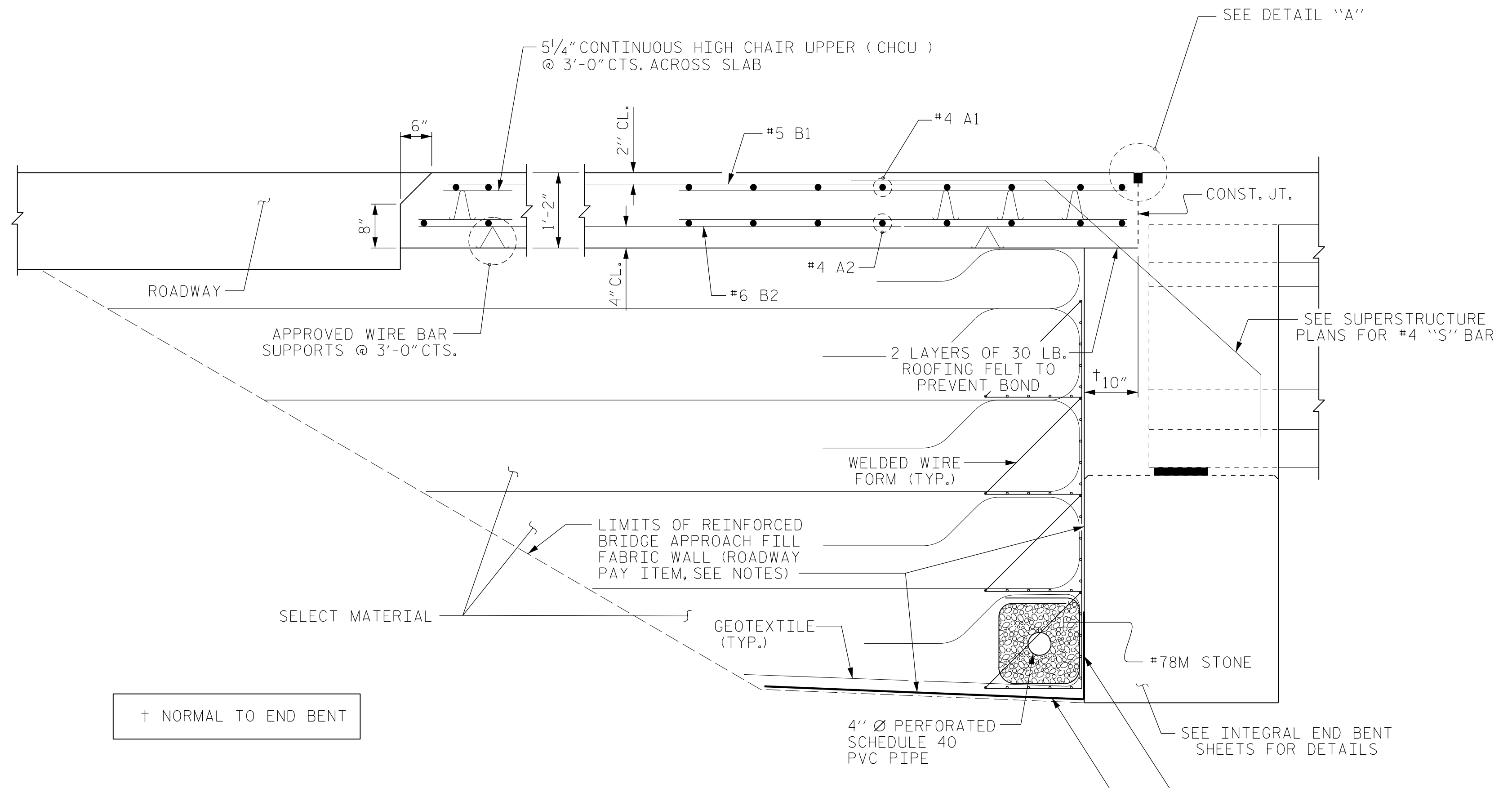
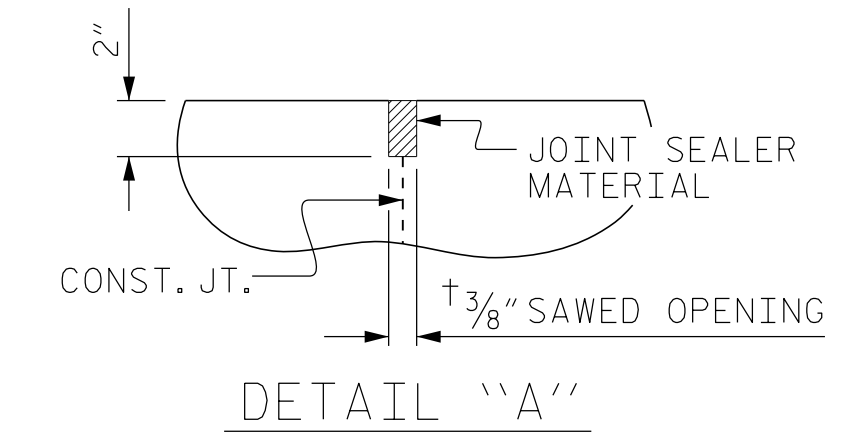

SECTION THRU SLAB

PROJECT NO. R-2707C
CLEVELAND COUNTY
STATION: 24+07.99 -Y9- POT
SHEET 1 OF 2



DocuSigned by:
Jeff Loftus 2/2/2017

Firm License No. C-1051
421 Fayetteville St,
Suite 400
Raleigh, NC 27601
T 919.380.8750
www.stewartinc.com

STATE OF NORTH CAROLINA
DEPARTMENT OF TRANSPORTATION
RALEIGH

BRIDGE APPROACH SLAB
FOR INTEGRAL ABUTMENT

REVISIONS					
NO.	BY:	DATE:	NO.	BY:	DATE:
1			3		
2			4		

SHEET NO. S6-36
TOTAL SHEETS 37

DRAWN BY: J. LOFTUS DATE: 09-16
CHECKED BY: H. ASSFOURA DATE: 11-16
DESIGN ENGINEER OF RECORD: J. LOFTUS DATE: 09-16

R 2707C-6
2/2/2017
\\406_071_R2707C_SMU_BA51_S6-36.dgn
USER: jloftus