

BM #24, CHISLED "X" ON 72 INCH CMP HEADWALL, STA. 509+93.36 -L-, 72.52 FT. LT.

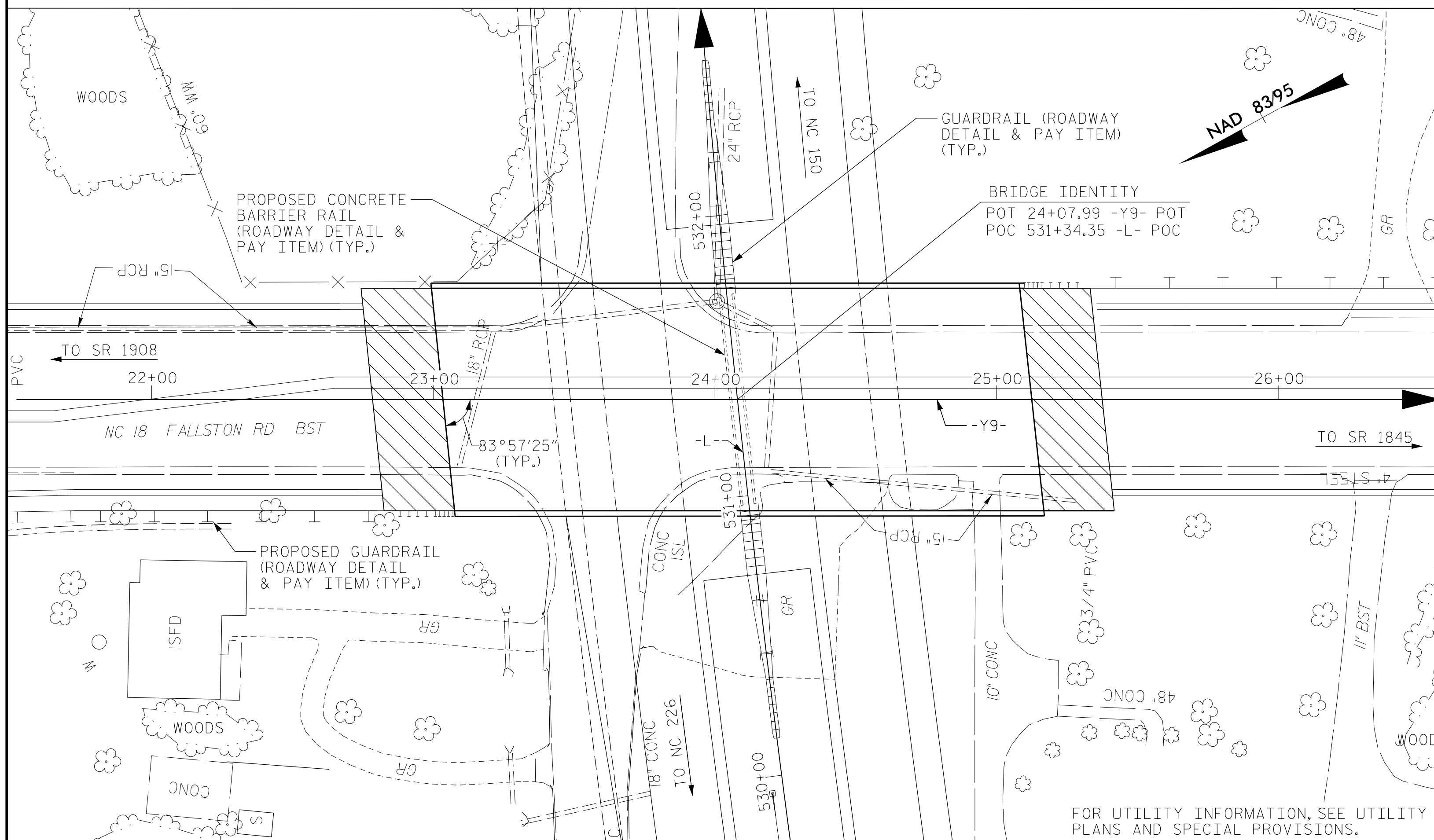

LOCATION SKETCH

NOTES

1. ASSUMED LIVE LOAD = HL-93 OR ALTERNATE LOADING
2. THIS BRIDGE HAS BEEN DESIGNED IN ACCORDANCE WITH THE REQUIREMENTS OF THE AASHTO LRFD BRIDGE DESIGN SPECIFICATIONS
3. THIS BRIDGE IS LOCATED IN SEISMIC ZONE 1.
4. FOR OTHER DESIGN DATA AND GENERAL NOTES, SEE SHEET SN.
5. FOR SUBMITTAL OF WORKING DRAWINGS, SEE SPECIAL PROVISIONS.
6. FOR FALSEWORK AND FORMWORK, SEE SPECIAL PROVISIONS.
7. FOR CRANE SAFETY, SEE SPECIAL PROVISIONS.
8. FOR GROUT FOR STRUCTURES, SEE SPECIAL PROVISIONS.
9. FOR PLACING LOAD ON STRUCTURE MEMBERS, SEE SPECIAL PROVISIONS
10. FOR EROSION CONTROL MEASURES, SEE EROSION CONTROL PLANS.
11. FOR EMBEDDED CLIPS FOR PRESTRESSED CONCRETE GIRDERS, SEE SPECIAL PROVISIONS.
12. NEEDLE BEAMS WILL NOT BE ALLOWED UNLESS OTHERWISE CALLED FOR ON THE PLANS OR APPROVED BY THE ENGINEER.
13. REMOVABLE FORMS MAY BE USED IN LIEU OF METAL STAY-IN-PLACE FORMS IN ACCORDANCE WITH ARTICLE 420-3 OF THE STANDARD SPECIFICATIONS.
14. THE CLASS AA CONCRETE IN THE BRIDGE DECK SHALL CONTAIN FLY ASH OR GROUND GRANULATED BLAST FURNACE SLAG AT THE SUBSTITUTION RATE SPECIFIED IN ARTICLE 1024-1 AND IN ACCORDANCE WITH ARTICLES 1024-5 AND 1024-6 OF THE STANDARD SPECIFICATIONS. NO PAYMENT WILL BE MADE FOR THIS SUBSTITUTION AS IT IS CONSIDERED INCIDENTAL TO THE COST OF THE REINFORCED CONCRETE DECK SLAB.
15. FOR FOUNDATION NOTES, SEE SHEET S6-2.

TOTAL BILL OF MATERIAL

	FOUNDATION EXCAVATION FOR BENT NO. 1	REINFORCED CONCRETE DECK SLAB	GROOVING BRIDGE FLOOR	CLASS A CONCRETE	BRIDGE APPROACH SLABS	REINFORCING STEEL	SPIRAL COLUMN REINFORCING STEEL	MODIFIED 63" PRESTRESSED CONCRETE GIRDERS	PILE DRIVING EQUIPMENT SETUP FOR HP 12X53 STEEL PILES	HP 12X53 STEEL PILES	1'-2" x 3'-2 3/4" CONCRETE PARAPET	TWO BAR METAL RAIL	4" SLOPE PROTECTION	ELASTOMERIC BEARINGS
	LUMP SUM	SQ. FT.	SQ. FT.	CY. YDS.	LUMP SUM	LBS	LBS	NO. LIN. FT.	EACH	NO. LIN. FT.	LIN. FT.	LIN. FT.	SQ. YDS.	LUMP SUM
SUPERSTRUCTURE		16,915	16,726		LUMP SUM			16 1644.5			414.65	399.40		LUMP SUM
END BENT No. 1				63.9		9,695			10	10	910		317	
BENT No. 1	LUMP SUM			147.9		24,911	2,737		30	30	1,650			
END BENT No. 2				65.2		9,734			10	10	840		402	
TOTAL	LUMP SUM	16,915	16,726	277.0	LUMP SUM	44,340	2,737	16 1644.5	50	50	3,400	414.65	399.40	719 LUMP SUM

PROJECT NO. R-2707C
CLEVELAND COUNTY
 STATION: 24+07.99 -Y9- POT

SHEET 3 OF 4

DocuSigned by:
 Jeff Loftus 3/28/2017
 FES1DC02E79A42



DOCUMENT NOT CONSIDERED FINAL
 UNLESS ALL SIGNATURES COMPLETED



STEWART

Firm License No. C-1051
 421 Fayetteville St,
 Suite 400
 Raleigh, NC 27601
 T 919.380.8750
 www.stewartinc.com

STATE OF NORTH CAROLINA
 DEPARTMENT OF TRANSPORTATION
 RALEIGH
 GENERAL DRAWING
 FOR BRIDGE OVER
 US 74/SHELBY BYPASS
 ON NC 18 (FALLSTON RD.)
 BETWEEN SR 1845 AND SR 1908

REVISIONS						SHEET NO.
NO.	BY:	DATE:	NO.	BY:	DATE:	S6-3
1			3			TOTAL SHEETS
2			4			37

STR. #6

DRAWN BY: J. LOFTUS DATE: 07-16
 CHECKED BY: H. ASSFOURA DATE: 11-16
 DESIGN ENGINEER OF RECORD: J. LOFTUS DATE: 07-16

3/28/2017
 ...\\406_005_r2707c.smw-LS3_S6-3.dgn
 USER: jloftus

R 2707C-6