

BAGGED STONE AND PIPE SHALL BE PLACED IMMEDIATELY AFTER COMPLETION OF END BENT EXCAVATION. PIPE MAY BE EITHER CONCRETE, CORRUGATED STEEL, CORRUGATED ALUMINUM ALLOY, OR CORRUGATED PLASTIC. PERFORATED PIPE WILL NOT BE ALLOWED.

BAGGED STONE SHALL REMAIN IN PLACE UNTIL THE ENGINEER DIRECTS THAT IT BE REMOVED. THE CONTRACTOR SHALL REMOVE AND DISPOSE OF SILT ACCUMULATIONS AT BAGGED STONE WHEN SO DIRECTED BY THE ENGINEER. BAGS SHALL BE REMOVED AND REPLACED WHENEVER THE ENGINEER DETERMINES THAT THEY HAVE DETERIORATED AND LOST THEIR EFFECTIVENESS.

NO SEPARATE PAYMENT WILL BE MADE FOR THIS WORK AND THE ENTIRE COST OF THIS WORK SHALL BE INCLUDED IN THE UNIT CONTRACT PRICE BID FOR THE SEVERAL PAY ITEMS.

TEMPORARY DRAINAGE AT END BENT

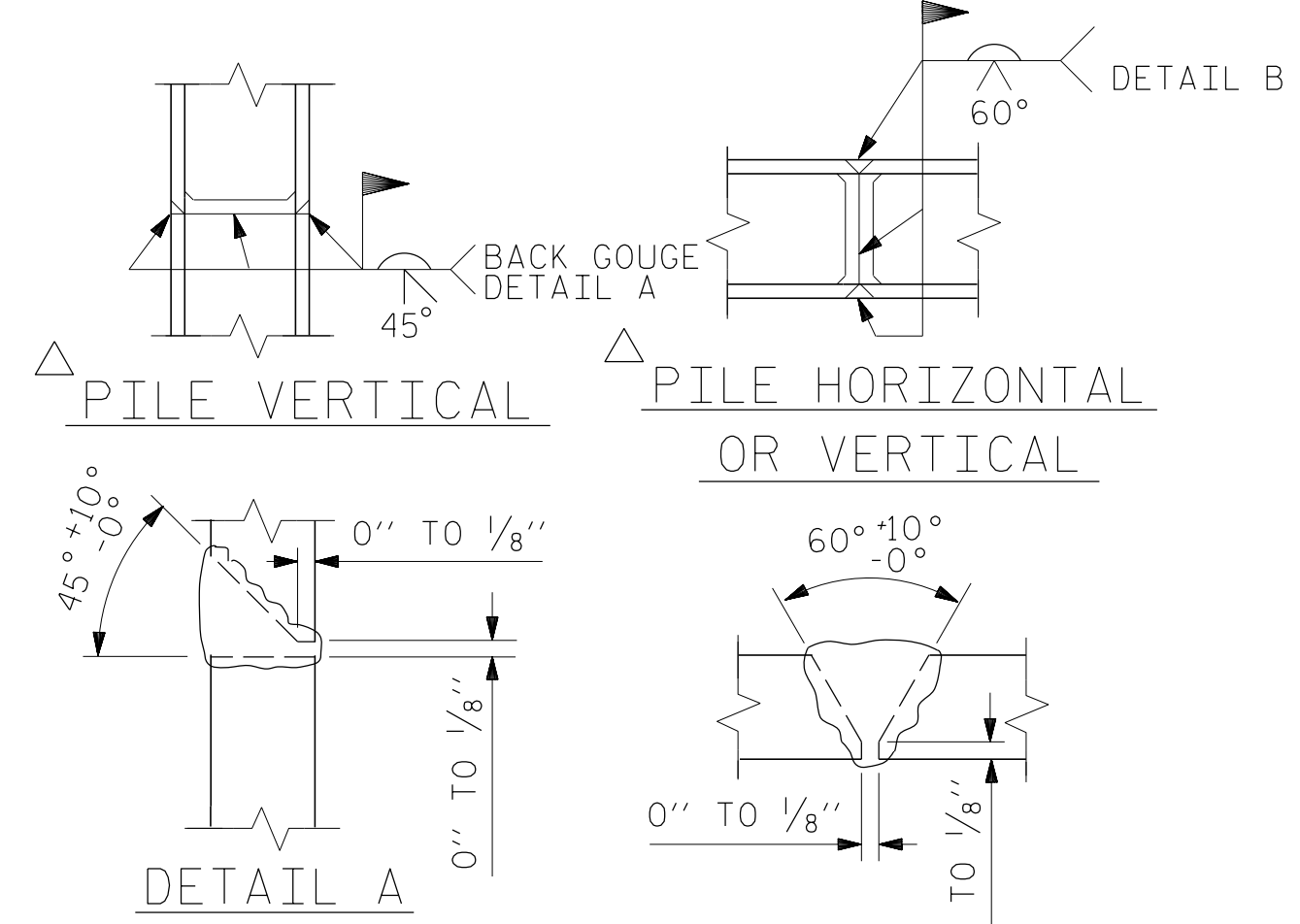

PILE SPLICE DETAILS

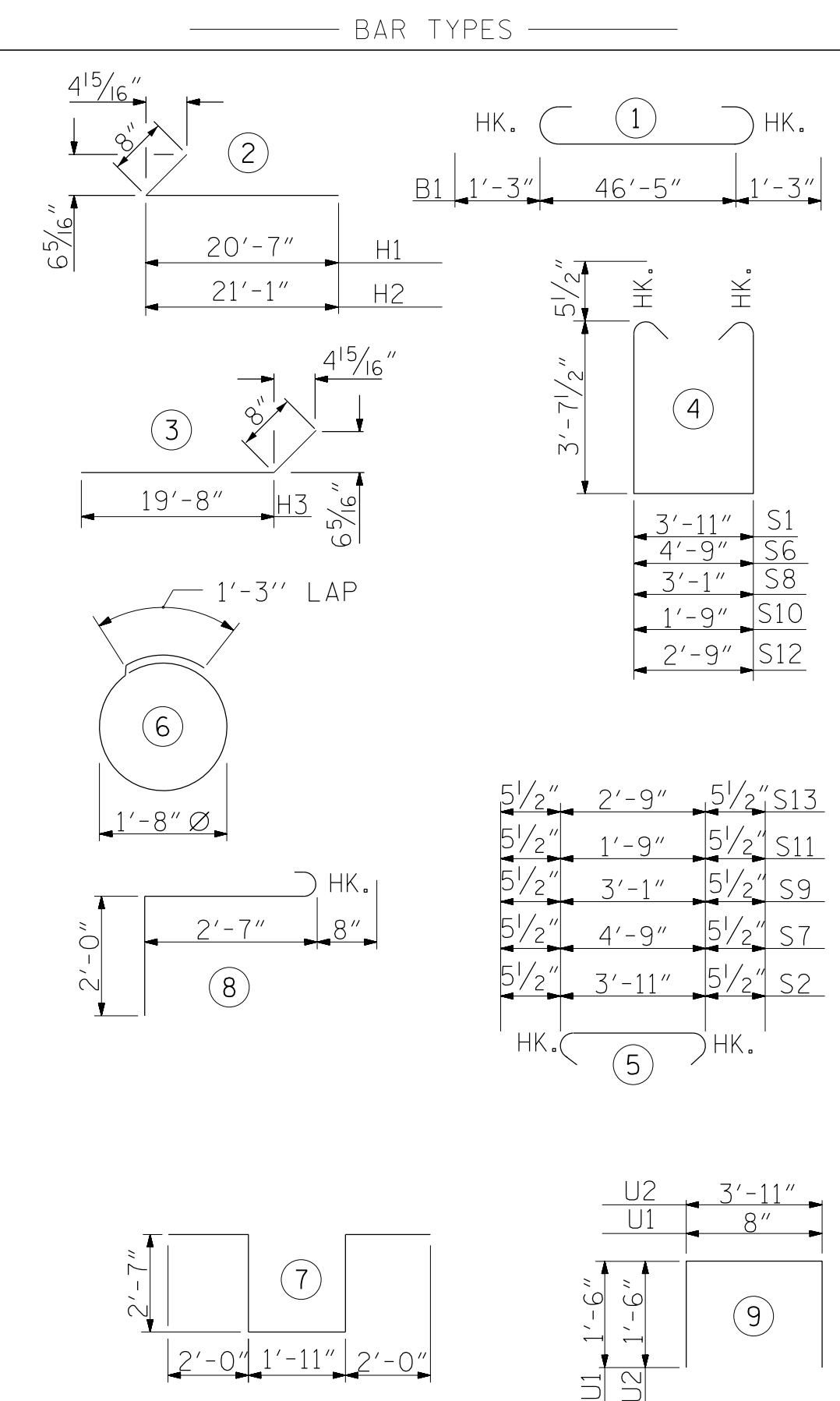

ALL BAR DIMENSIONS ARE OUT TO OUT.

BILL OF MATERIAL

FOR END BENT NO. 1

BAR NO.	NO.	SIZE	TYPE	LENGTH	WEIGHT
B1	12	#9		48'-11"	1996
B2	16	#4	STR	16'-8"	134
B3	16	#4	STR	24'-6"	262
B4	8	#4	STR	24'-6"	131
B5	13	#4	STR	3'-11"	34
H1	17	#4		21'-3"	241
H2	17	#4		21'-9"	247
H3	32	#4		20'-4"	435
K1	32	#4	STR	24'-8"	527
K2	4	#4	STR	4'-2"	11
K3	4	#4	STR	4'-7"	12
S1	49	#5		12'-1"	618
S2	49	#5		4'-10"	247
S3	32	#4		6'-6"	139
S4	6	#6		11'-1"	100
S5	6	#6		5'-3"	47
S6	1	#5		12'-11"	13
S7	1	#5		5'-8"	6
S8	1	#5		11'-3"	12
S9	1	#5		4'-0"	4
S10	1	#5		9'-11"	10
S11	1	#5		2'-8"	3
S12	1	#5		10'-11"	11
S13	1	#5		3'-8"	4
U1	38	#4		3'-8"	93
U2	21	#4		6'-11"	97
V1	76	#5	STR	9'-3"	733
V2	31	#5	STR	11'-4"	366
V3	22	#5	STR	11'-2"	256
V4	31	#5	STR	10'-9"	348
V5	20	#5	STR	10'-6"	219

REINFORCING STEEL (FOR END BENT NO. 1) 7,356 LBS.

CLASS A CONCRETE BREAKDOWN

POUR #1 CAP, LOWER PART OF WINGS & CONCRETE COLLARS 41.0 C.Y.

POUR #2 BACKWALL & UPPER PART OF WINGS 19.9 C.Y.

TOTAL CLASS A CONCRETE 60.9 C.Y.

HP 12 X 53 STEEL PILES NO: 10 LIN. FT. = 285

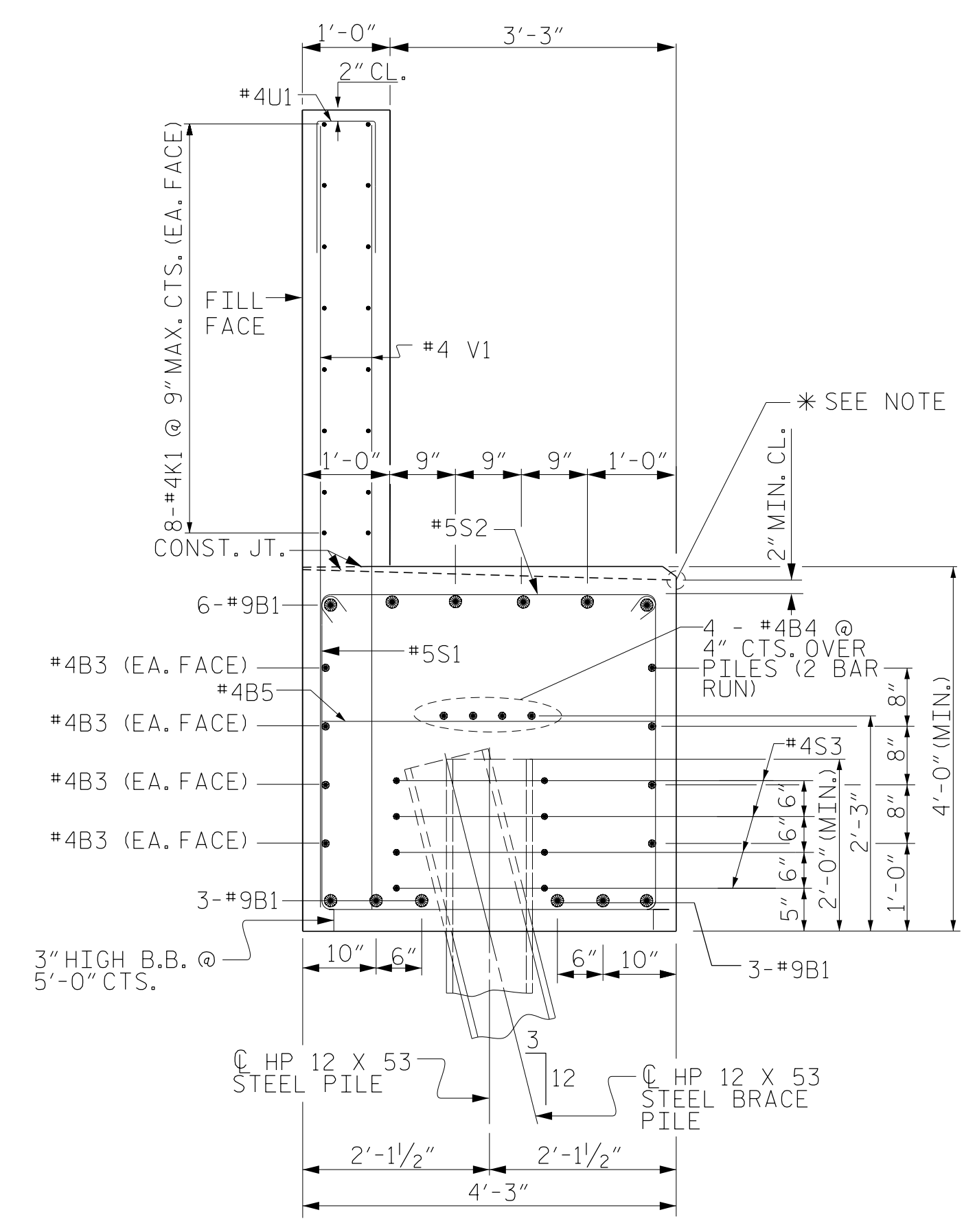

(CONCRETE COLLAR NOT SHOWN FOR CLARITY) (SEE "CORROSION PROTECTION FOR STEEL PILES DETAIL")

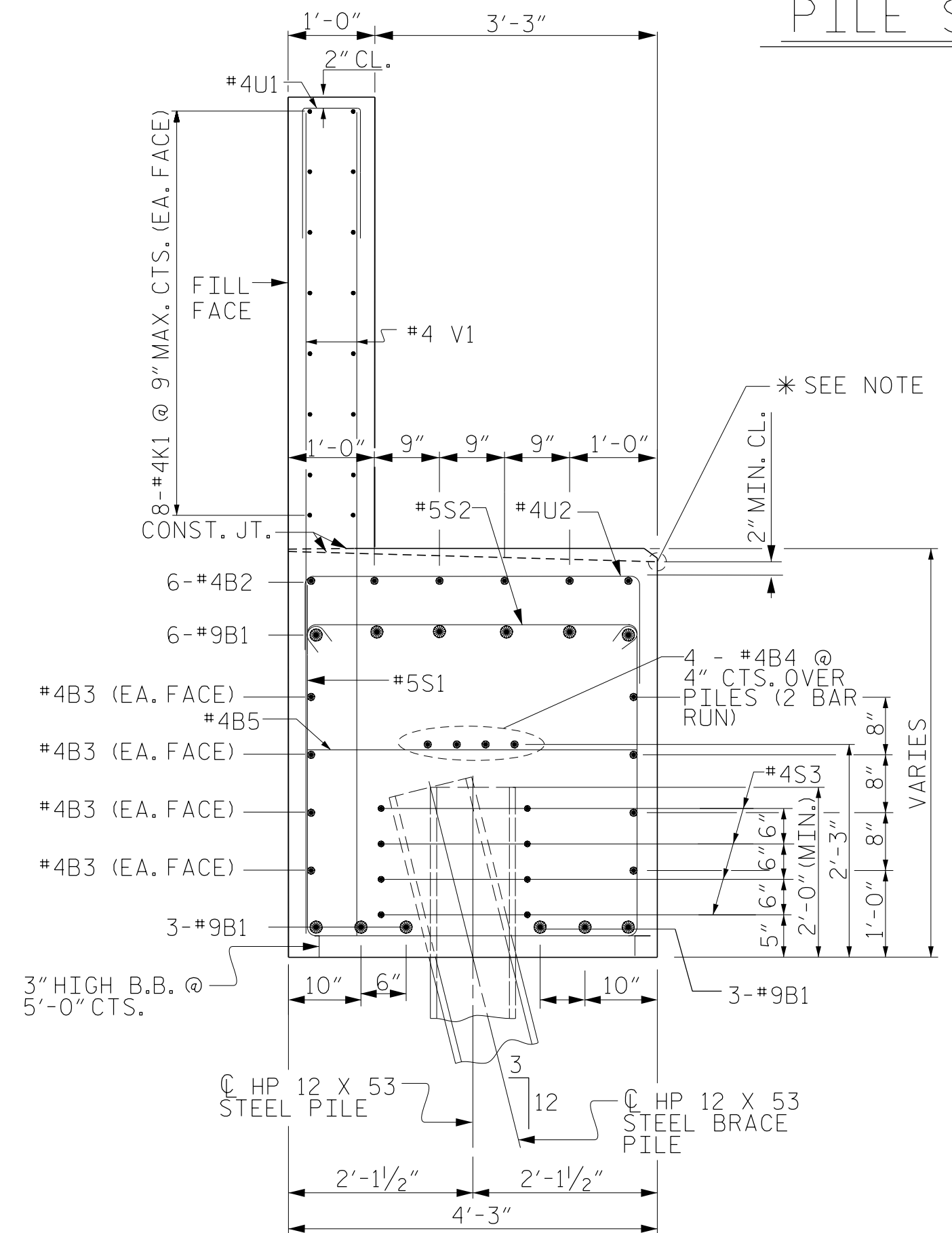

(CONCRETE COLLAR NOT SHOWN FOR CLARITY) (SEE "CORROSION PROTECTION FOR STEEL PILES DETAIL")

NOTES:

THE TOP SURFACE OF THE CAP EXCEPT THE BRIDGE SEAT BUILDUPS SHALL BE SLOPED TRANSVERSLY FROM THE FILL FACE TO THE BACK FACE AT THE RATE OF 2%.

* ELEVATIONS BETWEEN BRIDGE SEAT BUILDUPS ARE SHOWN AT THIS POINT.

DRAWN BY: H.ASSFOURA	DATE: 03/16
CHECKED BY: J.LOFTUS	DATE: 11/16
DESIGN ENGINEER OF RECORD: J.LOFTUS	DATE: 01/17

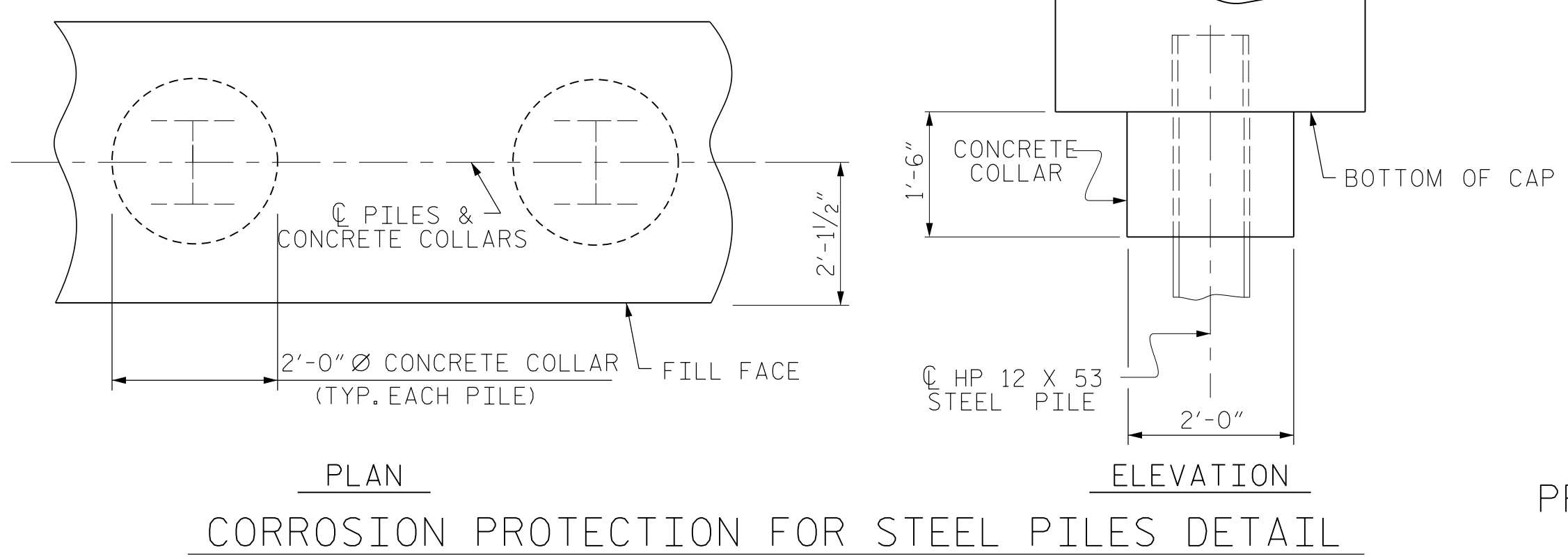

DocuSigned by: Jeff Loftus 2/3/2017

Firm License No. C-1051
421 Fayetteville St., Suite 400
Raleigh, NC 27601
T 919.380.8750
www.stewartinc.com

STEWART

PROJECT NO. R-2707C
CLEVELAND COUNTY
STATION: 24+05.50-Y4-REV POT

SHEET 3 OF 3

STATE OF NORTH CAROLINA DEPARTMENT OF TRANSPORTATION RALEIGH					
SUBSTRUCTURE					
END BENT NO.1 DETAILS					
REVISIONS					
NO.	BY:	DATE:	NO.	BY:	DATE:
1			3		
2			4		
SHEET NO. S5-21					TOTAL SHEETS 29

STR. #5

R 2707C.5
2/3/2017
\\405-041-R2707C-SMU-IEB03-S5-21.dgn
USERdefault