

22+50 23+00 23+50 24+00 24+50 25+00 25+50 26+00

GRADE DATA

(+)-2.4775% (+)-1.6804%
 PI = 27+00.00 -Y4-REV-
 EL = 885.00
 VC = 200'

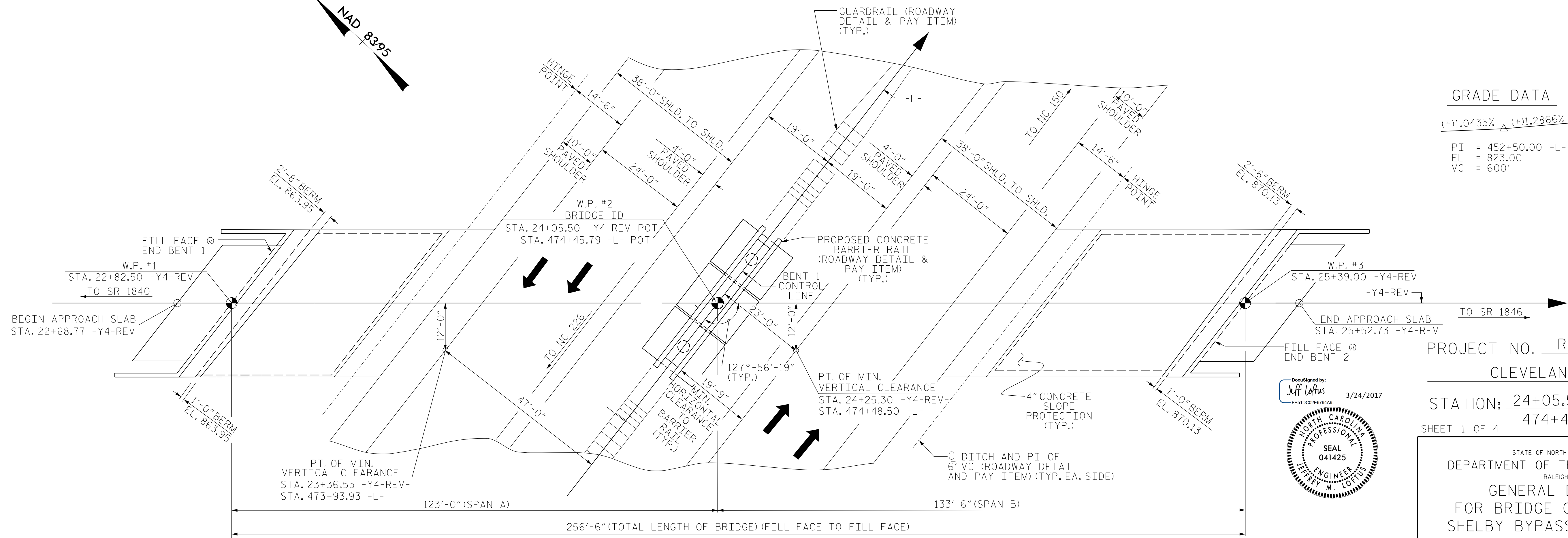
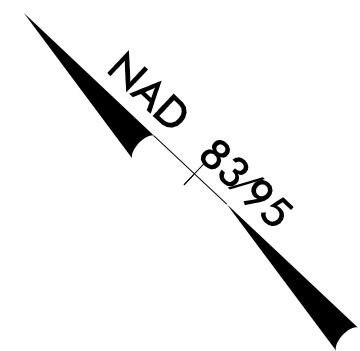
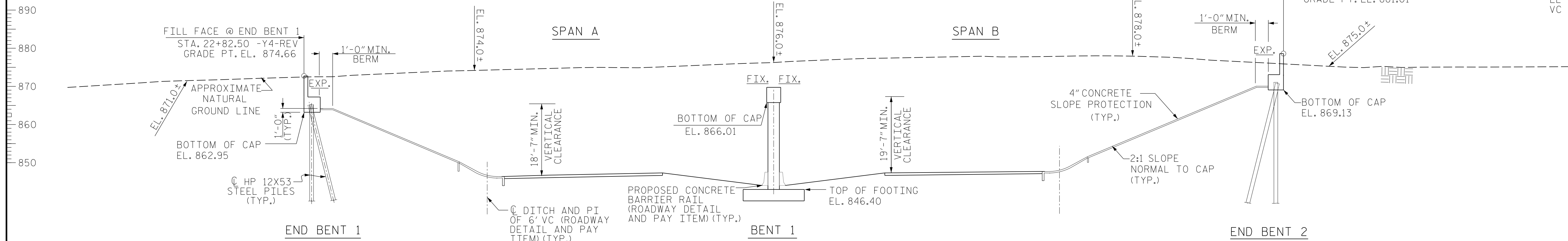

GRADE DATA

(+)-1.0435% (+)-1.2866%
 PI = 452+50.00 -L-
 EL = 823.00
 VC = 600'

Designed by:
 Jeff Loftus
 P.E. 1002597840 3/24/2017



PROJECT NO. R-2707C
 CLEVELAND COUNTY
 STATION: 24+05.50-Y4-REV POT
 474+45.79 -L- POT
 SHEET 1 OF 4 BRIDGE #470

STATE OF NORTH CAROLINA
 DEPARTMENT OF TRANSPORTATION
 RALEIGH
 GENERAL DRAWING
 FOR BRIDGE OVER US 74/
 SHELBY BYPASS ON SR 1827
 (MCBRAYER-SPRINGS RD.)
 BETWEEN SR 1840 AND SR 1846



Firm License No. C-1051
 421 Fayetteville St,
 Suite 400
 Raleigh, NC 27601
 T 919.380.8750
 www.stewartinc.com

**DOCUMENT NOT CONSIDERED FINAL
 UNLESS ALL SIGNATURES COMPLETED**

REVISIONS						SHEET NO.
NO.	BY:	DATE:	NO.	BY:	DATE:	S5-1
1			3			TOTAL SHEETS
2			4			29

STR. #5

DRAWN BY: H.ASSFOURA DATE: 02/16
 CHECKED BY: J.LOFTUS DATE: 11/16
 DESIGN ENGINEER OF RECORD: J.LOFTUS DATE: 01/17

R 2707C-5
 3/24/2017
 \\405-001-R2707C-SMU-GD01-S5-1.dgn
 USER:jeffloftus