

R 2707C-SITE 3

2/6/2017
\\404_003_R2707C_SMU_FL2_S4-2.dgn
USERdefault

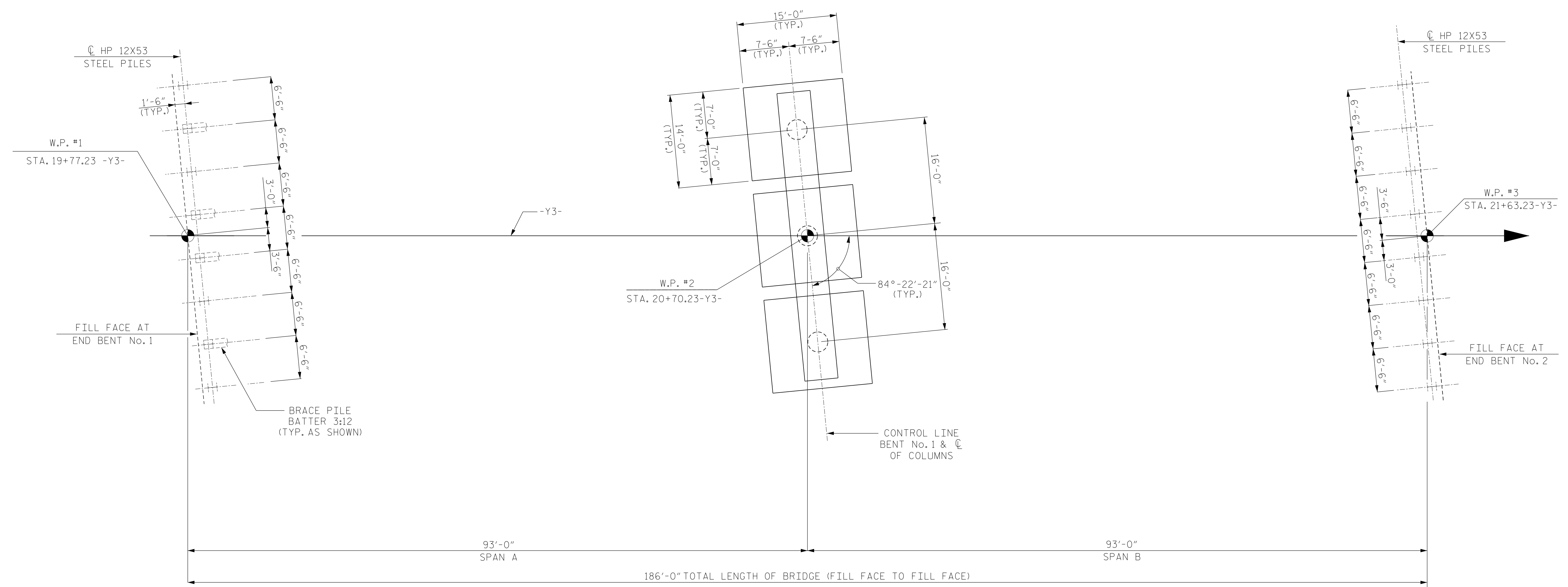

FOUNDATION LAYOUT

ALL BENTS ARE PARALLEL
DIMENSIONS LOCATING PILES ARE SHOWN TO PILE CENTERLINE AT BOTTOM OF CAP

FOUNDATION NOTES

- FOR PILES, SEE GEOTECHNICAL SPECIAL PROVISIONS AND SECTION 450 OF THE STANDARD SPECIFICATIONS.
- PILES AT END BENT NO.1 ARE DESIGNED FOR A FACTORED RESISTANCE OF 105 TONS PER PILE.
- DRIVE PILES AT END BENT NO.1 TO A REQUIRED DRIVING RESISTANCE OF 175 TONS PER PILE.
- PILES AT END BENT NO.2 ARE DESIGNED FOR A FACTORED RESISTANCE OF 100 TONS PER PILE.
- DRIVE PILES AT END BENT NO.2 TO A REQUIRED DRIVING RESISTANCE OF 170 TONS PER PILE.
- THE SPREAD FOOTINGS AT BENT NO.1 ARE DESIGNED FOR A FACTORED RESISTANCE OF 6 TSF. CHECK FIELD CONDITIONS FOR THE REQUIRED RESISTANCE OF 13.5 TSF JUST BEFORE PLACING CONCRETE.

SPECIAL NOTE

- FOR BENT 1 (LT), UNDERCUT TO ELEVATION 808 SHOULD BE ANTICIPATED. ENGINEER SHALL VERIFY FOOTING ARE BEARING ON WEATHERED ROCK OR ROCK. ANY UNDERCUT SHALL BE BACKFILLED WITH A MINIMUM CLASS B CONCRETE.

PROJECT NO. R-2707C
CLEVELAND COUNTY
 STATION: 20+70.23-Y3- POT

SHEET 2 OF 4



DocuSigned by:
Jeff Lotius
 2/6/2017

STEWART
 Firm License No. C-1051
 421 Fayetteville St,
 Suite 400
 Raleigh, NC 27601
 T 919.380.8750
 www.stewartinc.com

| | | | | | |
|--|-----|-------|-----|-----|--------------|
| STATE OF NORTH CAROLINA DEPARTMENT OF TRANSPORTATION RALEIGH | | | | | |
| FOUNDATION LAYOUT | | | | | |
| REVISIONS | | | | | SHEET NO. |
| NO. | BY: | DATE: | NO. | BY: | DATE: |
| 1 | | | 3 | | |
| 2 | | | 4 | | |
| | | | | | TOTAL SHEETS |
| | | | | | 29 |

| | |
|--|--------------------|
| DRAWN BY: <u>H.ASSFOURA</u> | DATE: <u>08/16</u> |
| CHECKED BY: <u>J.LOFTUS</u> | DATE: <u>11/16</u> |
| DESIGN ENGINEER OF RECORD: <u>J.LOFTUS</u> | DATE: <u>01/17</u> |

STR. #4