

BENCH MARK #18: 8 INCH NAIL IN BASE OF 20 INCH WHITE OAK 28.12' LEFT OF STA. 30+98.41 -Y2-, EL. 778.74'

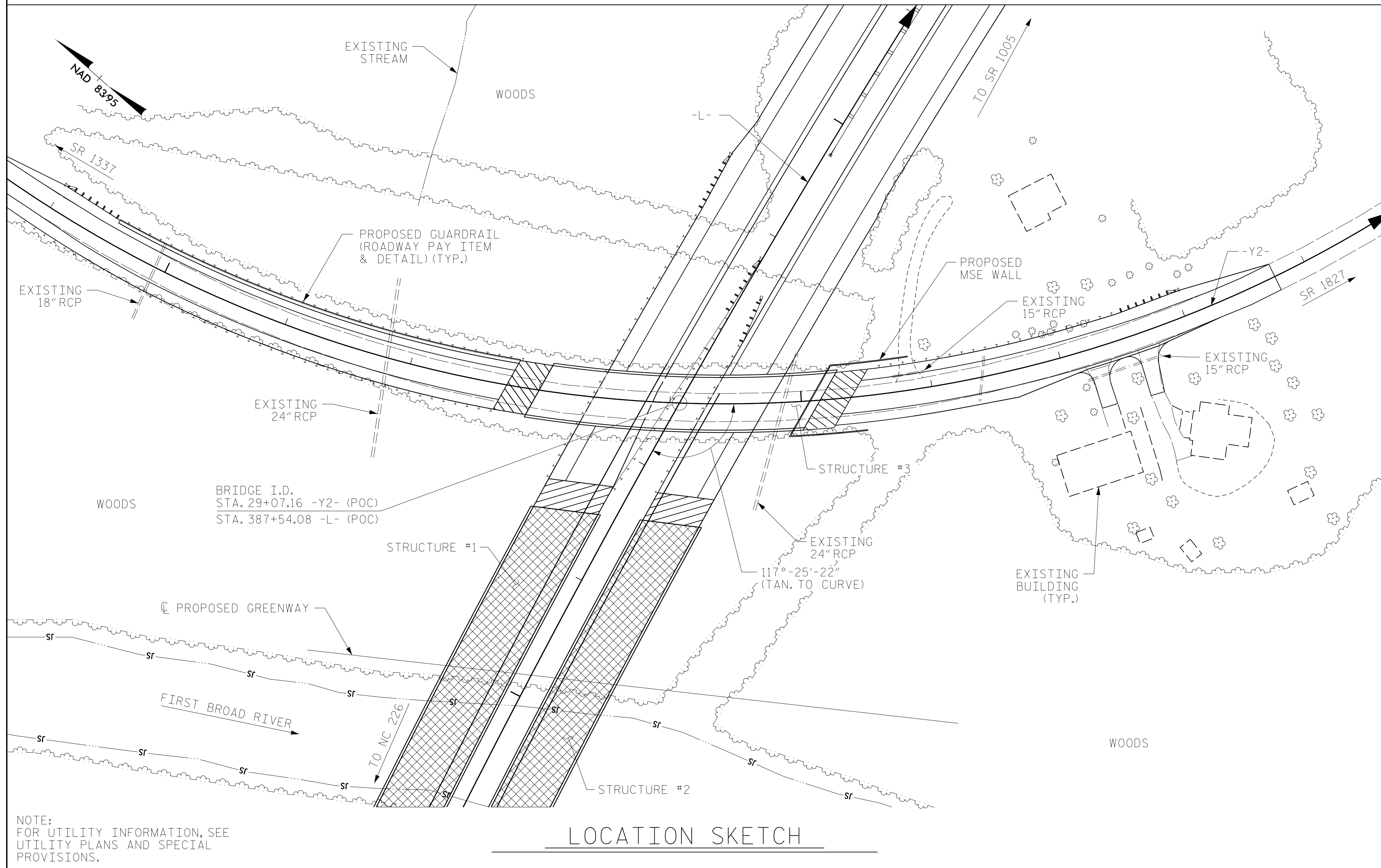

NOTE:  
FOR UTILITY INFORMATION, SEE  
UTILITY PLANS AND SPECIAL  
PROVISIONS.

LOCATION SKETCH

NOTES:

- ASSUMED LIVE LOAD = HL-93 OR ALTERNATE LOADING.
- THIS BRIDGE HAS BEEN DESIGNED IN ACCORDANCE WITH THE REQUIREMENTS OF THE AASHTO LRFD BRIDGE DESIGN SPECIFICATIONS.
- THIS BRIDGE IS LOCATED IN SEISMIC ZONE 1.
- FOR OTHER DESIGN DATA AND GENERAL NOTES, SEE SHEET SN.
- FOR SUBMITTAL OF WORKING DRAWINGS, SEE SPECIAL PROVISIONS.
- FOR FALSEWORK AND FORMWORK, SEE SPECIAL PROVISIONS.
- FOR CRANE SAFETY, SEE SPECIAL PROVISIONS.
- FOR GROUT FOR STRUCTURES, SEE SPECIAL PROVISIONS.
- REMOVABLE FORMS MAY BE USED IN LIEU OF METAL STAY-IN-PLACE FORMS IN ACCORDANCE WITH ARTICLE 420-3 OF THE STANDARD SPECIFICATIONS.
- NEEDLE BEAMS WILL NOT BE ALLOWED UNLESS OTHERWISE CALLED FOR ON THE PLANS OR APPROVED BY THE ENGINEER.
- FOR PLACING LOAD ON STRUCTURE MEMBERS, SEE SPECIAL PROVISIONS.
- FOR EROSION CONTROL MEASURES, SEE EROSION CONTROL PLANS.
- THE CLASS AA CONCRETE IN THE BRIDGE DECK SHALL CONTAIN FLY ASH OR GROUND GRANULATED BLAST FURNACE SLAG AT THE SUBSTITUTION RATE SPECIFIED IN ARTICLE 1024-1 AND IN ACCORDANCE WITH ARTICLES 1024-5 AND 1024-6 OF THE STANDARD SPECIFICATIONS. NO PAYMENT WILL BE MADE FOR THIS SUBSTITUTION AS IT IS CONSIDERED INCIDENTAL TO THE COST OF THE REINFORCED CONCRETE DECK SLAB.

TOTAL BILL OF MATERIAL

	FOUNDATION EXCAVATION FOR BENT 1	REINFORCED CONCRETE DECK SLAB	GROOVING BRIDGE FLOORS	CLASS A CONCRETE	BRIDGE APPROACH SLABS	REINFORCING STEEL	SPIRAL COLUMN REINFORCING STEEL	MODIFIED 72" PRESTRESSED CONCRETE GIRDERS	PILE EXCAVATION NOT IN SOIL	HP 12X53 STEEL PILES	STEEL PILE POINTS	PILE DRIVING EQUIPMENT SETUP FOR HP 12X53 STEEL PILES	VERTICAL CONCRETE BARRIER RAIL	4" SLOPE PROTECTION	ELASTOMERIC BEARINGS	FOAM JOINT SEALS
	LUMP SUM	SQ. FT.	SQ. FT.	CU. YDS.	LUMP SUM	LBS.	LBS.	NO. LIN. FT.	LIN. FT.	NO. LIN. FT.	EACH	EA.	LIN. FT.	SQ. YDS.	LUMP SUM	LUMP SUM
SUPERSTRUCTURE		8,927	9,522		LUMP SUM			10 1,043.38					422.9		LUMP SUM	LUMP SUM
END BENT 1				63.9		8,796				17 510	17	17		143		
BENT 1	LUMP SUM			85.5		13,408	1,307									
END BENT 2				44.1		7,226			80	8 240		8		175		
TOTAL	LUMP SUM	8,927	9,522	193.5	LUMP SUM	29,430	1,307	10 1,043.38	80	25 750	17	25	422.9	318	LUMP SUM	LUMP SUM

PROJECT NO. R-2707C  
CLEVELAND COUNTY  
 STATION: 29+07.16 -Y2-  
 SHEET 4 OF 4



STATE OF NORTH CAROLINA  
 DEPARTMENT OF TRANSPORTATION  
 RALEIGH  
**GENERAL DRAWING**  
 BRIDGE OVER US 74  
 (SHELBY BYPASS)  
 ON SR 1850 BETWEEN  
 SR 1344 AND SR 1827

DRAWN BY : MKO DATE : 12/2016  
 CHECKED BY : JMR DATE : 01/2017  
 DESIGN ENGINEER OF RECORD : MKO DATE : 12/2016

DOCUMENT NOT CONSIDERED  
 FINAL UNLESS ALL  
 SIGNATURES COMPLETED

REVISIONS						SHEET NO.
NO.	BY:	DATE:	NO.	BY:	DATE:	S3-4
1			3			TOTAL SHEETS
2			4			36