

0.6" Ø L. R. GRADE 270 STRANDS

AREA (SQUARE INCHES)	ULTIMATE STRENGTH (LBS. PER STRAND)	APPLIED PRESTRESS (LBS. PER STRAND)
0.217	58,600	43,950

REINFORCING STEEL FOR ONE GDR

BAR	NUMBER	SIZE	TYPE	LENGTH	WEIGHT
S1	262	#4	1	7'-0"	1225
S2	32	#5	1	7'-0"	234
S3	14	#4	2	8'-5"	79
S4	116	#4	3	3'-2"	245
S6	116	#5	4	4'-6"	544
*S7	30	#5	STR	3'-8"	115
S8	2	#5	2	9'-0"	19
S9	117	#5	STR	3'-3"	397
S10	2	#3	STR	1'-10"	1
S11	8	#5	5	11'-10"	99
S12	16	#4	STR	8'-0"	86

* NOTE: S7 BARS SHALL BE BENT BEFORE SHIPMENT. HEAT BENDING SHALL NOT BE ALLOWED.

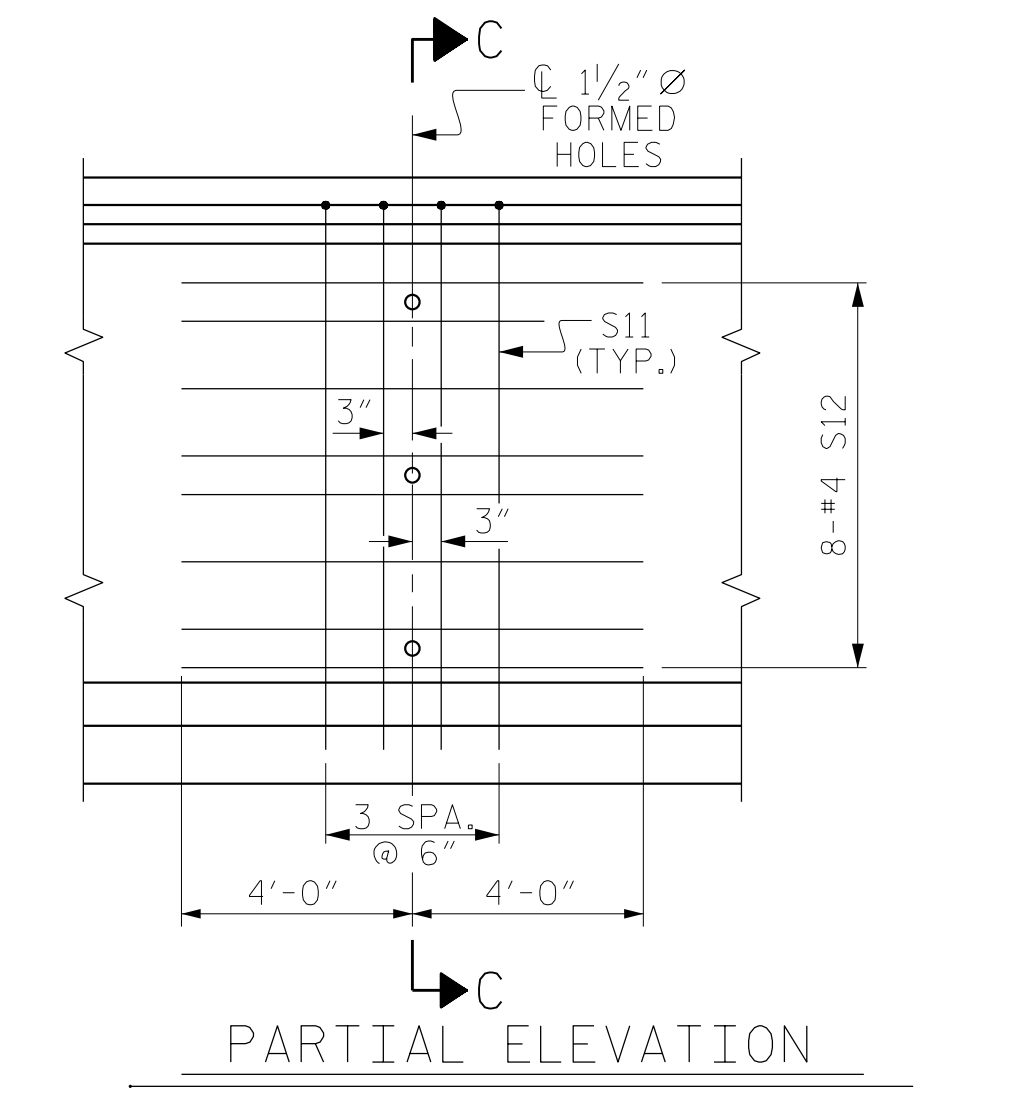
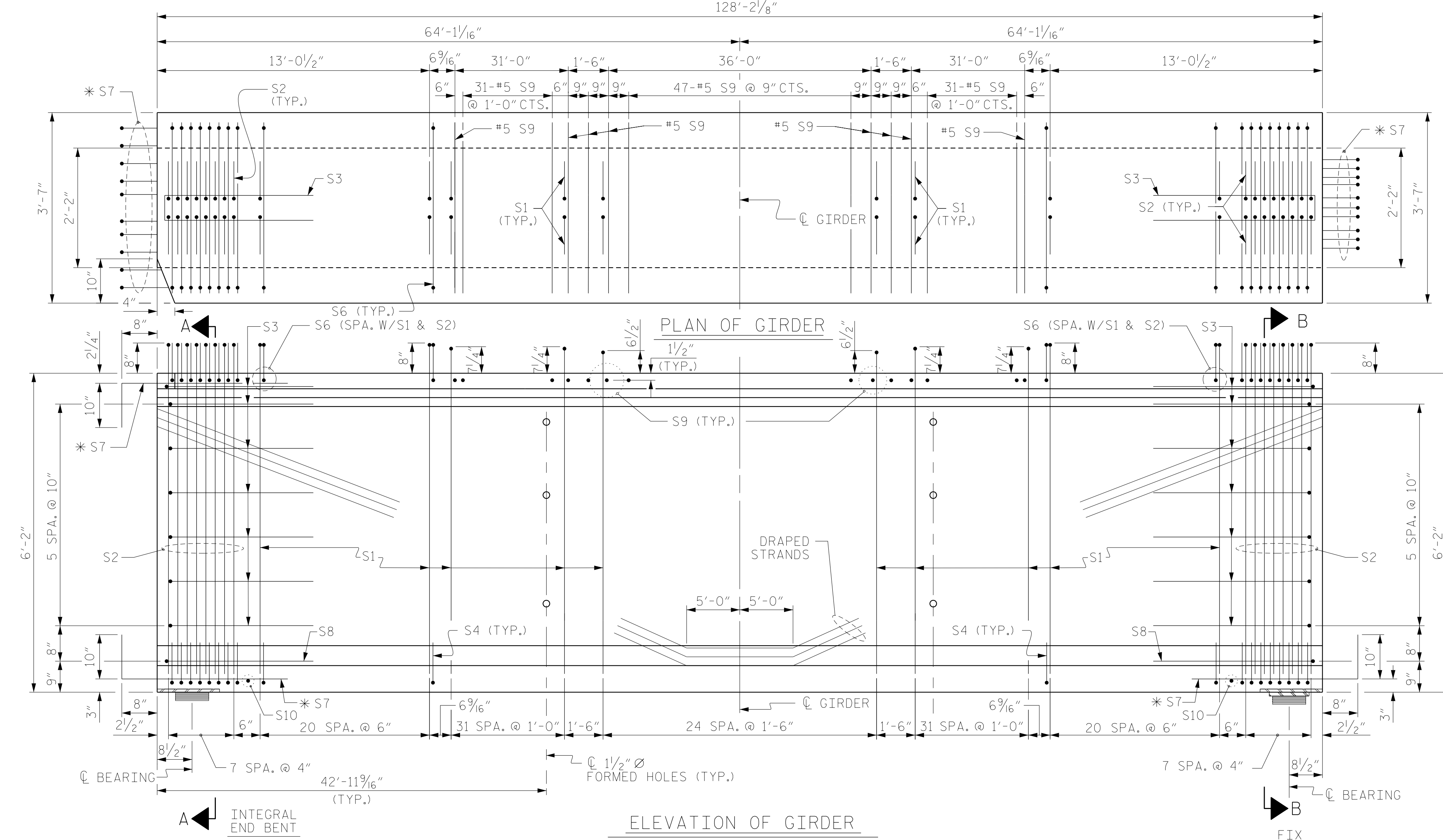
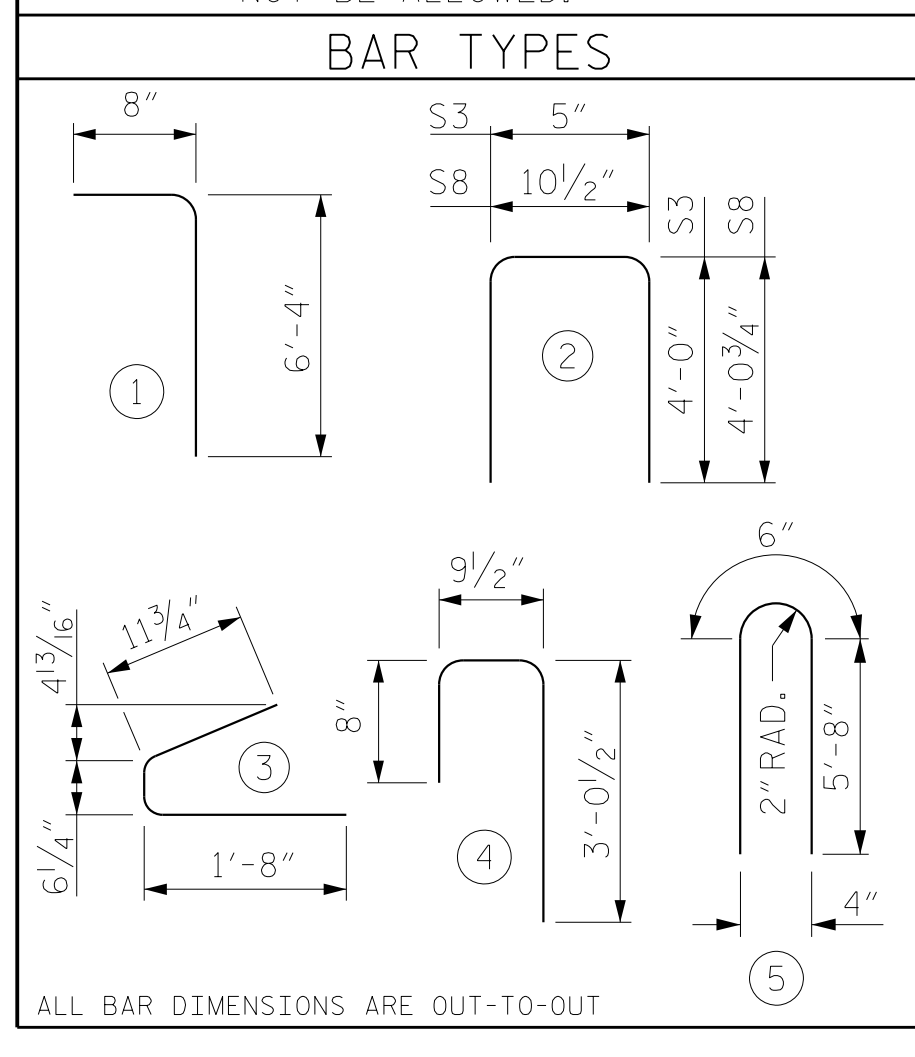

QUANTITIES FOR ONE GIRDER

REINFORCING STEEL	9000 PSI CONCRETE	0.6" Ø L.R. STRANDS
LB.	C.Y.	No.
3044	29.2	46

GIRDERS REQUIRED

NUMBER	LENGTH	TOTAL LENGTH
5	128'-2 1/8"	640'-10 5/8"

PROJECT NO. R-2707C
 CLEVELAND COUNTY
 STATION: 384+50.00 -L-
 SHEET 1 OF 4



STATE OF NORTH CAROLINA
 DEPARTMENT OF TRANSPORTATION
 RALEIGH

SUPERSTRUCTURE
 74" PRESTRESSED CONCRETE
 MODIFIED BULB TEE
 CONTINUOUS FOR LIVE LOAD
 SPAN A
 LEFT LANE

REVISIONS						SHEET NO.
NO.	BY:	DATE:	NO.	BY:	DATE:	S1-11
1			3			TOTAL SHEETS
2			4			36

DRAWN BY: MAL DATE: 11/2016
 CHECKED BY: JMR DATE: 11/2016
 DESIGN ENGINEER OF RECORD: MAL DATE: 11/2016

DOCUMENT NOT CONSIDERED FINAL UNLESS ALL SIGNATURES COMPLETED