

I HEREBY CERTIFY THESE PLANS ARE THE AS-BUILT PLANS

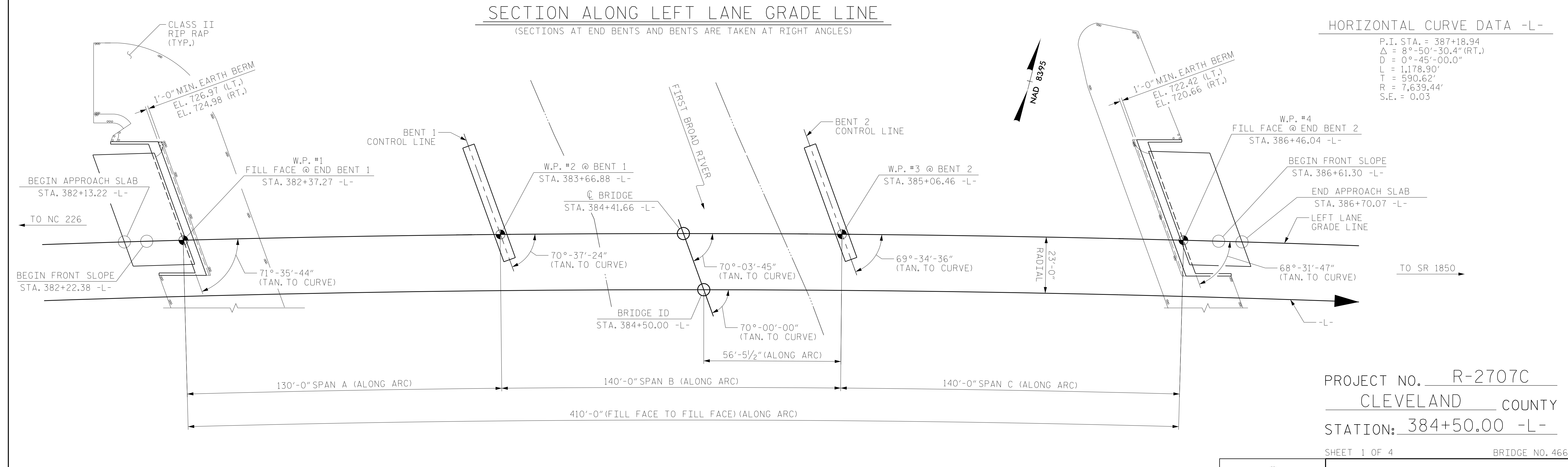

HORIZONTAL CURVE DATA -L-

P.I. STA. = 387+18.94
 $\Delta = 8^\circ-50'-30.4''$ (RT.)
 $D = 0^\circ-45'-00.0''$
 $L = 1,178.90'$
 $T = 590.62'$
 $R = 7,639.44'$
 $S.E. = 0.03$

PLAN ALONG LEFT LANE GRADE LINE
 (FOR CLARITY, PILES & COLUMNS ARE NOT SHOWN IN PLAN VIEW)

PROJECT NO. R-2707C
CLEVELAND COUNTY
 STATION: 384+50.00 -L-
 SHEET 1 OF 4 BRIDGE NO. 466

DRAWN BY :	MAL	DATE :	11/2016
CHECKED BY :	JMR	DATE :	12/2016
DESIGN ENGINEER OF RECORD:	MAL	DATE :	11/2016

DOCUMENT NOT CONSIDERED FINAL UNLESS ALL SIGNATURES COMPLETED

RS&H
 RS&H Architects-Engineers-Planners, Inc.
 8601 Six Forks Road, Suite 260
 919-926-4100 FAX 919-846-9080
 www.rsandh.com
 North Carolina License No. 50737-F-0403-C-28

STATE OF NORTH CAROLINA DEPARTMENT OF TRANSPORTATION RALEIGH					
GENERAL DRAWING LEFT LANE BRIDGE OVER FIRST BROAD RIVER ON US 74 SHELBY BYPASS BETWEEN NC 226 AND SR 1850					
REVISIONS					
NO.	BY:	DATE:	NO.	BY:	DATE:
1			3		
2			4		
SHEET NO.					S1-1
TOTAL SHEETS					36