

PROJECT REFERENCE NO.	SHEET NO.
R-2707C	EC-53/CONST.13
RW SHEET NO.	
ROADWAY DESIGN ENGINEER	HYDRAULICS ENGINEER

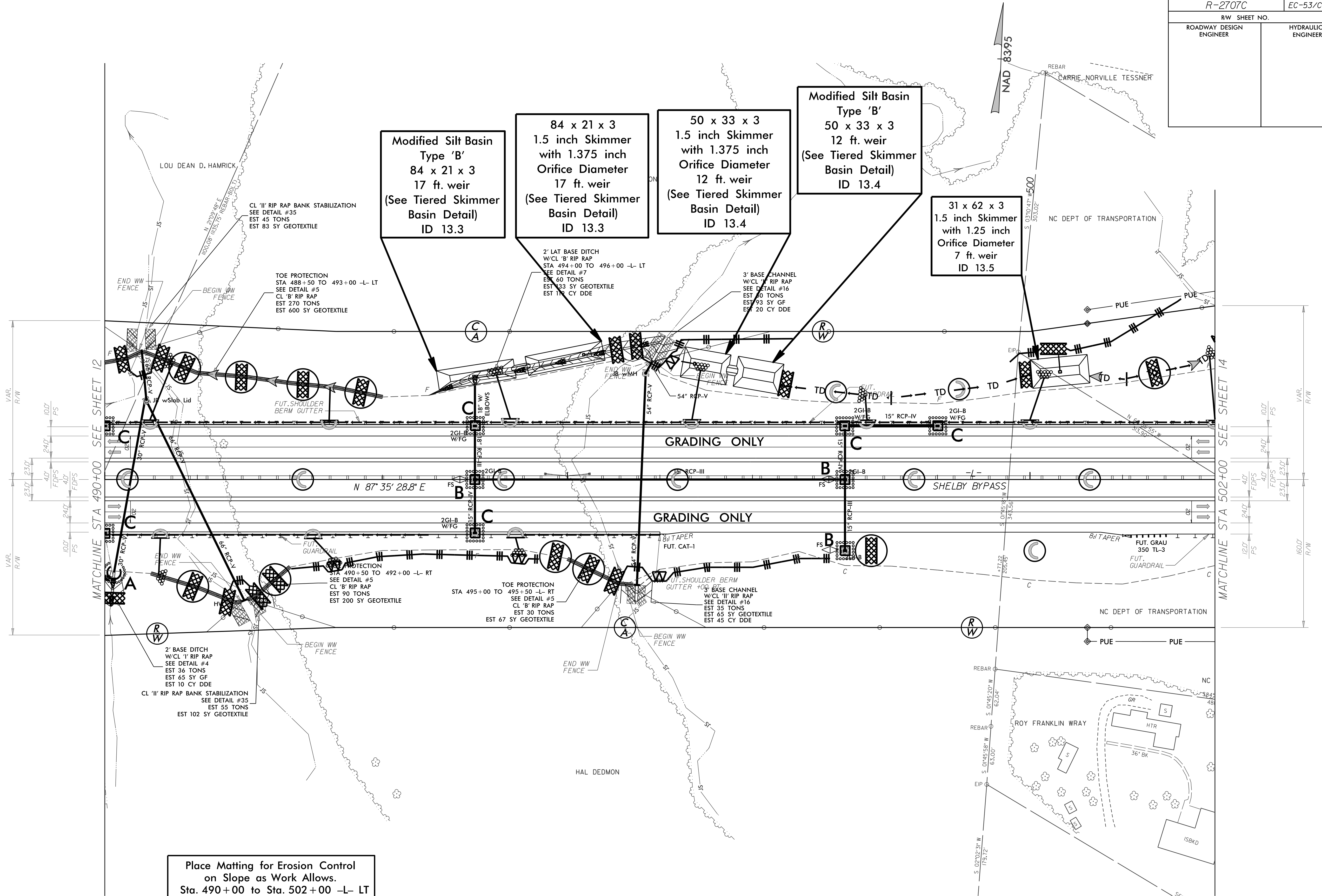

**Modified Silt Basin
Type 'B'
84 x 21 x 3
17 ft. weir
(See Tiered Skimmer
Basin Detail)
ID 13.3**

**84 x 21 x 3
1.5 inch Skimmer
with 1.375 inch
Orifice Diameter
17 ft. weir
(See Tiered Skimmer
Basin Detail)
ID 13.3**

**50 x 33 x 3
1.5 inch Skimmer
with 1.375 inch
Orifice Diameter
12 ft. weir
(See Tiered Skimmer
Basin Detail)
ID 13.4**

**Modified Silt Basin
Type 'B'
50 x 33 x 3
12 ft. weir
(See Tiered Skimmer
Basin Detail)
ID 13.4**

**31 x 62 x 3
1.5 inch Skimmer
with 1.25 inch
Orifice Diameter
7 ft. weir
ID 13.5**

**Place Matting for Erosion Control
on Slope as Work Allows.
Sta. 490+00 to Sta. 502+00 -L- LT
Sta. 490+00 to Sta. 496+50 -L- RT
Sta. 499+50 to Sta. 501+50 -L- RT**