

NO.	DESCRIPTION

PROJECT REFERENCE NO. R-2707C	SHEET NO. EC-22/CONV-22
REV. SHEET NO.	HYDRAULICS ENGINEER
ROADWAY DESIGN ENGINEER	

CLEARING AND GRUBBING BIDDING CONTROL FOR CONSTRUCTION SHEET 22

TRAFFIC DIAGRAM

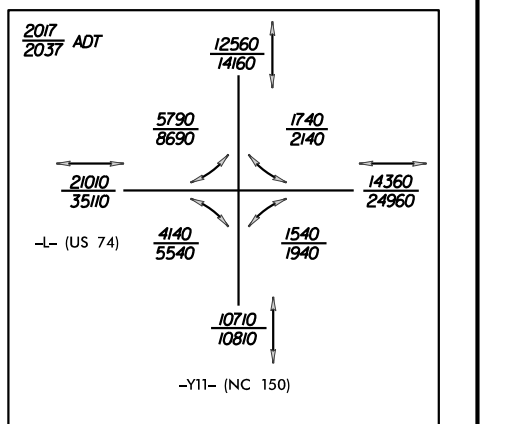

CLEAN WATER DIVERSION

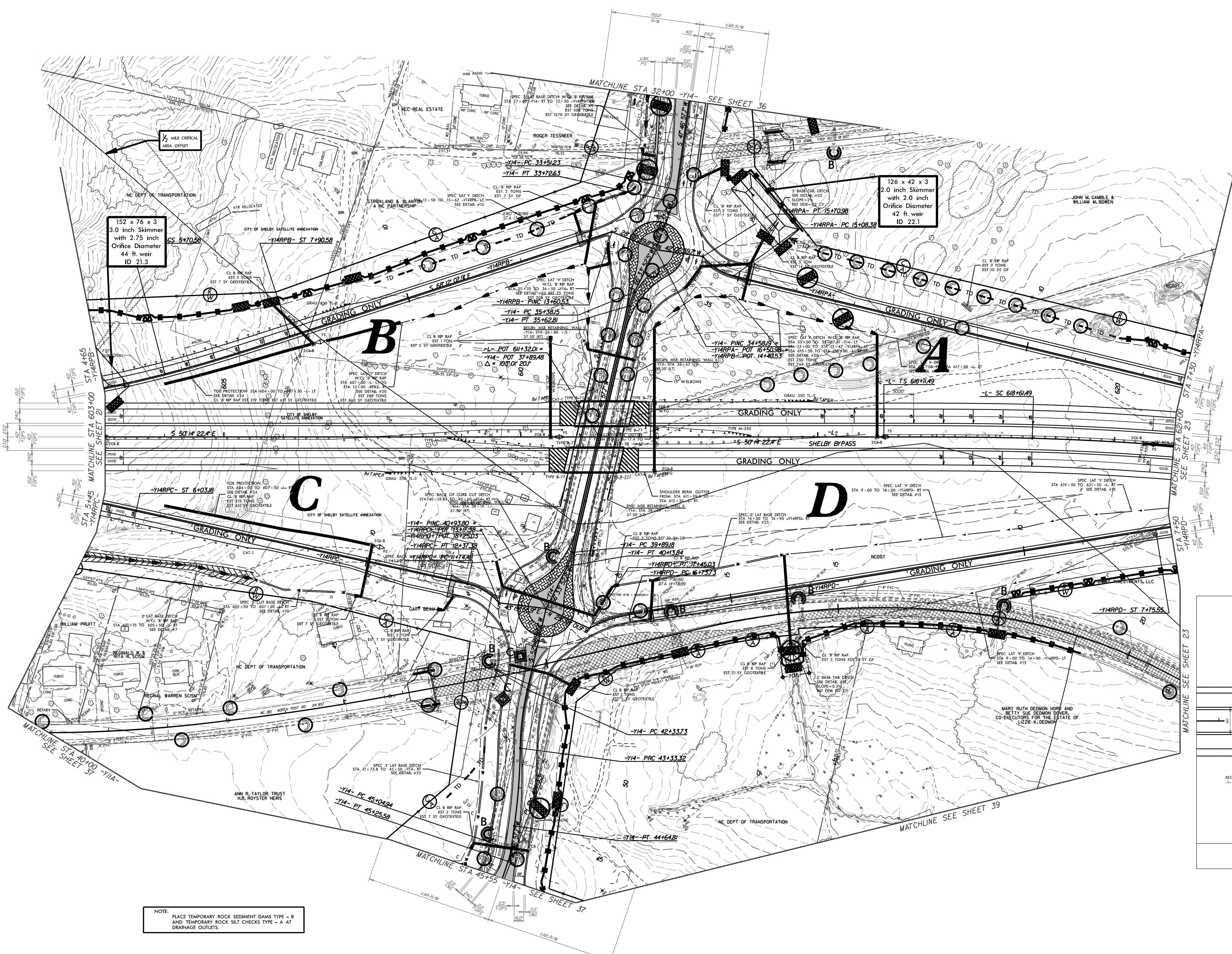
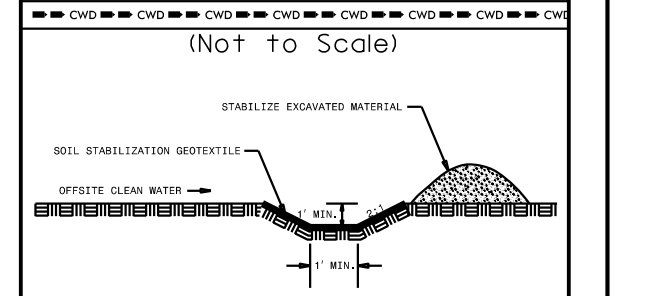

NOTE: PLACE TEMPORARY ROCK SEDIMENT DAMS TYPE - B AND TEMPORARY ROCK SILT CHECKS TYPE - A AT DRAINAGE OUTLETS.

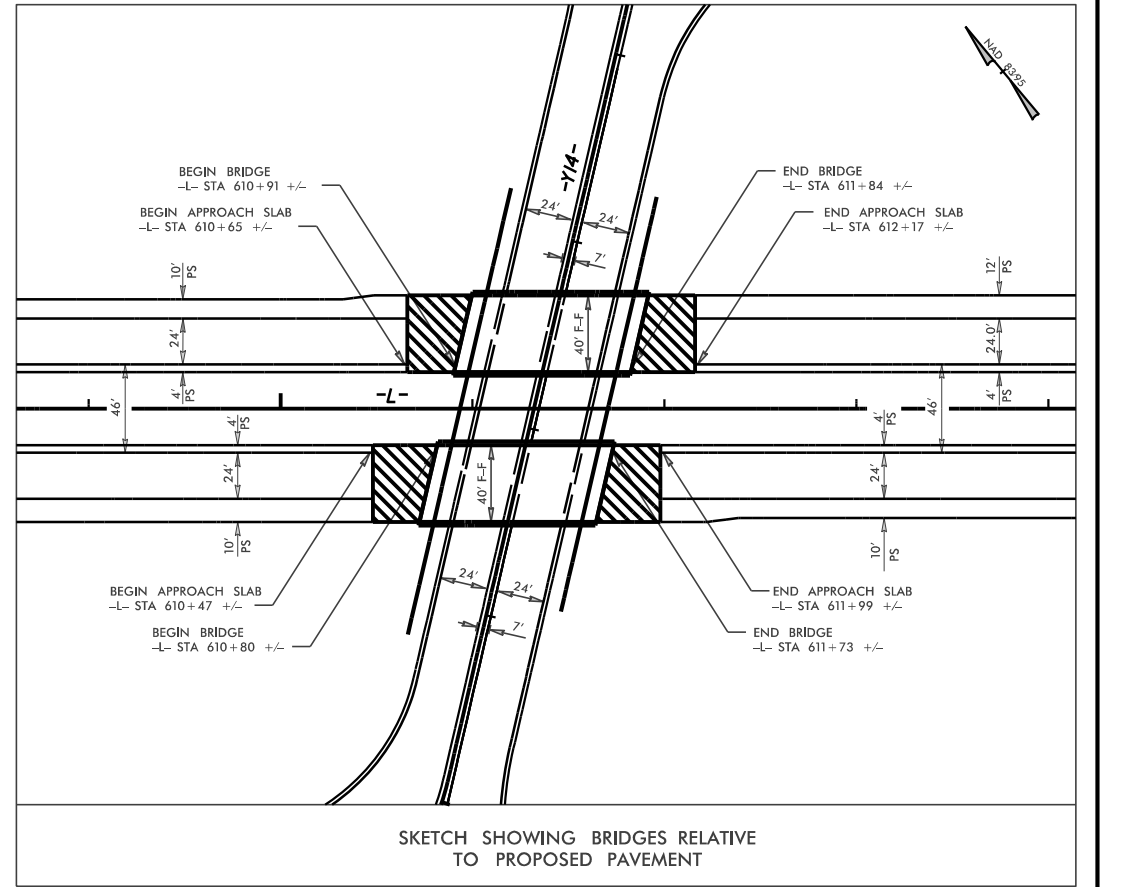

FOR ROUNDABOUT DETAILS SEE SHEETS 28-5 & 28-6
 FOR -L- PROFILE SEE SHEET 54
 FOR -Y14- PROFILE SEE SHEET 69
 FOR -Y14RPA- PROFILE SEE SHEET 71
 FOR -Y14RFB- PROFILE SEE SHEET 72
 FOR -Y14RFB- PROFILE SEE SHEET 73
 FOR -Y14RFB- PROFILE SEE SHEETS 73 & 74

GRAPHIC SCALE 50 25 0 50 100 PLANS	LOCATION: INTERCHANGE AT -L- US 74 BYPASS AND -Y14- NC 150
DESIGNED BY: T. HUFFMAN	COUNTY: CLEVELAND
CHECKED BY: T. REID	DATE: 7/7/15