

PROJECT REFERENCE NO. <b>R-2707C</b>	SHEET NO. <b>EC-20/CONST.20</b>
RW SHEET NO. <b>ROADWAY DESIGN ENGINEER</b>	HYDRAULICS ENGINEER

**CLEARING AND GRUBBING  
EROSION CONTROL FOR  
CONSTRUCTION SHEET 20**

**REVISIONS**  
CONST. REV ON LET PROJECT 5-30-19 (TEH) - REVISED -L- FROM GRADING ONLY TO PAVING, ADDED NOISE WALL 7 AND SINGLE FACED BARRIER ALONG -L- (RT)  
CONST. REV ON LET PROJECT 5-30-19 (TEH) - REVISED -L- FROM GRADING ONLY TO PAVING, ADDED NOISE WALL 7 AND SINGLE FACED BARRIER ALONG -L- (RT)  
CONST. REV 04/XX/2021-REMOVED -YIO- ALIGNMENT AND ADDED -YIOREV- AND BRIDGE REMOVED NOISE WALL ON -L- RIGHT AND ADJUSTED DRAINAGE TO THE PLANS ACCORDINGLY. MODIFIED AND ADDED RW AND EASEMENT LIMITS ON -YIOREV- AND -L- ADDED 2 CLAIMS TO PARCELS 626,65 AND ADDED PARCEL 140,111

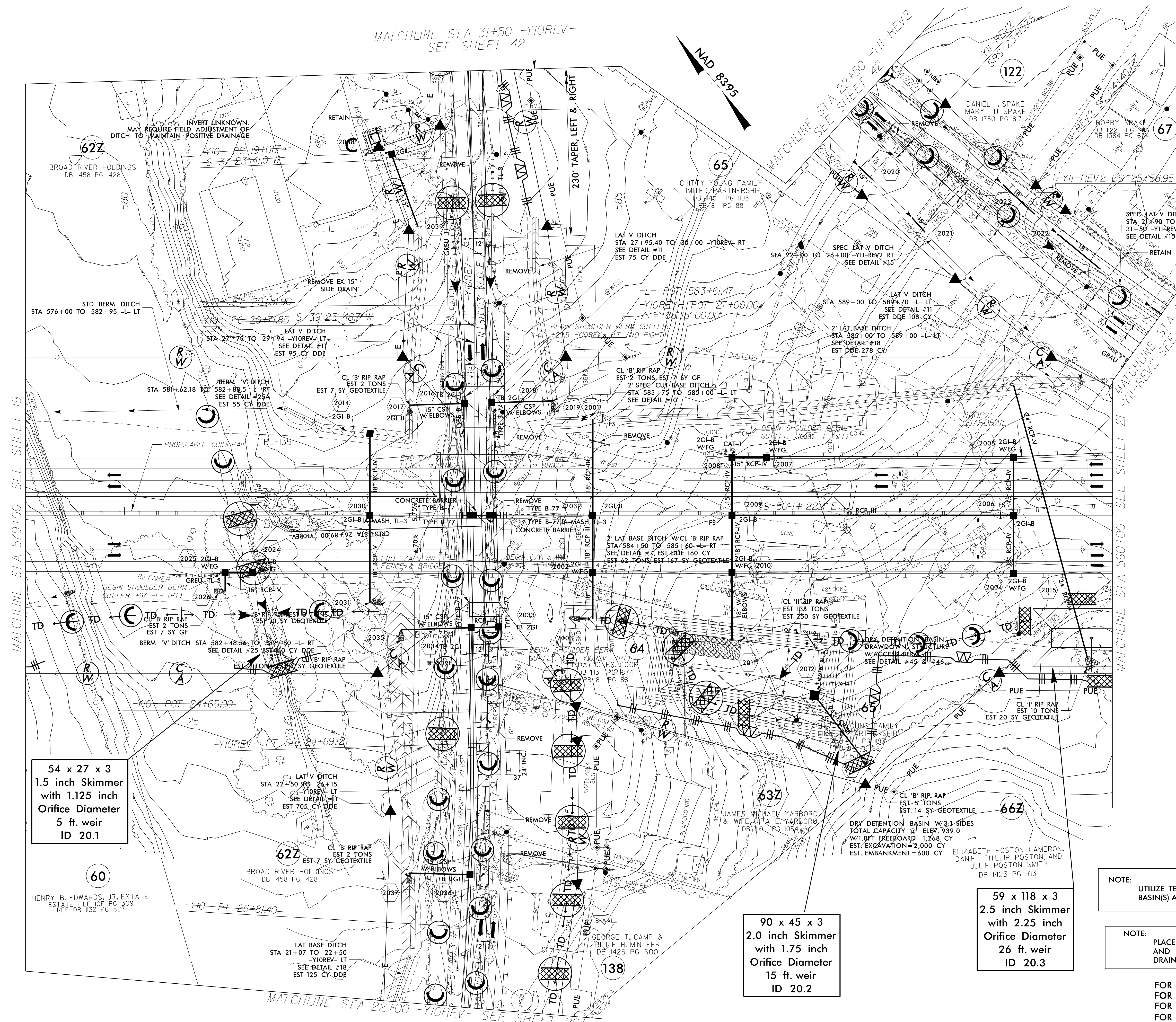

**54 x 27 x 3  
1.5 inch Skimmer  
with 1.125 inch  
Orifice Diameter  
5 ft. weir  
ID 20.1**

**90 x 45 x 3  
2.0 inch Skimmer  
with 1.75 inch  
Orifice Diameter  
15 ft. weir  
ID 20.2**

**59 x 118 x 3  
2.5 inch Skimmer  
with 2.25 inch  
Orifice Diameter  
26 ft. weir  
ID 20.3**

**NOTE:**  
UTILIZE TEMPORARY SEDIMENT BASIN OR SPECIAL STILLING BASIN(S) AS STILLING BASIN WHERE APPLICABLE.

**NOTE:**  
PLACE TEMPORARY ROCK SEDIMENT DAMS TYPE - B AND TEMPORARY ROCK SILT CHECKS TYPE - A AT DRAINAGE OUTLETS.

FOR DITCH DETAILS SEE SHEETS 2D-1 AND 2D-2  
FOR -L- PROFILE SEE SHEET 52  
FOR -Y11-REV2 PROFILE SEE SHEET 66  
FOR -YIOREV- PROFILE SEE SHEET 78