

1@9'X7' RCBC + 66" RCP CONSTRUCTION SEQUENCE

STA. 553+27 -L- & STA. 554+45 -L-

HICKORY CREEK & UT TO HICKORY CREEK

PROJECT REFERENCE NO. R-2707C	SHEET NO. EC-17A/CONST.17
ROADWAY DESIGN ENGINEER	HYDRAULICS ENGINEER

PHASE I

- 1.) CONSTRUCT SKIMMER BASIN 18.1.
- 2.) CONSTRUCT TEMPORARY CHANNEL CHANGE WITH LINER #1 AND #2 (SEE DETAIL).
- 3.) INSTALL IMPERVIOUS DIKES #1 AND #2 AND DIVERT FLOW THROUGH TEMPORARY CHANNEL CHANGES.
- 4.) INSTALL TEMPORARY 24" FLEXIBLE PIPE #1, IMPERVIOUS DIKE #3 AND IMPERVIOUS DIKE #4.
- 5.) DEWATER CONSTRUCTION AREA, UTILIZING SKIMMER BASIN 18.1 FOR PUMPED EFFLUENT.
- 6.) CONSTRUCT PROPOSED 1@9'x7' RCBC, WING WALLS AND OUTLET CHANNEL IN ACCORDANCE WITH THE PLANS.
- 7.) CONSTRUCT 66" RCP, HEADWALL, INLET BANK STABILIZATION AND OUTLET CHANNEL IN ACCORDANCE WITH THE PLANS.
- 8.) REMOVE TEMPORARY CHANNELS #1 AND #2, IMPERVIOUS DIKES #1, #2, #3 AND #4, TEMPORARY PIPE #1, AND DIRECT FLOW THROUGH 1@9'X7' RCBC AND 66" RCP.

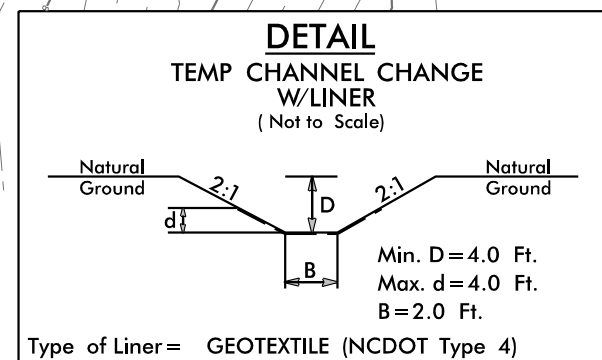
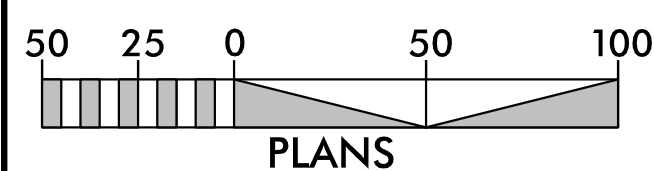
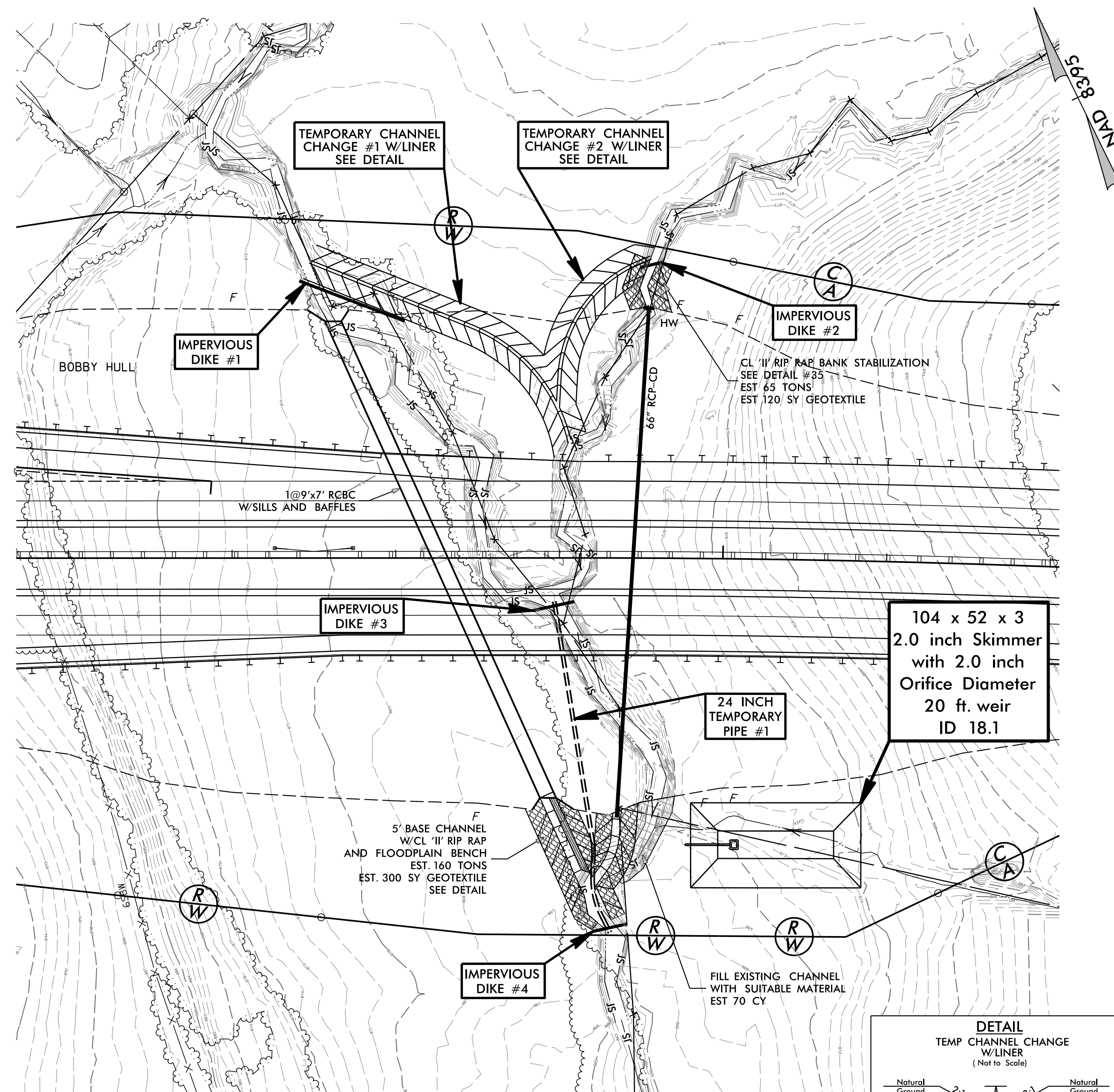

PHASE II

- 1.) INSTALL IMPERVIOUS DIKES #5, TEMPORARY 18" FLEXIBLE PIPE #2 AND IMPERVIOUS DIKE #6..
- 2.) CONSTRUCT INLET BANK STABILIZATION, FLOODPLAIN BENCH AND FILL EXISTING CHANNELS WITH SUITABLE MATERIAL.
- 3.) REMOVE IMPERVIOUS DIKES #5 AND #6, AND TEMPORARY 18" FLEXIBLE PIPE #2.
- 4.) COMPLETE ROADWAY

