

TEMPORARY PAVEMENT MARKING LEGEND	
(PA)	PAINT - WHITE EDGELINE - (4")
(PI)	PAINT - YELLOW DOUBLE CENTER - (4")
(PP)	PAINT - YELLOW DIAGONAL - (8")

REFER TO RSD NOS. 1205.01, 1205.02, 1205.05, 1205.09, 1250.01, AND 1251.01 FOR PLACEMENT OF TEMPORARY PAVEMENT MARKINGS AND MARKERS UNLESS NOTED OTHERWISE.

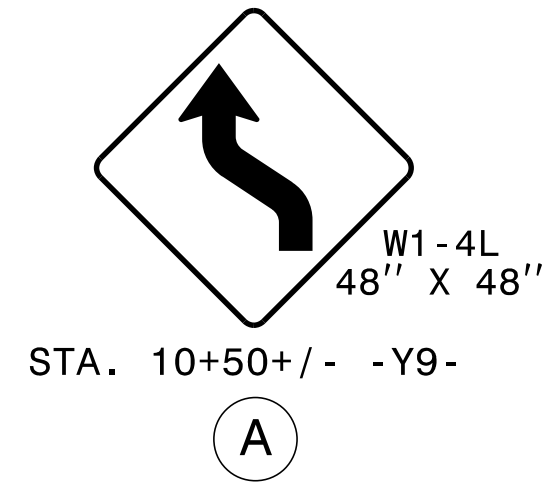
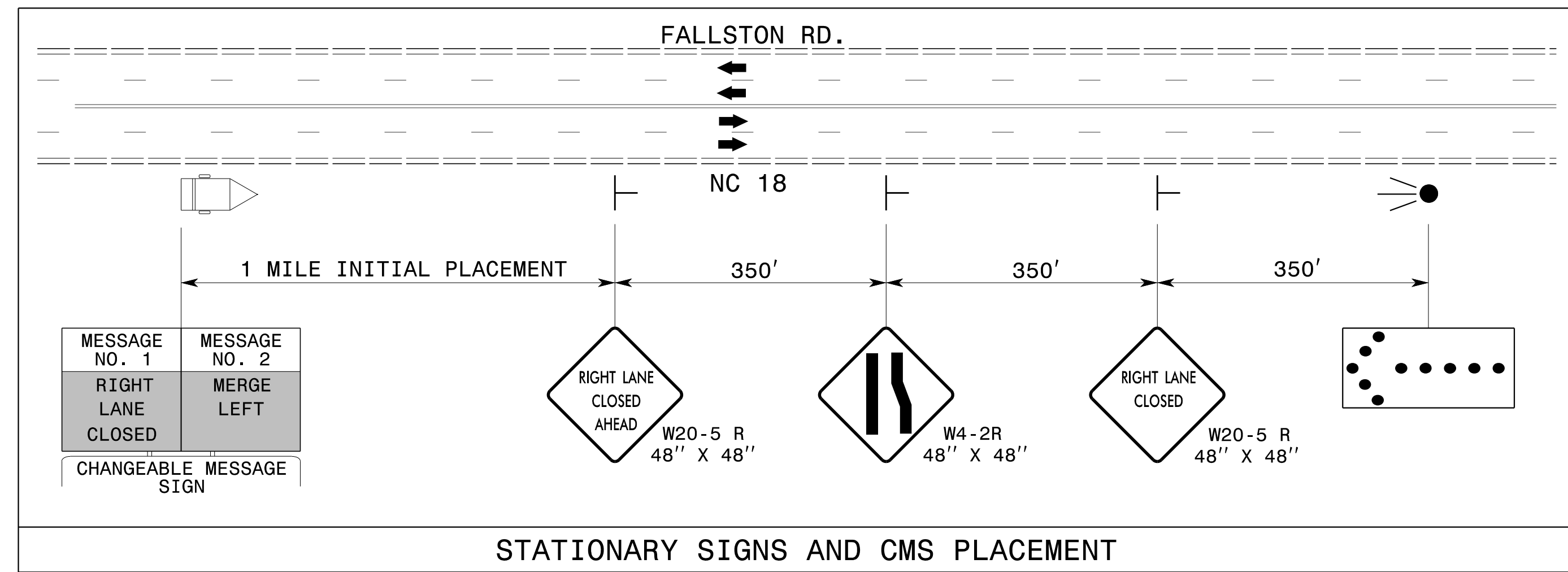
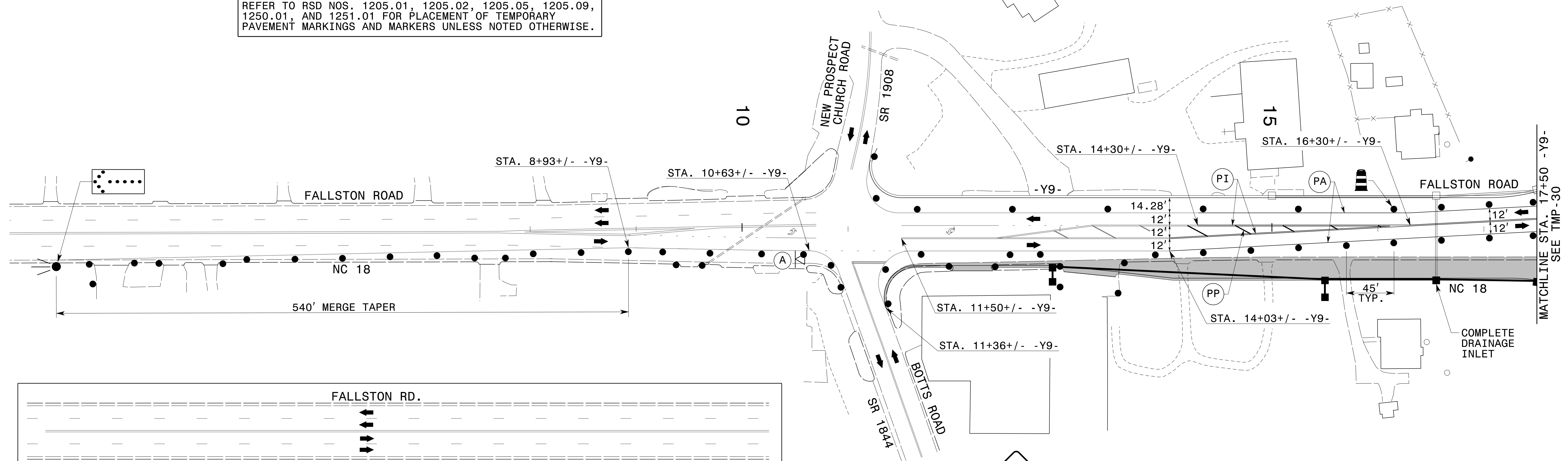

2/16/2017  
 P:\TIP\Projects-R\2707C\TrafficControl\TCP\SITE\_5\SR2707C\_TC\_SITE5\_PH3\_TMP29.dgn  
 User:scodts

APPROVED: *Don A. Parker*  
 DATE: 2/16/2017

SEAL  
 043251  
 ENGINEER  
 DON A. PARKER

DOCUMENT NOT CONSIDERED FINAL  
 UNLESS ALL SIGNATURES COMPLETED

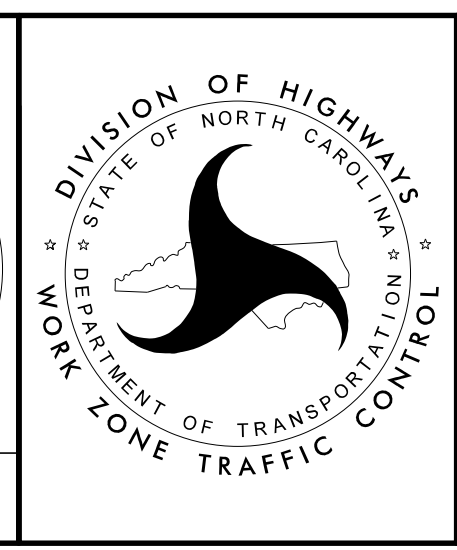

SITE 5  
 PHASE III DETAILS  
 FALLSTON ROAD  
 NC 18  
 (-Y9-)