

TEMPORARY PAVEMENT MARKING LEGEND

(PA)	PAINT - WHITE EDGELINE - (4")
(PD)	PAINT - 3 FT. WHITE MINISKIP - (4")
(PE)	PAINT - WHITE SOLID LANE LINE - (4")
(PI)	PAINT - YELLOW DOUBLE CENTER - (4")
(PP)	PAINT - YELLOW DIAGONAL - (8")
(P2)	PAINT - WHITE STOP BAR - (24")
(QA)	PAINT - LEFT TURN ARROW - ↶

REFER TO RSD NOS. 1205.01, 1205.02, 1205.05, 1205.08, 1205.09, 1250.01, AND 1251.01 FOR PLACEMENT OF TEMPORARY PAVEMENT MARKINGS AND MARKERS UNLESS NOTED OTHERWISE.

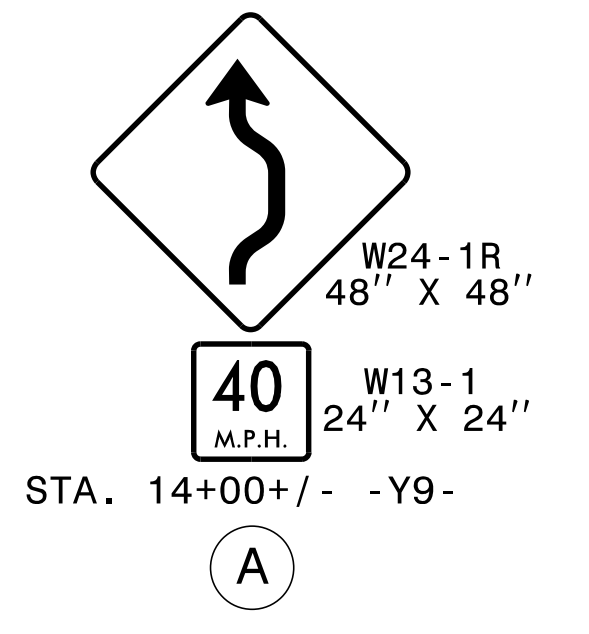
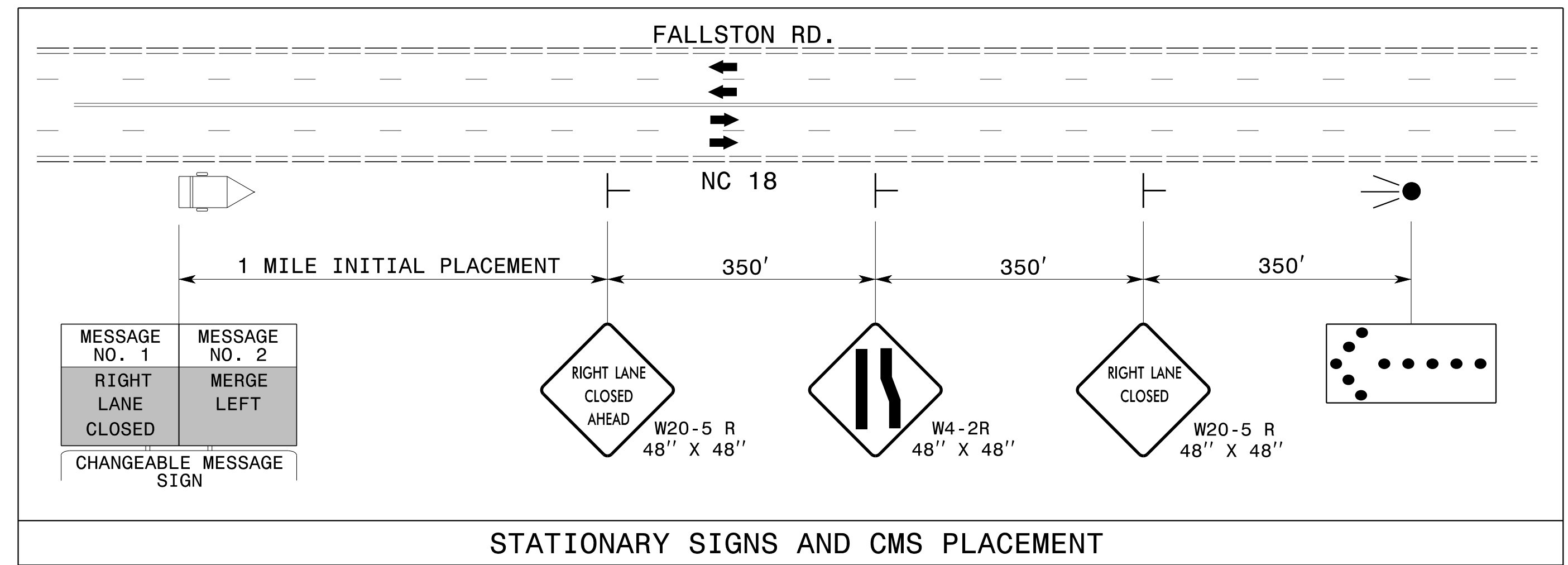
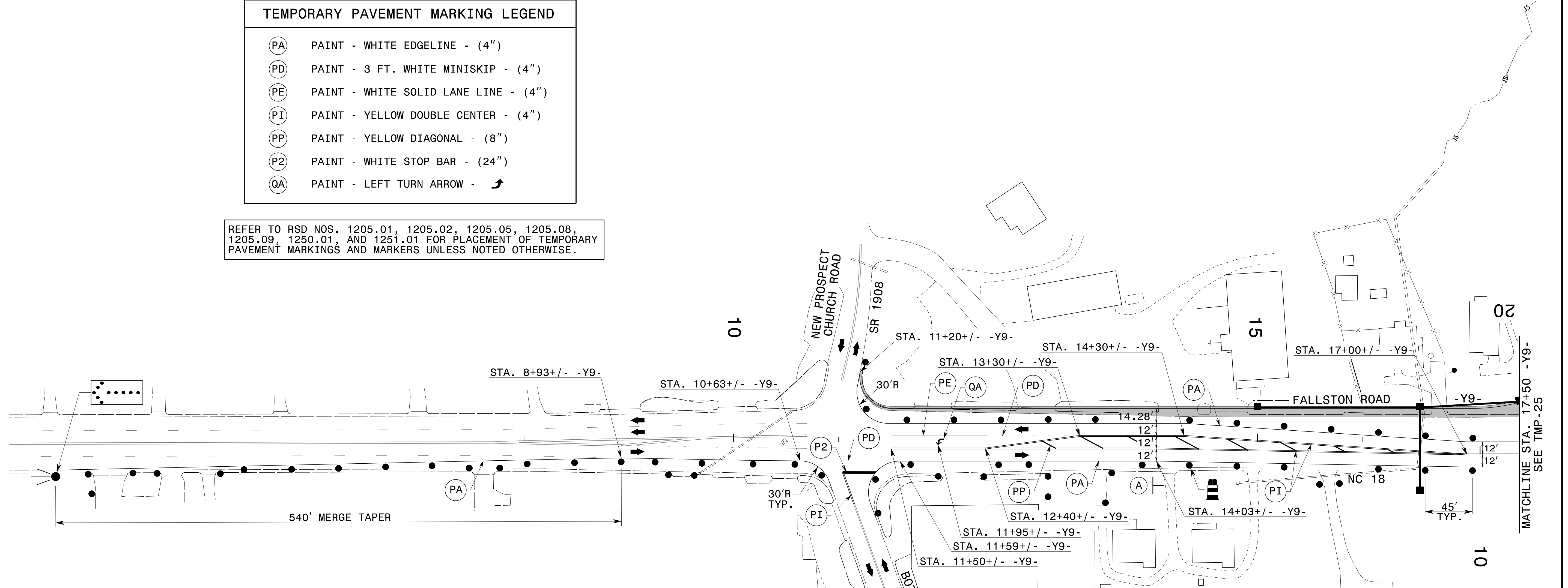

2/16/2017
 P:\TIP\Projects-R\2707C\TrafficControl\TCP\SITE_5\SR2707C_TC_SITE5_PH2_TMP24.dgn
 User:scodts

APPROVED: *Don A. Parker*
 DATE: 2/16/2017

**DOCUMENT NOT CONSIDERED FINAL
 UNLESS ALL SIGNATURES COMPLETED**

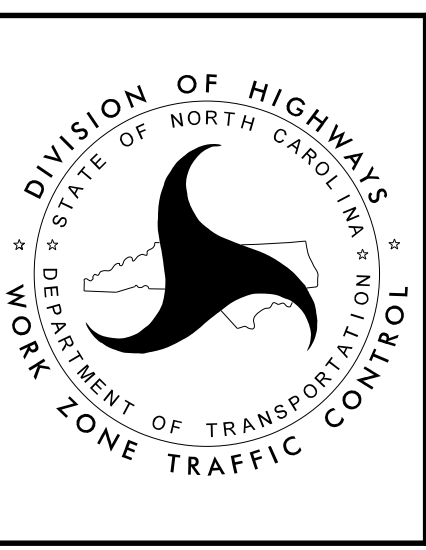

**SITE 5
 PHASE II DETAILS
 FALLSTON ROAD
 NC 18
 (-Y9-)**