

NO.	REVISIONS

PROJECT REFERENCE NO. R-2707C SHEET NO. 22

R/W SHEET NO. 22

ROADWAY DESIGN ENGINEER

HYDRAULICS ENGINEER

DocuSigned by
 Timothy R. Reid
 4/12/2017

DOCUMENT NOT CONSIDERED FINAL UNLESS ALL SIGNATURES COMPLETED

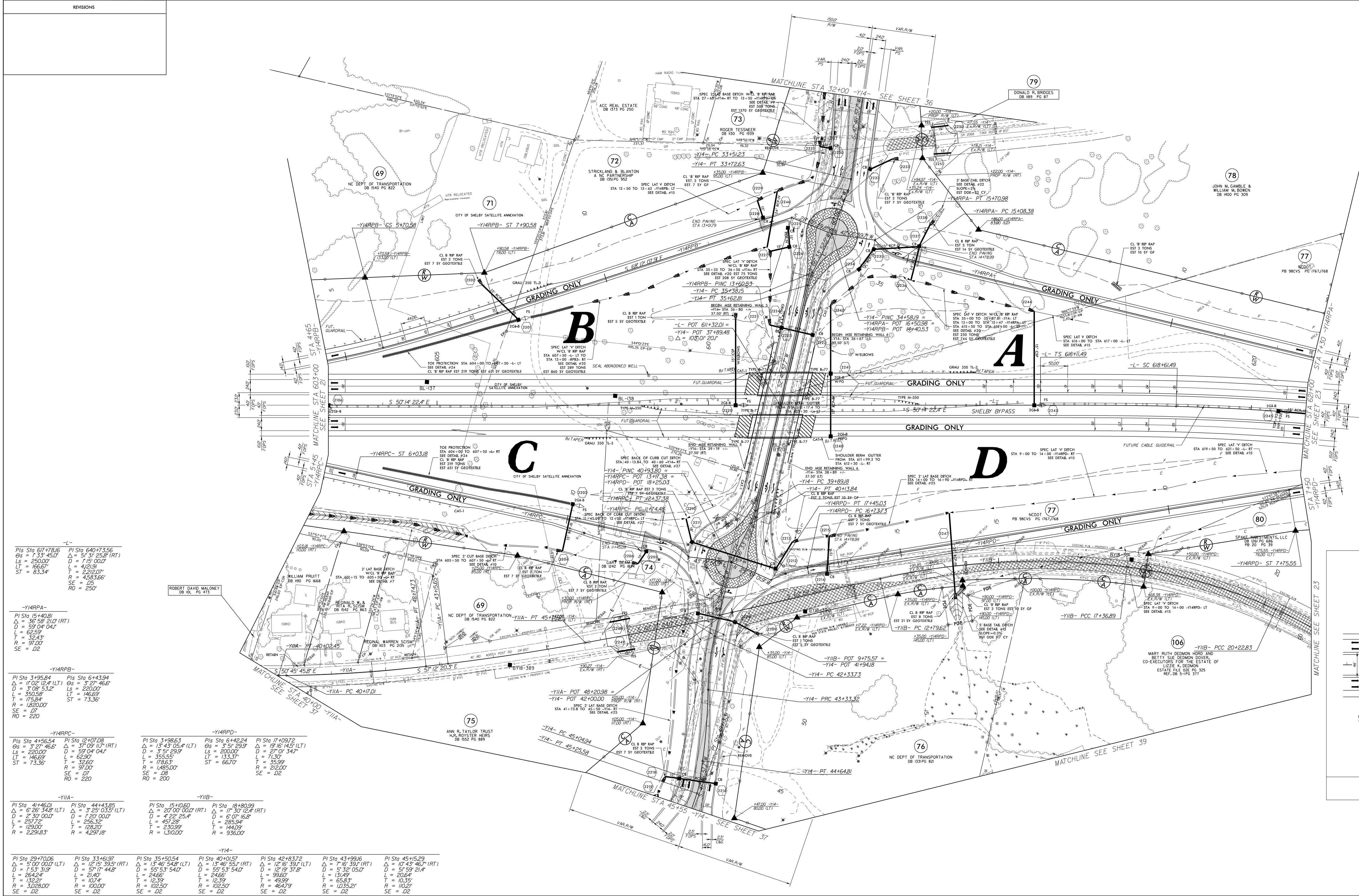
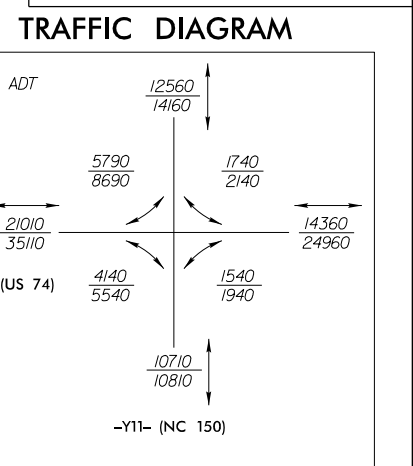

<p>PI Stn 617+78.16 Δ = 133° 45' 07" L = 250.00' LT = 166.67' ST = 83.34'</p>	<p>PI Stn 640+73.56 Δ = 57° 31' 25.8" (RT) D = 715.000' L = 4.0131' T = 23.037' R = 4583.66' SE = .05 RD = 220'</p>
<p>PI Stn 15+40.81 Δ = 36° 58' 20.7" (RT) D = 591.041' L = 62.59' T = 32.841' R = 37.00' SE = .02</p>	<p>PI Stn 644+39.94 Δ = 102° 12' 01.1" (RT) D = 591.041' L = 62.59' T = 32.841' R = 37.00' SE = .02</p>
<p>PI Stn 3+95.84 Δ = 102° 12' 01.1" (RT) D = 591.041' L = 62.59' T = 32.841' R = 37.00' SE = .02</p>	<p>PI Stn 644+39.94 Δ = 102° 12' 01.1" (RT) D = 591.041' L = 62.59' T = 32.841' R = 37.00' SE = .02</p>
<p>PI Stn 45+56.54 Δ = 37° 09' 11.7" (RT) D = 230.00' L = 146.65' ST = 73.36'</p>	<p>PI Stn 12+07.08 Δ = 37° 09' 11.7" (RT) D = 230.00' L = 146.65' ST = 73.36'</p>
<p>PI Stn 3+95.84 Δ = 13° 43' 05.4" (LT) D = 137.46551' (RT) Δ = 137° 46' 55.1" (RT) D = 137.46551' (RT) Δ = 137° 46' 55.1" (RT) D = 137.46551' (RT)</p>	<p>PI Stn 6+42.24 Δ = 13° 43' 05.4" (LT) D = 137.46551' (RT) Δ = 137° 46' 55.1" (RT) D = 137.46551' (RT) Δ = 137° 46' 55.1" (RT) D = 137.46551' (RT)</p>
<p>PI Stn 41+46.01 Δ = 6° 26' 54.8" (LT) D = 230.00' L = 257.72' T = 129.09' R = 229.83'</p>	<p>PI Stn 44+43.85 Δ = 3° 25' 03.5" (LT) D = 230.00' L = 257.72' T = 129.09' R = 229.83'</p>
<p>PI Stn 29+70.06 Δ = 57° 01' 00.0" (LT) D = 75.3139' L = 264.94' T = 132.21' R = 302.800' SE = .02</p>	<p>PI Stn 33+46.97 Δ = 57° 01' 00.0" (LT) D = 75.3139' L = 264.94' T = 132.21' R = 302.800' SE = .02</p>
<p>PI Stn 35+50.54 Δ = 15° 46' 54.8" (LT) D = 137.46551' (RT) Δ = 15° 46' 54.8" (LT) D = 137.46551' (RT) Δ = 15° 46' 54.8" (LT) D = 137.46551' (RT)</p>	<p>PI Stn 40+10.57 Δ = 15° 46' 54.8" (LT) D = 137.46551' (RT) Δ = 15° 46' 54.8" (LT) D = 137.46551' (RT) Δ = 15° 46' 54.8" (LT) D = 137.46551' (RT)</p>
<p>PI Stn 42+83.72 Δ = 17° 16' 59.1" (RT) D = 127.19378' L = 134.69' T = 12.39' R = 464.79'</p>	<p>PI Stn 45+19.96 Δ = 17° 16' 59.1" (RT) D = 127.19378' L = 134.69' T = 12.39' R = 464.79'</p>
<p>PI Stn 45+19.96 Δ = 57° 59' 21.4" (RT) D = 206.64' L = 134.69' T = 10.35' R = 102.50'</p>	<p>PI Stn 45+19.96 Δ = 57° 59' 21.4" (RT) D = 206.64' L = 134.69' T = 10.35' R = 102.50'</p>

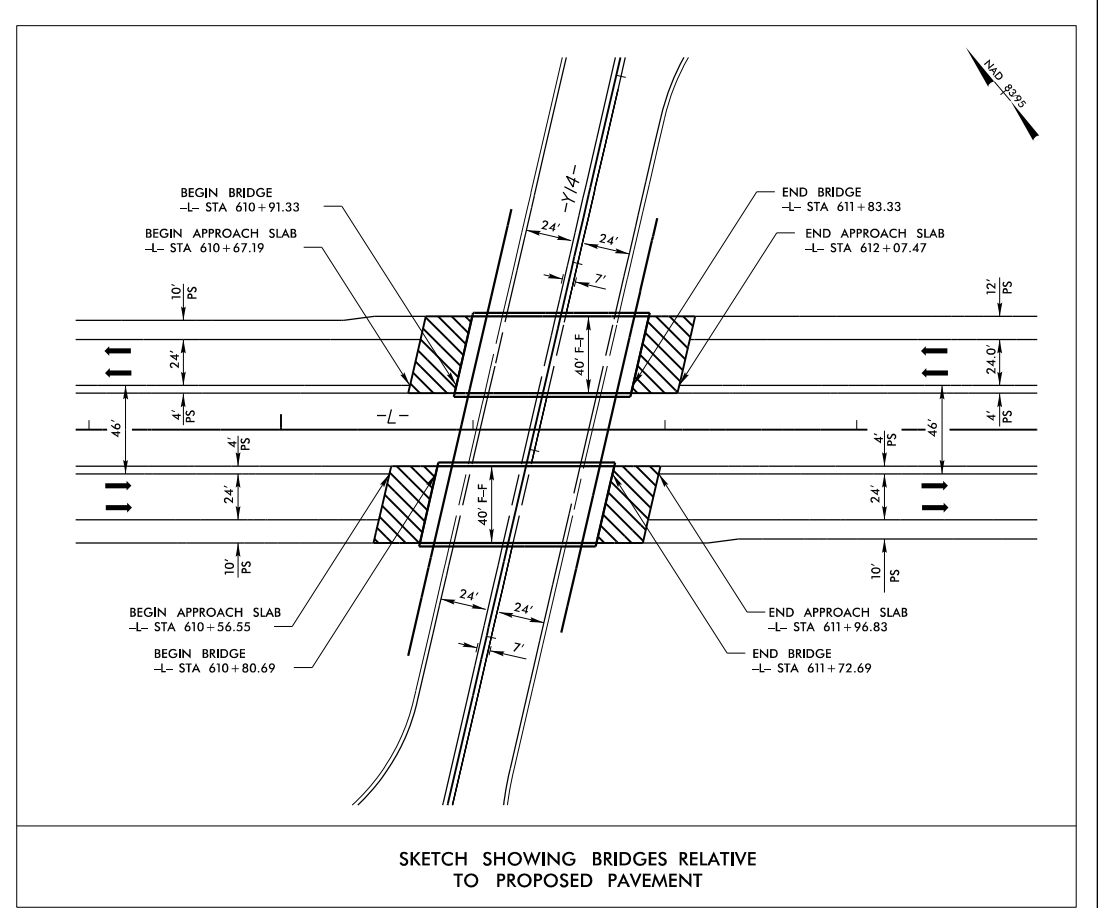

FOR DITCH DETAILS SEE SHEETS 2D-1 AND 2D-2
 FOR ROUNDABOUT DETAILS SEE SHEETS 2B-5 & 2B-6
 FOR -114- PROFILE SEE SHEET 69
 FOR -114RPA- PROFILE SEE SHEET 71
 FOR -114RFB- PROFILE SEE SHEET 72
 FOR -114RPC- PROFILE SEE SHEET 73
 FOR -114RPD- PROFILE SEE SHEETS 73 & 74
 FOR STRUCTURE PLANS SEE

LOCATION: INTERCHANGE AT
 -L- US 74 BYPASS
 AND -Y14- NC 150

TRIP NO. R-2707C COUNTY CLEVELAND

DESIGNED BY T. HUFFMAN

CHECKED BY T. REID DATE 7/7/15

GRAPHIC SCALE
 50 25 0 50 100
 PLANS