

PROJECT REFERENCE NO. <i>R-2707C</i>		SHEET NO. <i>18</i>	
RW SHEET NO.			
ROADWAY DESIGN ENGINEER		HYDRAULICS ENGINEER	
<b>DOCUMENT NOT CONSIDERED FINAL UNLESS ALL SIGNATURES COMPLETED</b>			

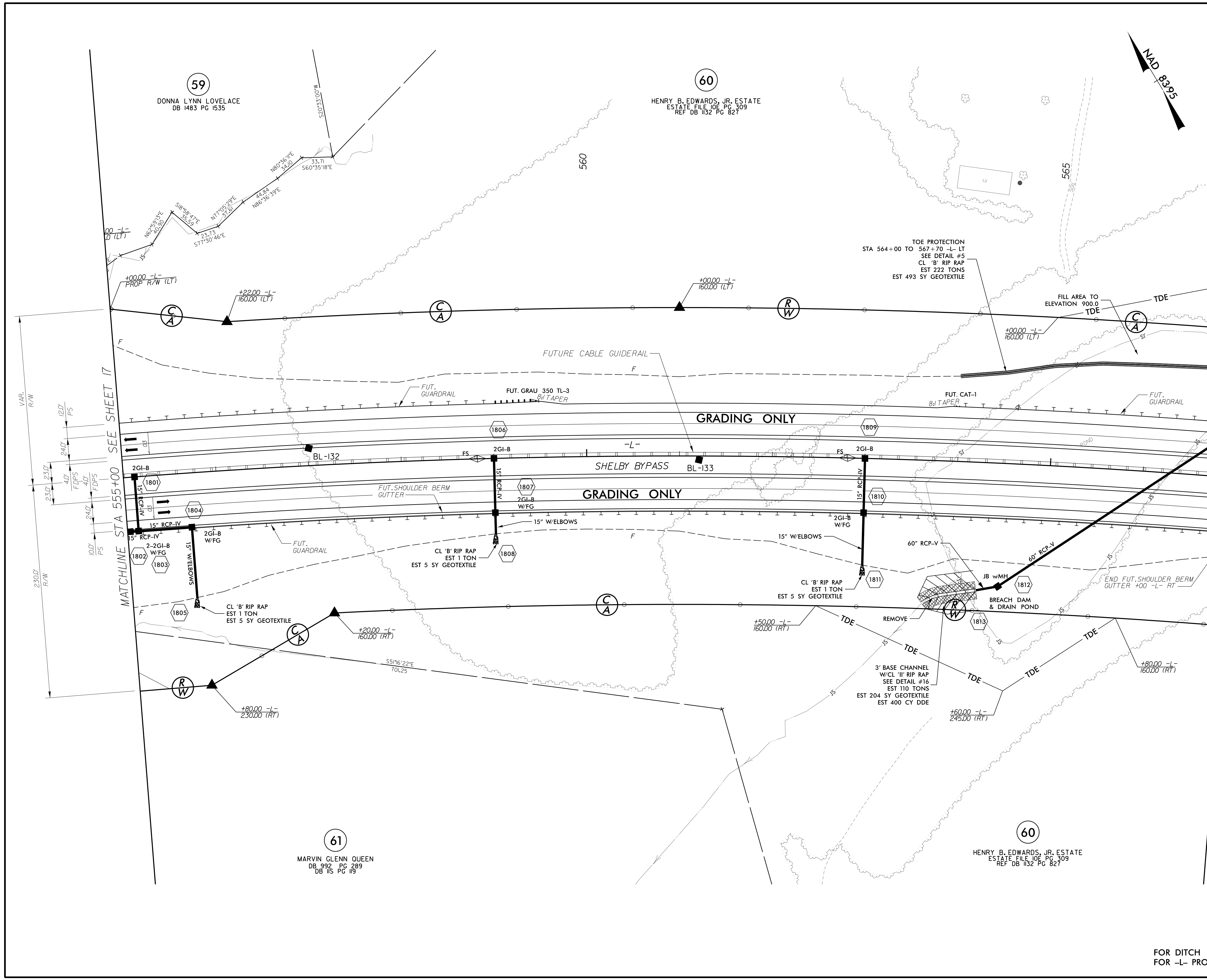

MATCHLINE STA 555+00 SEE SHEET 17

MATCHLINE STA 567+00 SEE SHEET 19

-L-  
 PI Sta 563+32.45  
 $\Delta = 13^{\circ} 44' 47.7''$  (RT)  
 $D = 0^{\circ} 45' 00.0''$   
 $L = 1,832.88'$   
 $T = 920.86'$   
 $R = 7,639.44'$   
 $SE = .03$   
 $RO = 150.00'$

FOR DITCH DETAILS SEE SHEETS 2D-1 AND 2D-2  
 FOR -L- PROFILE SEE SHEET 51