

1/6/2017 8:11:12 AM G:\Projects\2014\U-3109A\Structures\Site 2\Site 2-Str 3 Bridge 435 (NBL)\Drawings\Final\403\_U3109A\_smu\_bm.dgn

**NOTES:**  
 \* RADIAL DIMENSION  
 \*\* DIMENSION MEASURED ALONG NBL WORKLINE

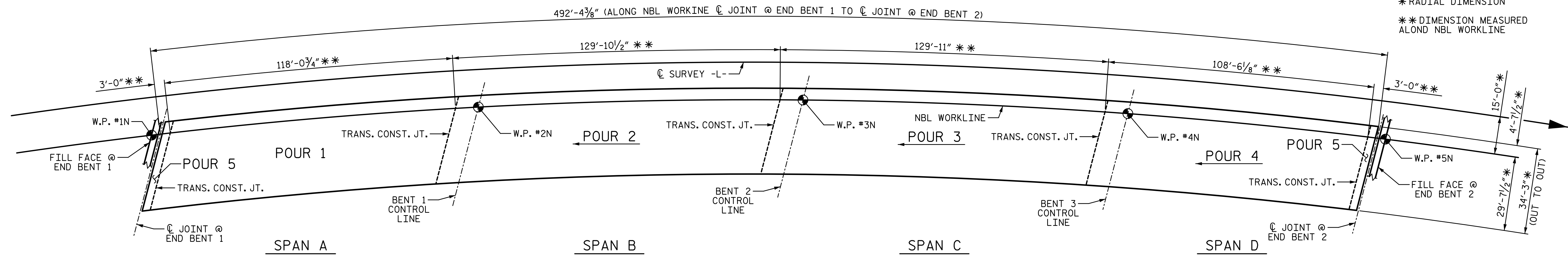

**POUR SEQUENCE AND LAYOUT  
 FOR COMPUTING REINFORCED CONCRETE DECK SLAB AREA**  
 (SQ. FT. = 16,869)

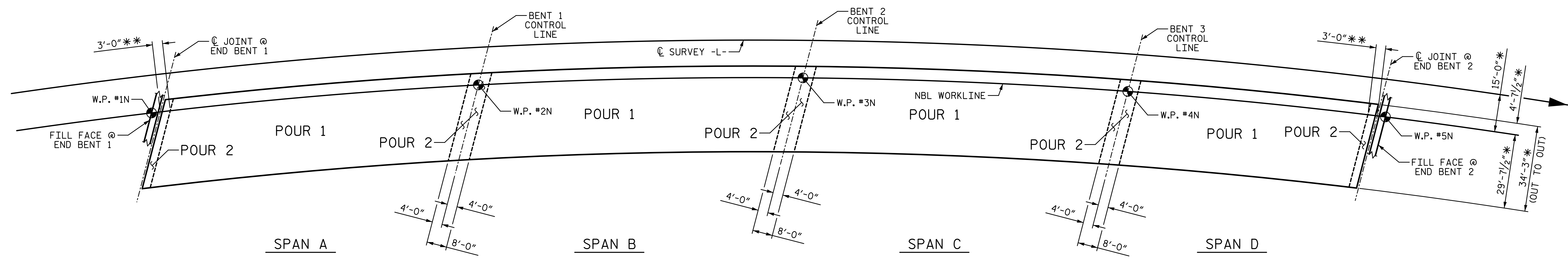

POUR 2 CANNOT BE STARTED UNTIL BOTH ADJACENT POUR 1 HAVE REACHED A MINIMUM COMPRESSIVE STRENGTH OF 3000 PSI.

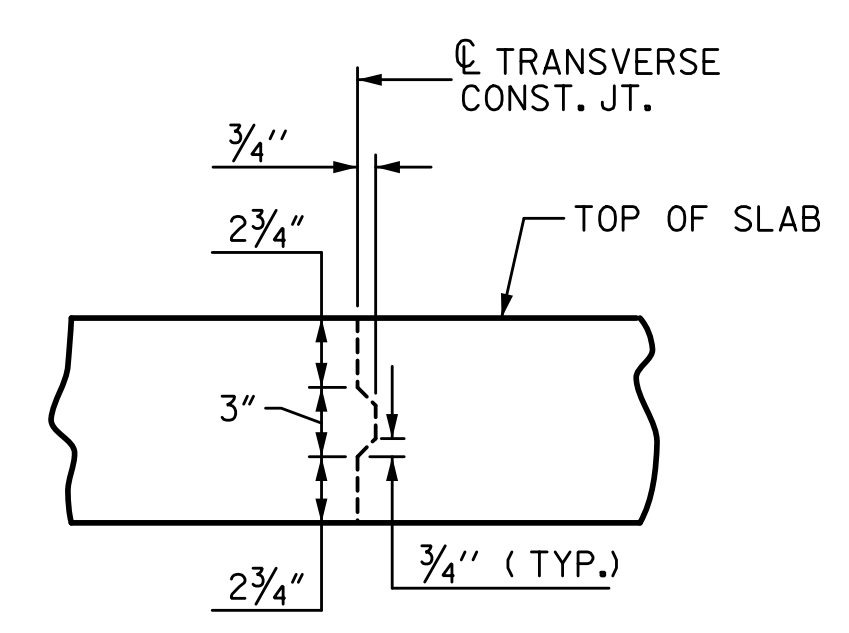

**TRANSVERSE CONSTRUCTION JOINT DETAIL**  
 REINFORCING STEEL IN SLAB NOT SHOWN,  
 LONGITUDINAL REINFORCING STEEL SHALL BE  
 CONTINUOUS THRU JOINT

PROJECT NO. U-3109A  
ALAMANCE COUNTY  
 STATION: 146+61.35 -L-

STATE OF NORTH CAROLINA  
 DEPARTMENT OF TRANSPORTATION  
 RALEIGH  
 SUPERSTRUCTURE

**POUR SEQUENCE**  
 (NBL)

REVISIONS						SHEET NO. S03-34
NO.	BY:	DATE:	NO.	BY:	DATE:	
1			3			TOTAL SHEETS S03-53
2			4			

PLANS PREPARED BY:  
**SIMPSON ENGINEERS & ASSOCIATES**  
 5640 Dillard Drive  
 Suite 200  
 Cary, NC 27518  
 (919) 852-0468  
 (919) 852-0598 (Fax)  
 www.simpsonengr.com  
 LICENSURE NO. C-2521



DRAWN BY: T. BANKOVICH DATE: 9-15  
 CHECKED BY: J.A. BATTS DATE: 9-15  
 DESIGN ENGINEER OF RECORD: J.A. BATTS DATE: 9-15