

1/6/2017 8:11:06 AM G:\Projects\2014\U-3109A\Structures\Site 2\Site 2-Str 3 Bridge 435 (NBL)\Drawings\Final\403\_U3109A\_smu.ps.dgn

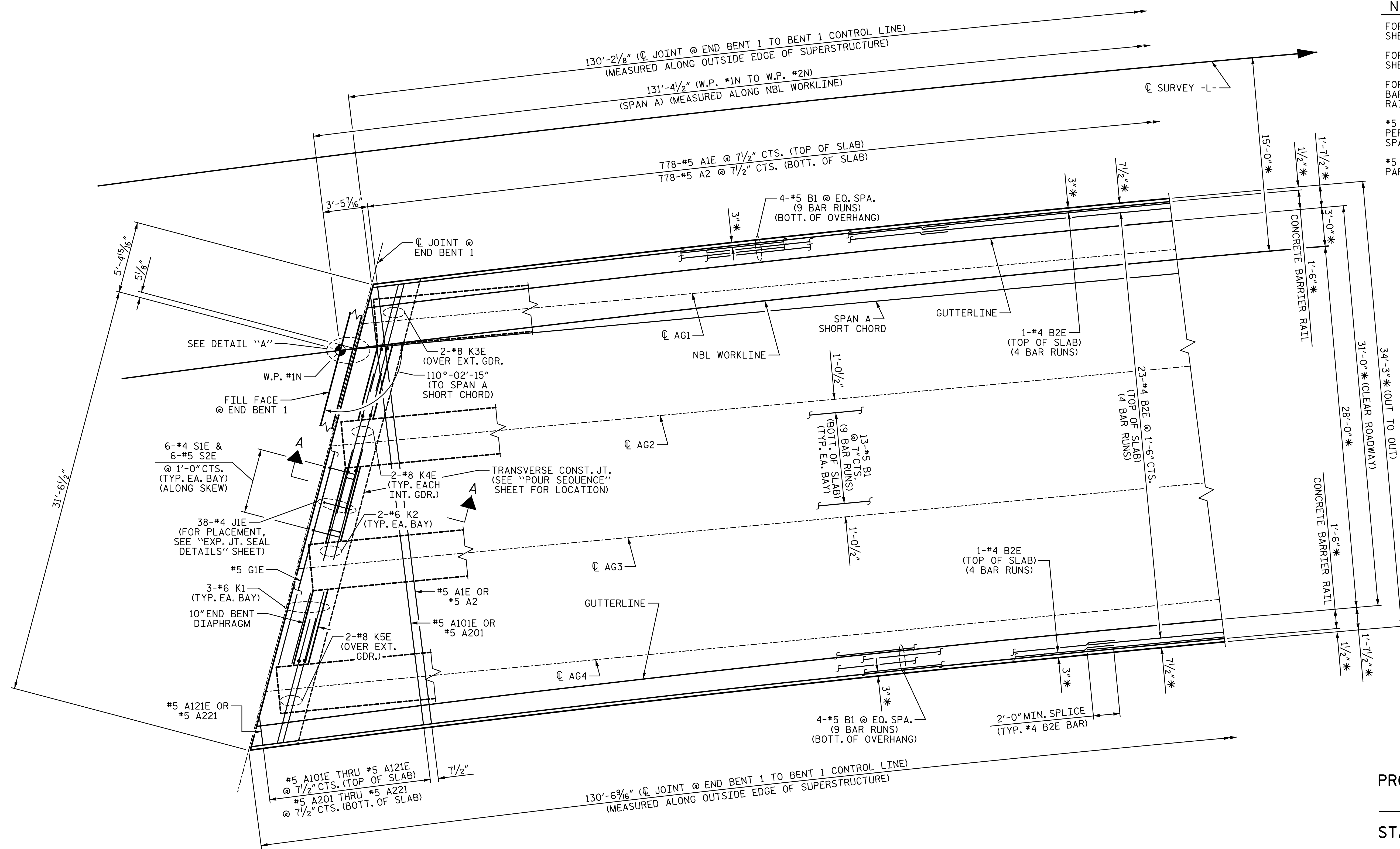

**PART PLAN - SPAN A**  
\* RADIAL DIMENSION

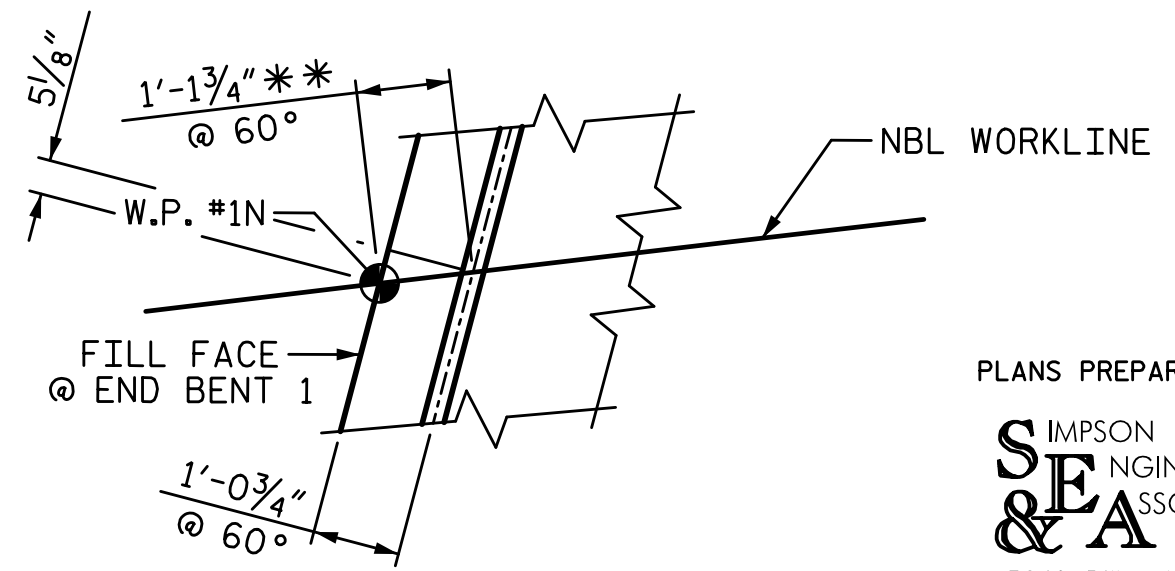

**DETAIL "A"**  
\*\* MEASURED ALONG NBL WORKLINE

**NOTES:**  
FOR SECTION A-A, SEE "TYPICAL SECTION" SHEET 3 OF 3.  
FOR SECTION B-B, SEE "TYPICAL SECTION" SHEET 3 OF 3.  
FOR REINFORCING STEEL AND DETAILS FOR BARRIER RAIL, SEE "CONCRETE BARRIER RAIL DETAILS" SHEET.  
#5 MAIN "A" BARS ARE TO BE PLACED PERPENDICULAR TO NBL WORKLINE AND SPACED ALONG NBL WORKLINE.  
#5 CUT "A" BARS ARE TO BE PLACED PARALLEL TO THE FIRST #5 MAIN "A" BAR.

PROJECT NO. U-3109A  
ALAMANCE COUNTY  
STATION: 146+61.35 -L-

SHEET 1 OF 5

STATE OF NORTH CAROLINA  
DEPARTMENT OF TRANSPORTATION  
RALEIGH  
SUPERSTRUCTURE

PLAN OF SPANS  
(NBL)

REVISIONS						SHEET NO.
NO.	BY:	DATE:	NO.	BY:	DATE:	TOTAL SHEETS
1			3			S03-11
2			4			S03-53

DRAWN BY: T. BANKOVICH DATE: 9-15  
CHECKED BY: J.A. BATTS DATE: 9-15  
DESIGN ENGINEER OF RECORD: J.A. BATTS DATE: 9-15

PLANS PREPARED BY:  
**SIMPSON ENGINEERS & ASSOCIATES**  
5640 Dillard Drive  
Suite 200  
Cary, NC 27518  
(919) 852-0468  
(919) 852-0598 (Fax)  
www.simpsonengr.com  
LICENSURE NO. C-2521

