

INSTALL REMAINING SECTION OF PROPOSED 42" RCP. REMOVE OR PLUG THE EXISTING AND TEMPORARY 36" RCP'S UNDER PROPOSED -Y7A- AS DIRECTED BY THE ENGINEER

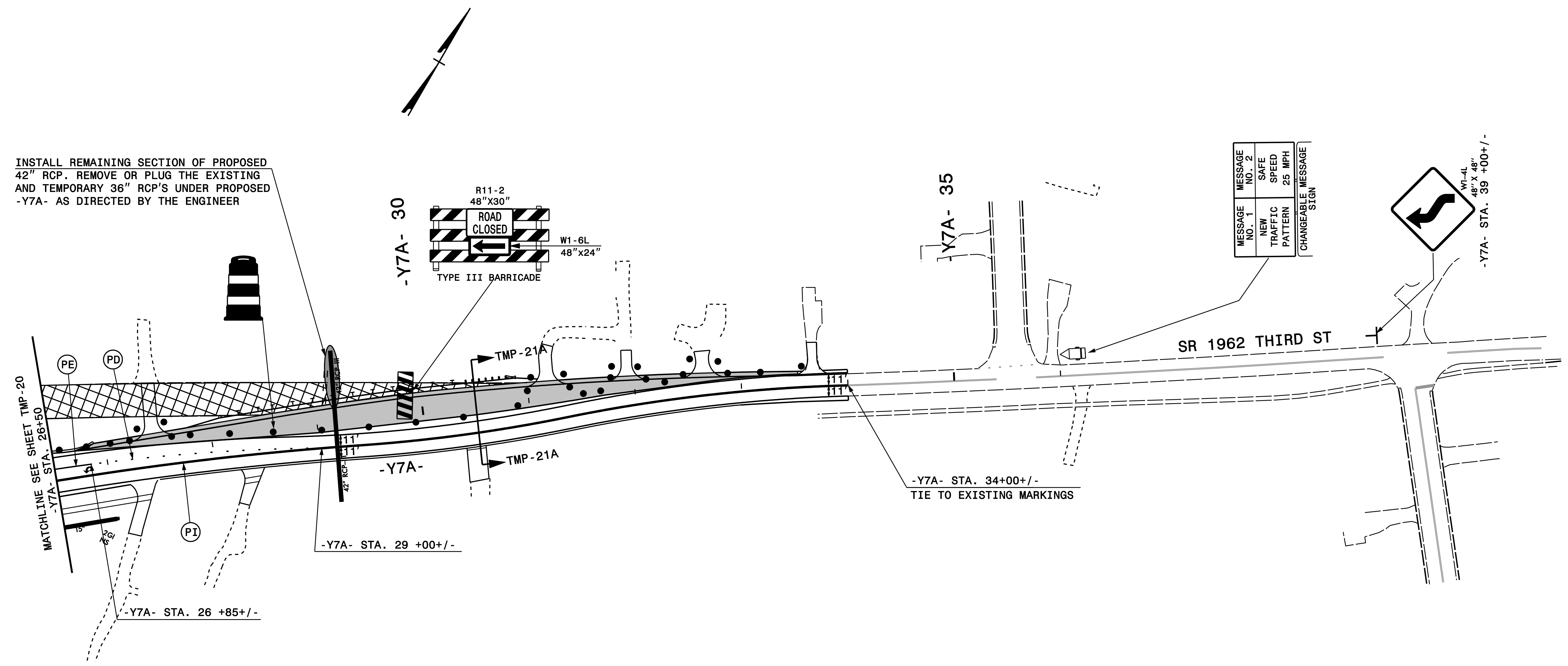

NOTES:
 ALL PAVEMENT MARKINGS ARE EXISTING MARKINGS UNLESS OTHERWISE NOTED.
 SEE SHEET TMPXSC-IB-1 FOR PHASE IB CROSS SECTIONS.

PROGRESSIVE
 DESIGN GROUP, INC.
 ENGINEERS • CONSULTANTS

APPROVED: *[Signature]* DATE: 3/9/2017

SEAL

NORTH CAROLINA
 PROFESSIONAL
 ENGINEER
 SEAL
 025465

DIVISION OF HIGHWAYS
 STATE OF NORTH CAROLINA
 DEPARTMENT OF TRANSPORTATION

**TRANSPORTATION
 MANAGEMENT PLAN
 PHASE IB DETAILS**