

EXTEND PROPOSED 15" RCP WITH TEMPORARY 15" RCP. GRADE TEMPORARY OPEN CHANNEL TO DRAIN TO THE EXISTING DROP INLET LEFT OF STA. 25+75+/- -Y7A-. DO NOT INSTALL THE PROPOSED CATCH BASIN AT STA. 20+75+/- -Y7A- OR THE PROPOSED CURB AND GUTTER ALONG LEFT SIDE OF -Y7A- FROM 25+75+/- -Y7A- FORWARD UNTIL LATER PHASE

TEMPORARY 15" RCP EXTENSION
TEMPORARY OPEN CHANNEL
-Y7A- STA. 21+60+/-

EXTEND PROPOSED 15" RCP WITH TEMPORARY 15" RCP ON BOTH ENDS. GRADE TEMPORARY OPEN CHANNEL TO DRAIN TO THE EXISTING DROP INLET LEFT OF STA. 25+50+/- -Y7A-.

TEMPORARY OPEN CHANNEL
-Y7A- STA. 23+50+/-

CONSTRUCT A TEMPORARY OPEN CHANNEL FROM THE 15" RCP TO THE EXISTING DROP INLET AS SHOWN

-Y7A- STA. 25+50+/-
INSTALL A TEMPORARY 15" RCP INLET PIPE INTO THE PROPOSED CATCH BASIN.
-Y7A- STA. 28+10+/-
TIE TO EXISTING MARKINGS

INSTALL PROPOSED 42" RCP TO THE CENTERLINE OF EXISTING -Y7A- EASTBOUND TRAVEL LANE

-Y7A- STA. 30+60+/-
TIE TO EXISTING MARKINGS
-Y7A- STA. 34+00+/-

-Y7A- STA. 33+00+/-
END TEMPORARY PAVEMENT WIDENING

TEMPORARY 15" RCP EXTENSION
INSTALL THE PROPOSED 15" RCP TO THE LOCATIONS SHOWN

-Y7A- STA. 27+50+/-
BEGIN TEMPORARY PAVEMENT WIDENING WIDEN THE RIGHT SIDE OF PROPOSED -Y7A- WITH TEMPORARY PAVEMENT AT THE SAME ELEVATION AND THE SAME CROSS SLOPE AS PROPOSED -Y7A-.

WEDGE IN THE SUPER ELEVATION FOR THE PROPOSED -Y7ADET- ALIGNMENT. REPLACE THE EXISTING PAVEMENT MARKINGS WITH TEMPORARY PAINT PAVEMENT MARKINGS BY THE END OF EACH CONSTRUCTION PERIOD

EXTEND EXISTING 36" RCP WITH TEMPORARY 36" RCP

INSTALL A SHORT SECTION OF THE PROPOSED 15" RCP FROM THE PROPOSED DROP INLET AND TEMPORARILY PLUG.

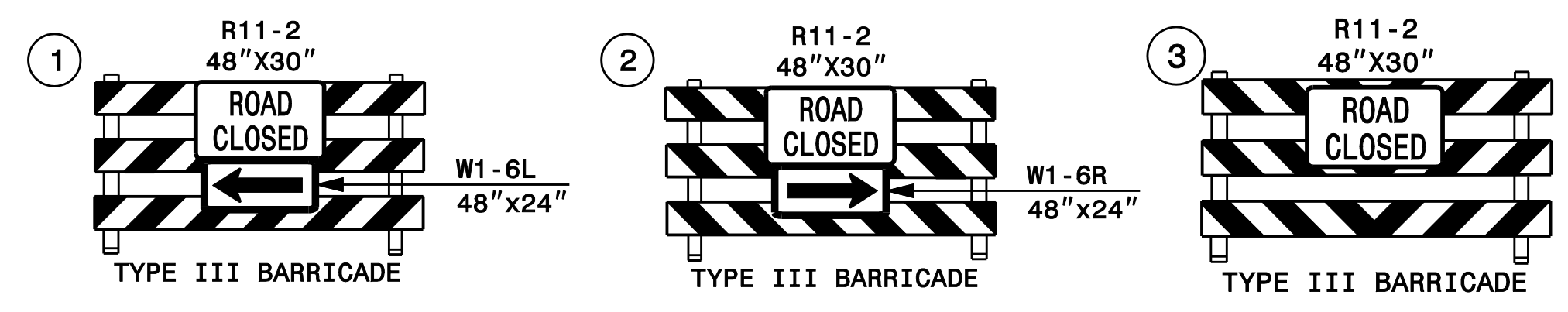

NOTES:
ALL PAVEMENT MARKINGS ARE EXISTING MARKINGS UNLESS OTHERWISE NOTED.
SEE SHEETS TMPXSC-I-5 FOR PHASE I CROSS SECTIONS.

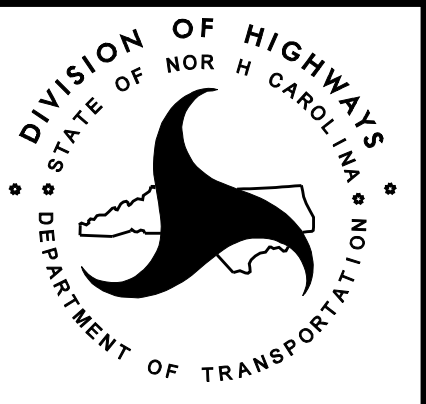
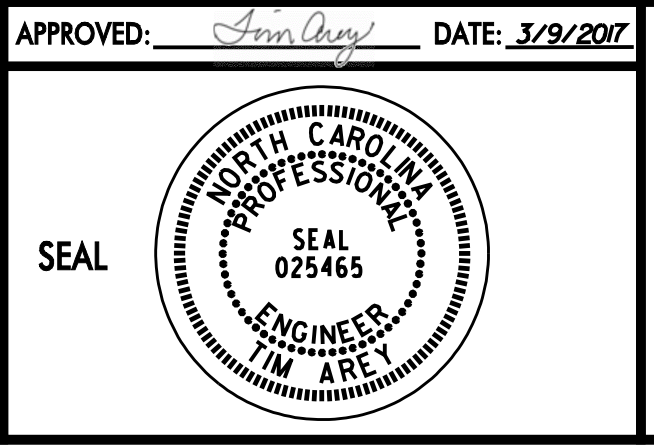

TRANSPORTATION MANAGEMENT PLAN
PHASE I DETAILS