

PROJ. REFERENCE NO.	SHEET NO.
W-5520	TMP-18

NOTE:

1. TEMPORARY PAVEMENT MARKINGS ARE USED IN THIS PHASE.
2. TRAFFIC OPERATES IN TEMPORARY TRAFFIC PATTERN UNLESS OTHERWISE SHOWN.
3. REFER TO RSD 1101.02 FOR ADVANCE WARNING SIGN SPACING.
4. CONTRACTOR SHALL COORDINATE WITH DIVISION TRAFFIC ENGINEER TO COORDINATE TEMPORARY SIGNAL TIMINGS PRIOR TO TEMPORARY TRAFFIC PATTERN.

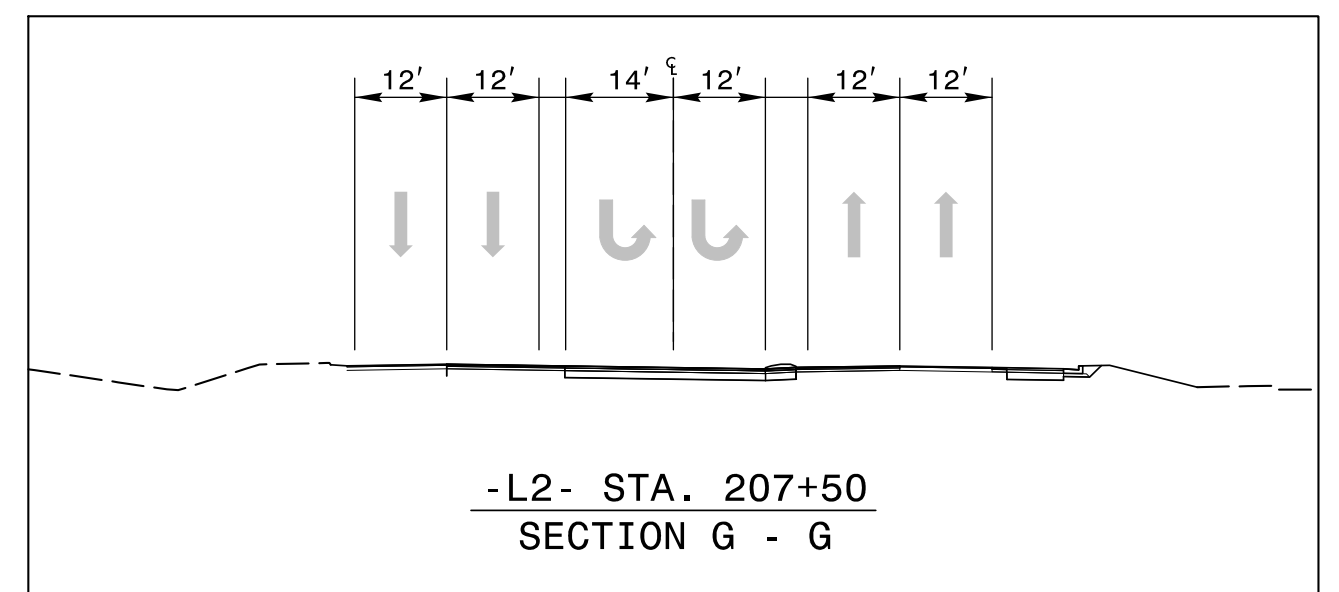
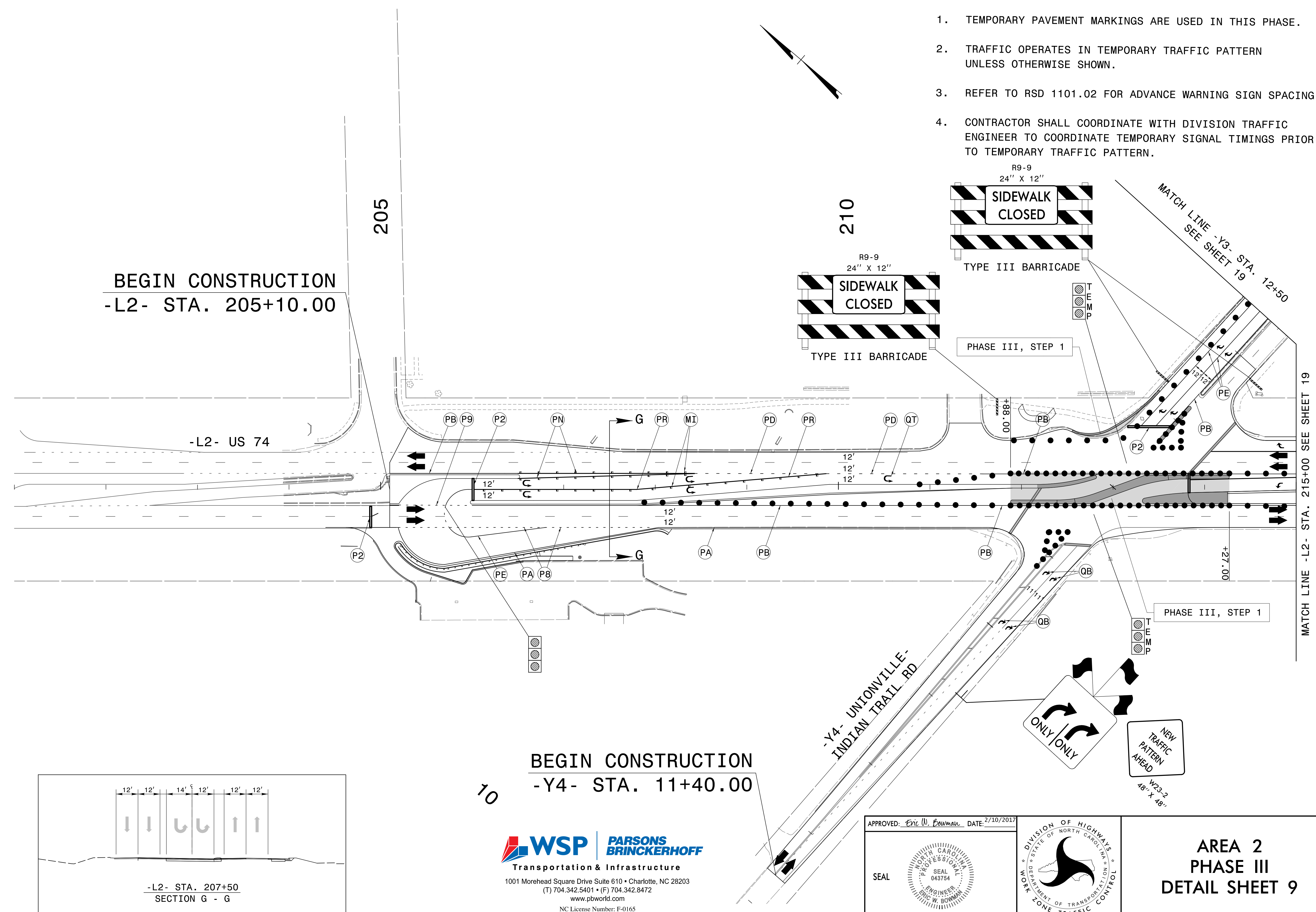

10  
 BEGIN CONSTRUCTION  
 -Y4- STA. 11+40.00

**WSP** | **PARSONS BRINCKERHOFF**  
 Transportation & Infrastructure  
 1001 Morehead Square Drive Suite 610 • Charlotte, NC 28203  
 (T) 704.342.5401 • (F) 704.342.8472  
 www.pbworld.com  
 NC License Number: F-0165

APPROVED: *Eric W. Bowman* DATE: 2/10/2017  
 SEAL

DIVISION OF HIGHWAYS  
 STATE OF NORTH CAROLINA  
 DEPARTMENT OF TRANSPORTATION  
 WORK ZONE TRAFFIC CONTROL

AREA 2  
 PHASE III  
 DETAIL SHEET 9

2/10/2017 US74\TrafficControl\TCP\W5520\_TC\_TMP\_Area 2-Phase3-ldgn  
 USW-5520  
 USEB0442