

6/2/2017

PROJECT REFERENCE NO. W-5520	SHEET NO. 2A-2
ROADWAY DESIGN ENGINEER SEAL JAMES E. BECK 2/2/2017	PAVEMENT DESIGN ENGINEER SEAL CLARK S. MORRISON 2/10/2017

DOCUMENT NOT CONSIDERED FINAL  
UNLESS ALL SIGNATURES COMPLETED

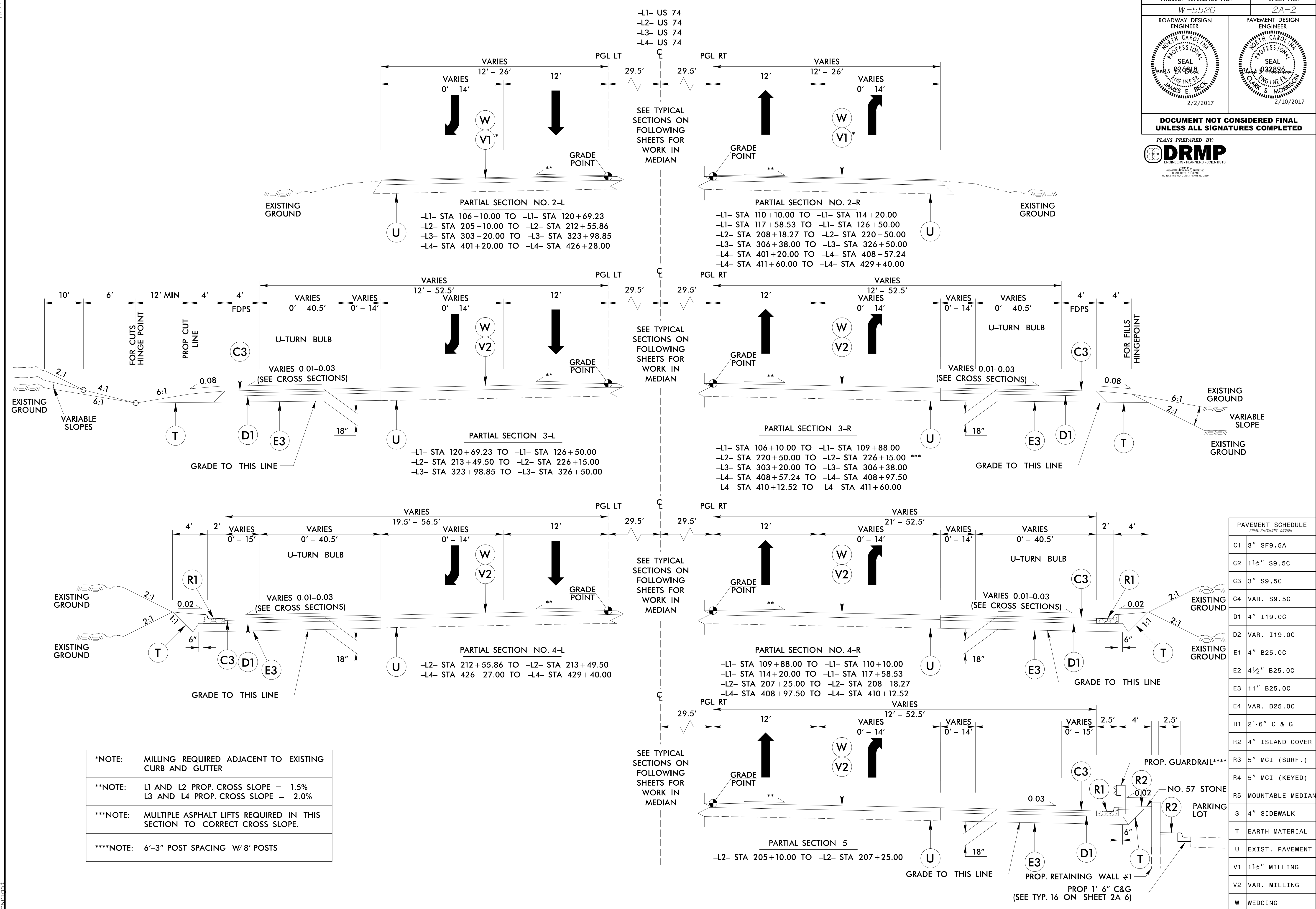

- \*NOTE: MILLING REQUIRED ADJACENT TO EXISTING CURB AND GUTTER
- \*\*NOTE: L1 AND L2 PROP. CROSS SLOPE = 1.5%  
L3 AND L4 PROP. CROSS SLOPE = 2.0%
- \*\*\*NOTE: MULTIPLE ASPHALT LIFTS REQUIRED IN THIS SECTION TO CORRECT CROSS SLOPE.
- \*\*\*\*NOTE: 6'-3" POST SPACING W/ 8' POSTS

PAVEMENT SCHEDULE	
FINAL PAVEMENT DESIGN	
C1	3" SF9.5A
C2	1 1/2" S9.5C
C3	3" S9.5C
C4	VAR. S9.5C
D1	4" I19.0C
D2	VAR. I19.0C
E1	4" B25.0C
E2	4 1/2" B25.0C
E3	11" B25.0C
E4	VAR. B25.0C
R1	2'-6" C & G
R2	4" ISLAND COVER
R3	5" MCI (SURF.)
R4	5" MCI (KEYED)
R5	MOUNTABLE MEDIAN
S	4" SIDEWALK
T	EARTH MATERIAL
U	EXIST. PAVEMENT
V1	1 1/2" MILLING
V2	VAR. MILLING
W	WEDGING

12/9/2016 9:34:18 AM  
 N:\Projects\2016\W5520\_Rdy\_typ.dgn  
 Project