

PROJECT REFERENCE NO.	SHEET NO.
R-3100B	EC-30/CONSTJ6
RW SHEET NO.	
ROADWAY DESIGN ENGINEER	HYDRAULICS ENGINEER

-L-  
 PI Sta 165+32.27  
 $\Delta = 21'06''08.2''$  (LT)  
 $D = 0'52''53.3''$   
 $L = 2,393.98'$   
 $T = 1,210.71'$   
 $R = 6,500.00'$   
 $e = RC$   
 Runoff = 72'

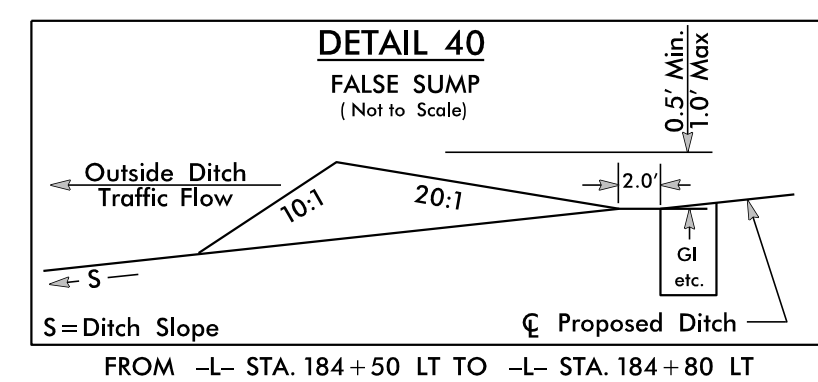
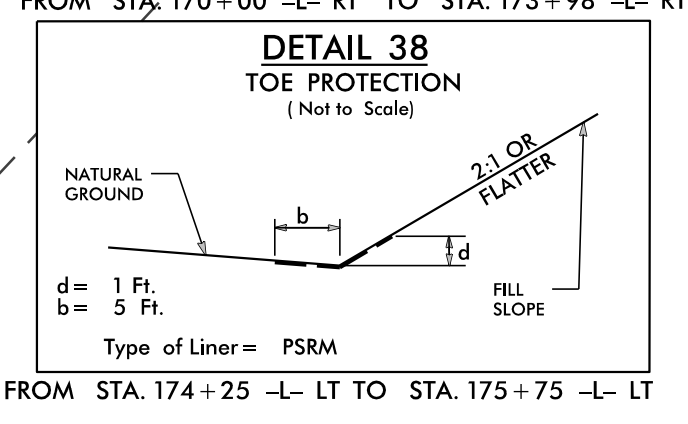
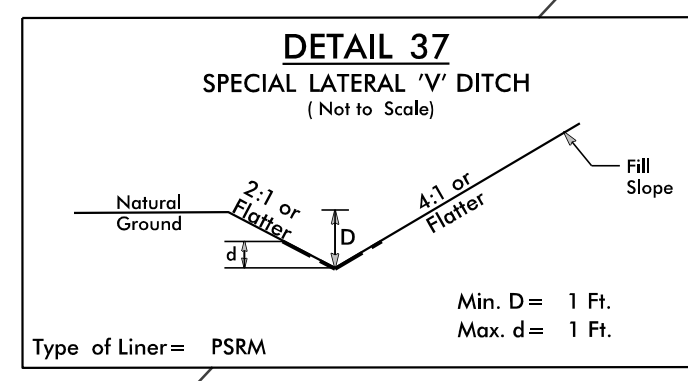
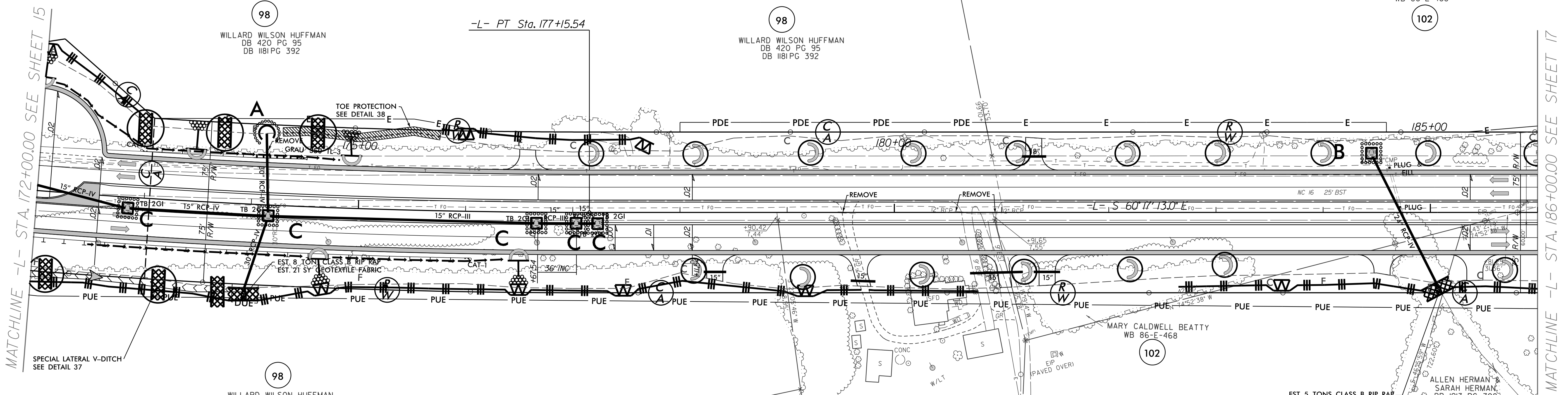
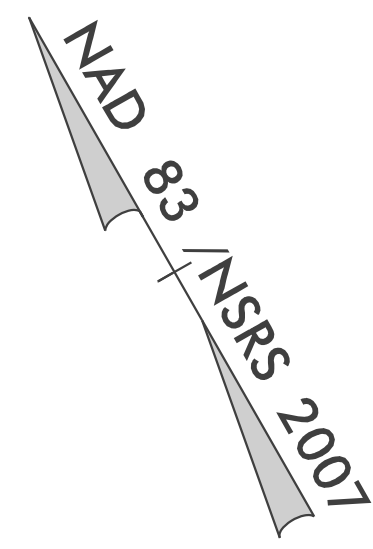

**INSTALL MATTING FOR EROSION CONTROL IN THE PROPOSED DITCH LINE.**

**Place Matting for Erosion Control on Slope as Work Allows.**  
 Sta. 172+50 to Sta. 174+00 -L- LT  
 Sta. 172+50 to Sta. 176+50 -L- RT

FOR -L- PROFILE SEE SHEET 24