

PROJECT REFERENCE NO.	SHEET NO.
R-3100B	EC-19/CONST.05
RW SHEET NO.	
ROADWAY DESIGN ENGINEER	HYDRAULICS ENGINEER

-L-  
 PI Sta 22+04.68  
 $\Delta = 32' 22" 12.2" (LT)$   
 $D = 2' 4" 0.1"$   
 $L = 1,206.20'$   
 $T = 619.67'$   
 $R = 2,135.00'$   
 $e = 3\%$   
 Runoff = 108'

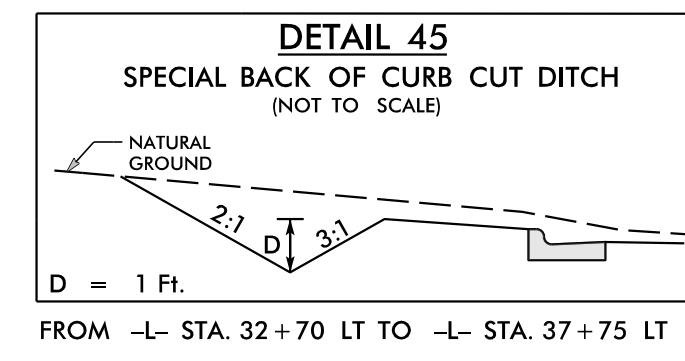

MAD 83 / NSRS 2007

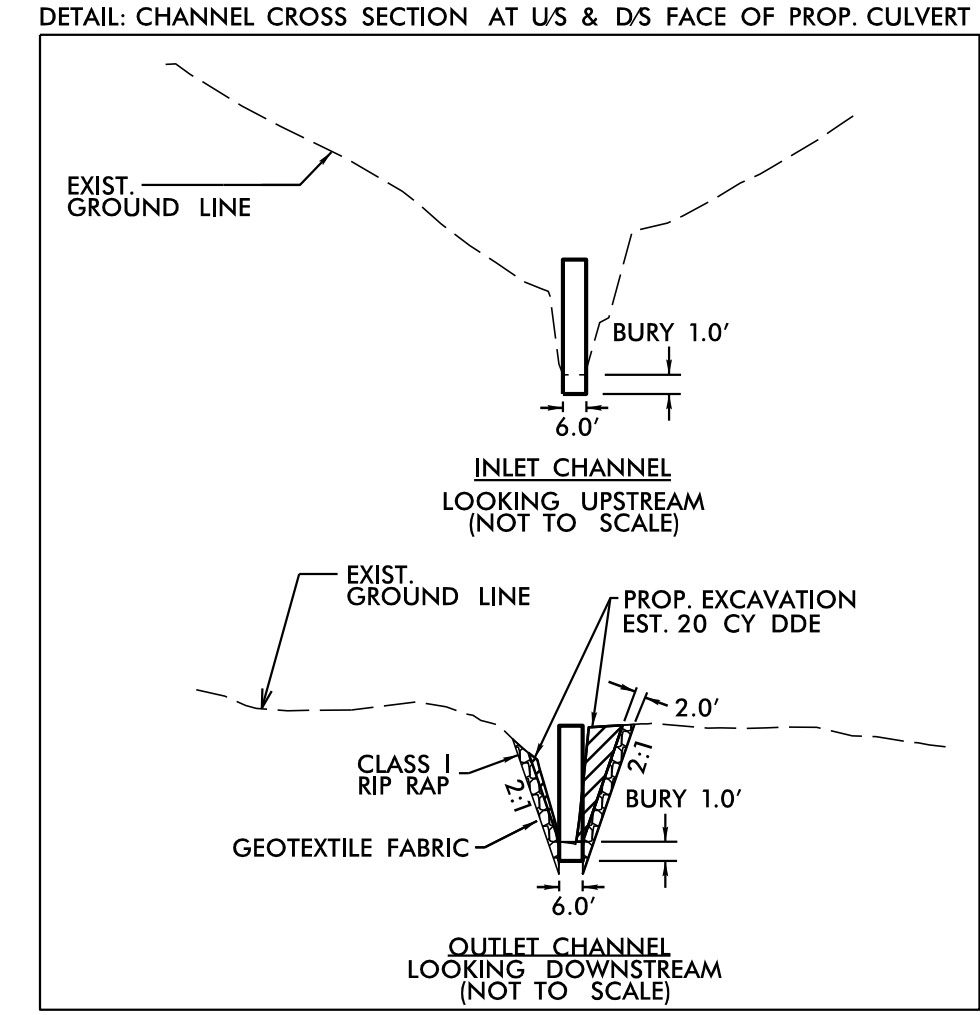
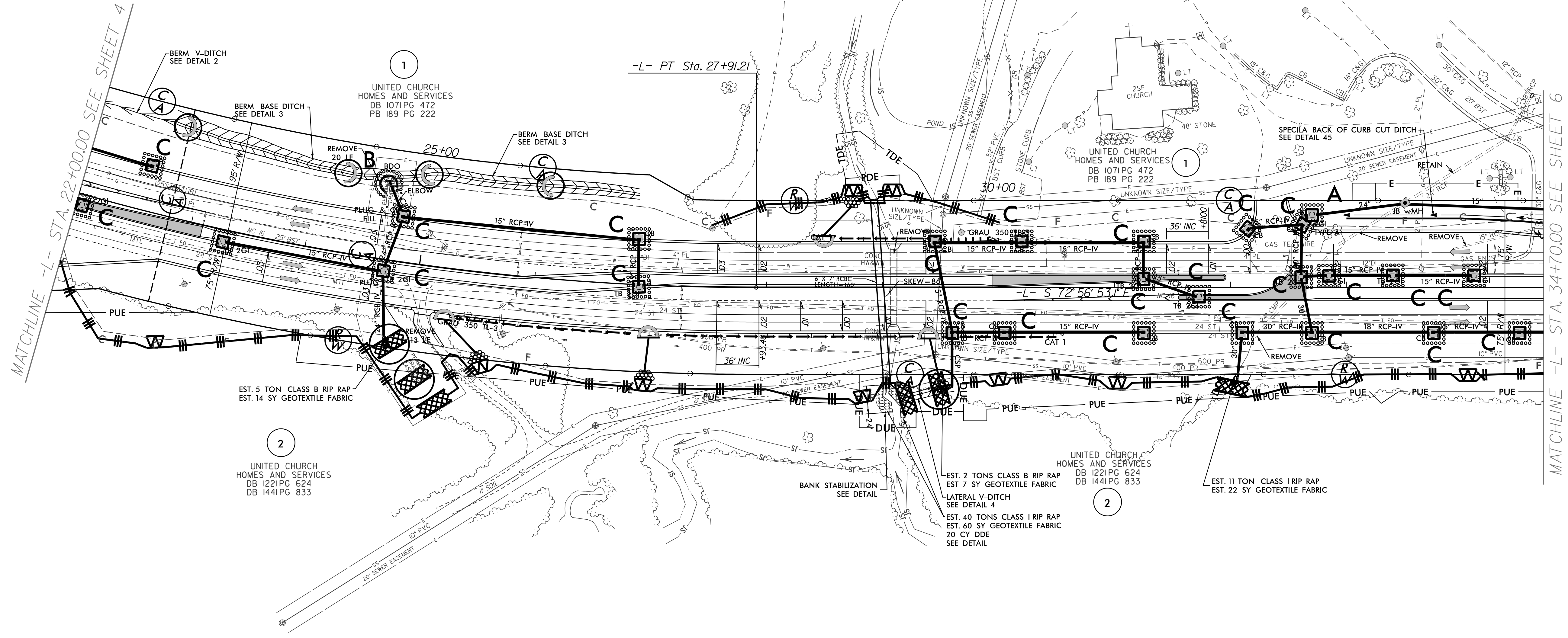

INSTALL MATTING FOR EROSION CONTROL IN THE PROPOSED DITCH LINE.

Place Matting for Erosion Control on Slope as Work Allows.  
 Sta. 25+00 to Sta. 30+50 -L- RT  
 Sta. 28+50 to Sta. 29+50 -L- LT

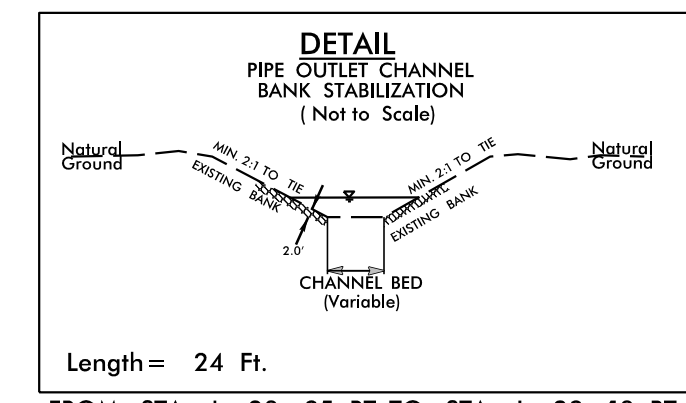
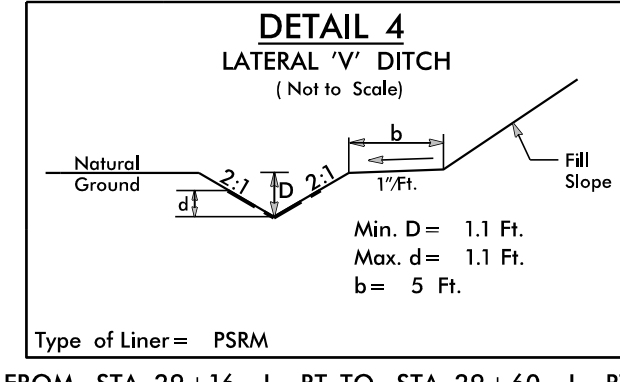
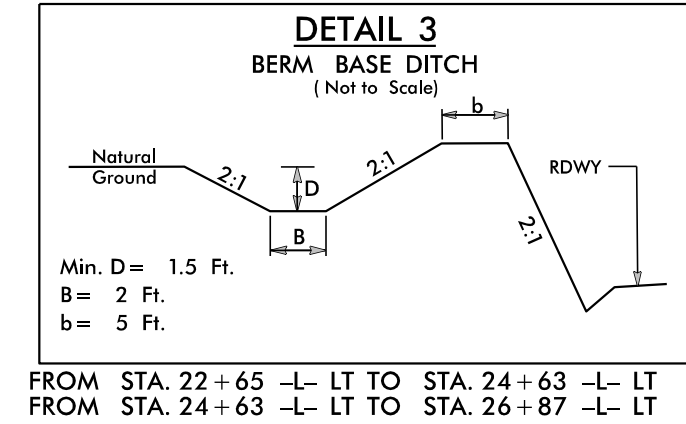

FOR -L- PROFILE SEE SHEET 18

DATE: 06/09/2016 ADDED TCE ONTO PACEL FOR SLOPE CONSTRUCTION STA 33+25 TO STA 34+48

MATCHLINE -L- STA. 22+00.00 SEE SHEET 4

MATCHLINE -L- STA. 34+70.00 SEE SHEET 6