

PROJECT REFERENCE NO.	SHEET NO.
R-3100B	EC-07A/CONST.07
RW SHEET NO.	
ROADWAY DESIGN ENGINEER	HYDRAULICS ENGINEER

UNNAMED TRIBUTARY TO SMYRE CREEK

60" CSP CONSTRUCTION SEQUENCE STA. 12+05 -Y4-

PHASE I

- 1.) INSTALL SPECIAL STILLING BASIN(S).
- 2.) INSTALL UPSTREAM PUMP AND TEMPORARY FLEXIBLE HOSE.
- 3.) PLACE IMPERVIOUS DIKE (1) AND BEGIN PUMPING OPERATIONS FOR STREAM DIVERSION.
- 4.) PLACE IMPERVIOUS DIKE (2) AND PUMPING APPARATUS. DEWATER CONSTRUCTION AREA UTILIZING SPECIAL STILLING BASIN(S).
- 5.) REMOVE EXISTING 48" CMP.
- 6.) INSTALL 60" CSP AND BANK STABILIZATION IN ACCORDANCE WITH THE PLANS.
- 7.) EXCAVATE ANY ACCUMULATED SILT AND DEWATER BEFORE REMOVAL OF IMPERVIOUS DIKES.
- 8.) REMOVE SPECIAL STILLING BASIN(S), IMPERVIOUS DIKES, PUMPS AND TEMPORARY FLEXIBLE HOSE.

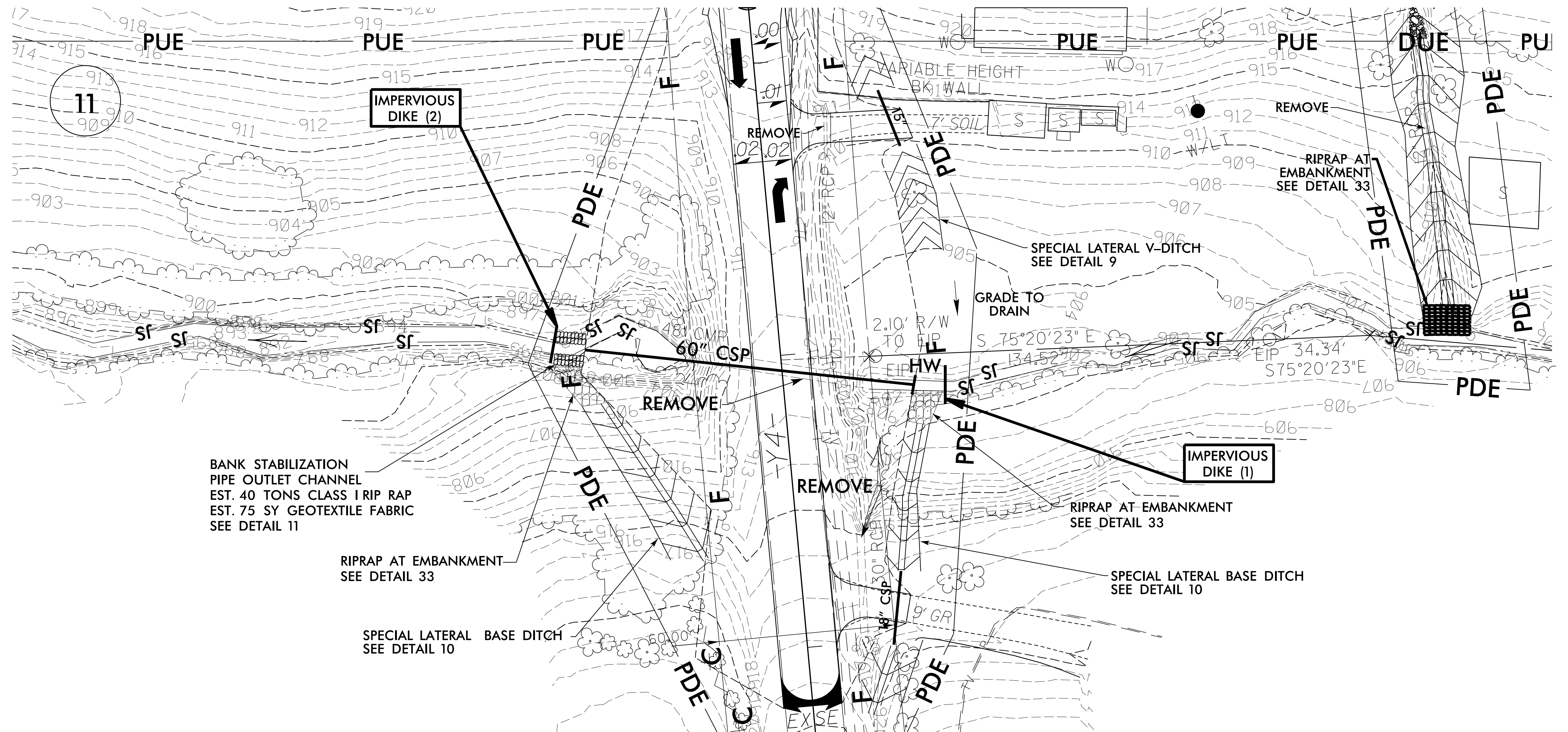

BANK STABILIZATION
PIPE OUTLET CHANNEL
EST. 40 TONS CLASS I RIP RAP
EST. 75 SY GEOTEXTILE FABRIC
SEE DETAIL 11

RIPRAP AT EMBANKMENT
SEE DETAIL 33

SPECIAL LATERAL BASE DITCH
SEE DETAIL 10

RIPRAP AT EMBANKMENT
SEE DETAIL 33

SPECIAL LATERAL BASE DITCH
SEE DETAIL 10

