

TIP PROJECT: R-3100B

See Sheet 1-A For Index of Sheets
See Sheet 1-B For Conventional Symbols

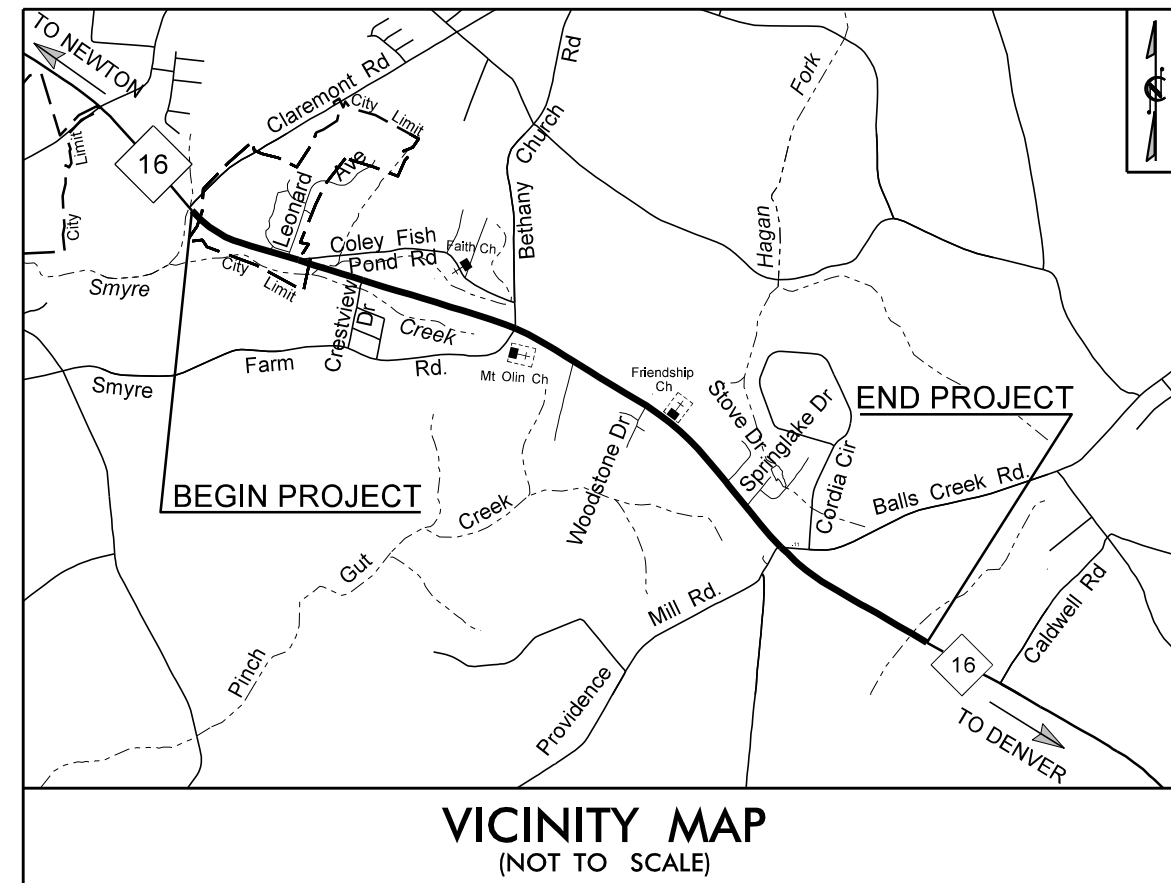

STATE OF NORTH CAROLINA
DIVISION OF HIGHWAYS

PLAN FOR PROPOSED
HIGHWAY EROSION CONTROL

CATAWBA COUNTY

**LOCATION: NC 16 NORTH OF SR 1801 (CLAREMONT RD) AND
NORTH OF SR 1814 (CALDWELL RD)**

**TYPE OF WORK: GRADING, DRAINAGE, RETAINING WALL,
CULVERTS, PAVING & SIGNALS**

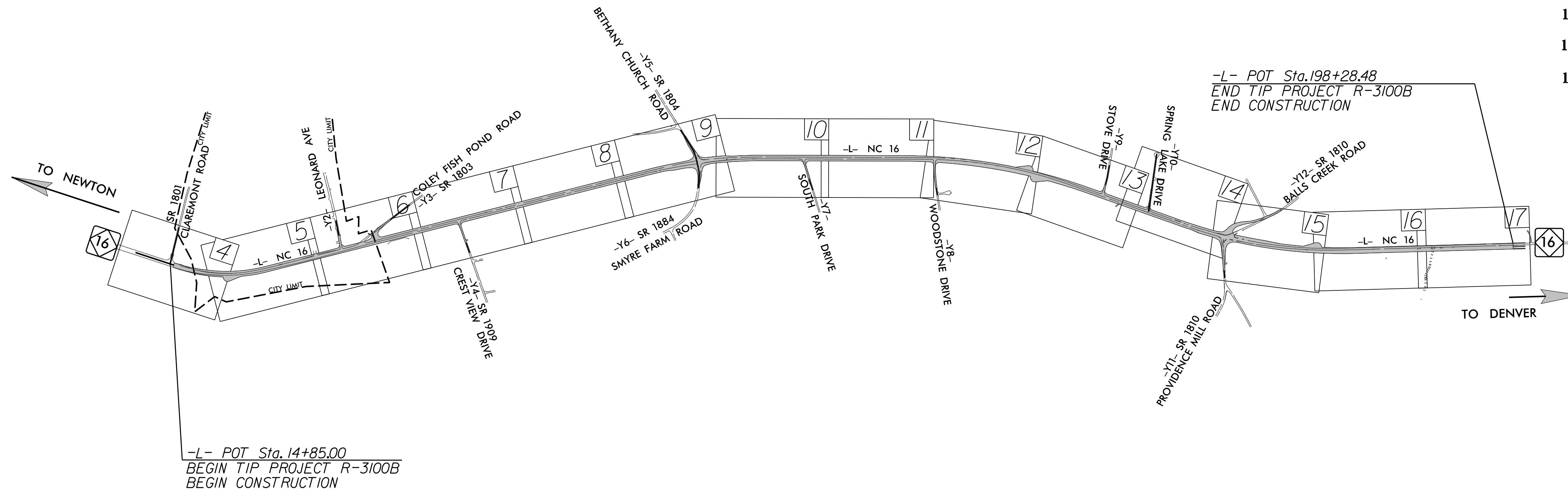

THIS PROJECT IS PARTIAL CONTROL-ACCESS, WITH ACCESS BEING LIMITED TO POINTS AS SHOWN ON PLANS.

STATE	STATE PROJECT REFERENCE NO.	SHEET NO.	TOTAL SHEETS
N.C.	R-3100B	EC-1	
STATE PROJ. NO.	F.A. PROJ. NO.	DESCRIPTION	
34522.1.4	STP-16(4)	PE	
34522.2.FR4	STP-0016(53)	ROW	
34522.2.FRU4	STP-0016(53)	UTIL.	

EROSION AND SEDIMENT CONTROL MEASURES

Std. #	Description	Symbol
1630.03	Temporary Silt Ditch	TD
1630.05	Temporary Diversion	TD
1605.01	Temporary Silt Fence	III III III
1606.01	Special Sediment Control Fence	III III III
1622.01	Temporary Berms and Slope Drains	III III III
1630.02	Silt Basin Type B	III III III
1633.01	Temporary Rock Silt Check Type-A	III III III
	Temporary Rock Silt Check Type-A with Matting and Polyacrylamide (PAM)	III III III
1633.02	Temporary Rock Silt Check Type-B	III III III
	Wattle/Coir Fiber Wattle	III III III
	Wattle/Coir Fiber Wattle with Polyacrylamide (PAM)	III III III
1634.01	Temporary Rock Sediment Dam Type-A	III III III
1634.02	Temporary Rock Sediment Dam Type-B	III III III
1635.01	Rock Pipe Inlet Sediment Trap Type-A	III III III
1635.02	Rock Pipe Inlet Sediment Trap Type-B	III III III
1630.04	Stilling Basin	III III III
1630.06	Special Stilling Basin	III III III
	Rock Inlet Sediment Trap:	
1632.01	Type A	A
1632.02	Type B	B
1632.03	Type C	C
	Skimmer Basin	III III III
	Tiered Skimmer Basin	III III III
	Infiltration Basin	III III III

**THIS PROJECT CONTAINS
EROSION CONTROL PLANS
FOR CLEARING AND
GRUBBING PHASE OF
CONSTRUCTION.**

**ENVIRONMENTALLY
SENSITIVE AREA(S) EXIST
ON THIS PROJECT**

*Refer To E. C. Special Provisions
for Special Considerations.*

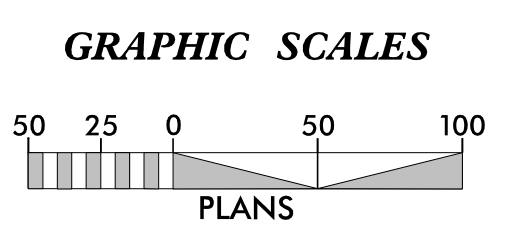

THESE EROSION AND SEDIMENT CONTROL PLANS COMPLY WITH THE REGULATIONS SET FORTH BY THE NCG-010000 GENERAL CONSTRUCTION PERMIT EFFECTIVE AUGUST 3, 2011 ISSUED BY THE NORTH CAROLINA DEPARTMENT OF ENVIRONMENT AND NATURAL RESOURCES DIVISION OF WATER QUALITY.

SUNGATE DESIGN GROUP, P.A.

915 JONES FRANKLIN ROAD
RALEIGH, NORTH CAROLINA 27606
TEL (919) 859-2243 FAX (919) 859-6258
ENG FIRM LICENSE NO. C-890

Designed by:

Brian N. Elam, PE 3195
NAME LEVEL III CERTIFICATION NO.

Prepared in the Office of:

ROADSIDE ENVIRONMENTAL UNIT

1 South Wilmington St.
Raleigh, NC 27611

2012 STANDARD SPECIFICATIONS

Reviewed by:

Jeremy Goodwin, PE, CPESC, CPSWQ 3446
NAME LEVEL III CERTIFICATION NO.

Roadway Standard Drawings

The following roadway english standards as appear in "Roadway Standard Drawings"- Roadway Design Unit - N. C. Department of Transportation - Raleigh, N. C., dated January 2012 and the latest revision thereto are applicable to this project and by reference hereby are considered a part of these plans.

1604.01 Railroad Erosion Control Detail	1632.01 Rock Inlet Sediment Trap Type A
1605.01 Temporary Silt Fence	1632.02 Rock Inlet Sediment Trap Type B
1606.01 Special Sediment Control Fence	1632.03 Rock Inlet Sediment Trap Type C
1607.01 Gravel Construction Entrance	1633.01 Temporary Rock Silt Check Type A
1622.01 Temporary Berms and Slope Drains	1633.02 Temporary Rock Silt Check Type B
1630.01 Riser Basin	1634.01 Temporary Rock Sediment Dam Type A
1630.02 Silt Basin Type B	1634.02 Temporary Rock Sediment Dam Type B
1630.03 Temporary Silt Ditch	1635.01 Rock Pipe Inlet Sediment Trap Type A
1630.04 Stilling Basin	1635.02 Rock Pipe Inlet Sediment Trap Type B
1630.05 Temporary Diversion	1640.01 Coir Fiber Baffle
1630.06 Special Stilling Basin	1645.01 Temporary Stream Crossing
1631.01 Matting Installation	

9/23/2010 EC-den_esh_01.dgn